



# Instruction Manual

egg®



## Instruction Manual.

**IMPORTANT:** Please keep for future reference.

| Contents                                 | Page |
|------------------------------------------|------|
| Contents/parts check list.               | 2-3  |
| Important safety information.            | 4    |
| Product information.                     | 5    |
| <b>Section 1 - Chassis</b>               |      |
| Fitting/removing the front wheels.       | 6    |
| Fitting/removing the rear wheels.        | 6    |
| Opening the chassis.                     | 6    |
| Operating the parking brake.             | 6    |
| Operating the front swivel wheel.        | 7    |
| Adjusting the handle height.             | 8    |
| Folding the chassis.                     | 8    |
| <b>Section 2 - Seat Unit</b>             |      |
| Fitting the seat unit to the chassis.    | 10   |
| Fitting/removing the bumper bar.         | 11   |
| Adjusting the seat unit.                 | 11   |
| Adjusting the calf support.              | 12   |
| Fitting/removing the seat unit hood.     | 12   |
| Fitting the seat unit apron.             | 12   |
| Using the 5 point safety harness.        | 13   |
| Removing the seat unit from the chassis. | 13   |
| Fitting the raincover.                   | 14   |
| Fitting the insect net.                  | 14   |
| Fitting the baby nest.                   | 14   |
| Fitting the seat liner.                  | 15   |

**Parts:**  
Chassis  
2 x front wheels  
2 x rear wheels  
Seat Unit  
Apron  
Hood  
Bumper bar  
Raincover  
Insect net



**Parts:**  
Carrycot body  
Mattress  
Liner  
Apron  
Raincover

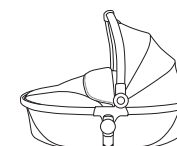

| Contents cont...                                            | Page |
|-------------------------------------------------------------|------|
| <b>Section 3 - Carrycot</b>                                 |      |
| Assembling the carrycot.                                    | 16   |
| Fitting the carrycot apron.                                 | 16   |
| Adjusting the carrycot hood.                                | 16   |
| Attaching/removing the carrycot to the chassis.             | 17   |
| Fitting the carrycot raincover.                             | 17   |
| Fitting the carrycot insect net.                            | 18   |
| <b>Section 4 - Car Seat Adaptors</b>                        |      |
| Fitting the car seat adaptors.                              | 19   |
| Fitting the car seat.                                       | 19   |
| Removing the car seat.                                      | 19   |
| Removing the car seat adaptors.                             | 20   |
| <b>Section 5 - Tandem Mode</b>                              |      |
| Fitting/removing the tandem adaptors.                       | 21   |
| Fitting/removing seat units to the tandem adaptors.         | 22   |
| Fitting/removing carrycots to the tandem adaptors.          | 23   |
| Fitting/removing car seats adaptors to the tandem adaptors. | 24   |
| Fitting/removing car seats to the tandem adaptors.          | 25   |
| Tandem Modes.                                               | 26   |
| Care and maintenance. How to look after your egg stroller.  | 28   |
| Your egg Warranty.                                          | 29   |
| Trouble Shooting.                                           | 30   |

## Important Safety Information.

This vehicle is intended for children from birth to a maximum of 25kg.

Age and weight usage: Pram body/carry cot: 0 to 9kg, car seat 0 to 13kg (follow manufacturers guidelines), seat unit (used as a single stroller) newborn to 25kg, Tandem seat units in upper or lower position 15kg max per seat unit.

Each seat unit carry cot or car seat is suitable for one child only to the maximum weight stated above. Maximum occupancy as single vehicle one child, maximum occupancy as tandem vehicle two children.



### TO AVOID INJURY OR DEATH

**FOLLOW THE MANUFACTURERS INSTRUCTIONS.**

**PUT ON ALL BRAKES WHENEVER YOU PARK THE PRAM/STROLLER**

**DO NOT LEAVE CHILDREN UNATTENDED.**

**SECURE THE CHILD IN THE HARNESS AT ALL TIMES.**

**DO NOT CARRY EXTRA CHILDREN OR BAGS ON THIS PRAM/STROLLER.**

**MAKE SURE CHILDREN ARE CLEAR OF ANY MOVING PARTS IF YOU ADJUST THE PRAM/STROLLER OTHERWISE THEY MAY BE INJURED.**

**THE SEAT UNIT IS SUITABLE FOR NEWBORNS**

A harness can form loops, which may be a strangulation hazard- Never leave a harness connected when not fitted to a child in the stroller. Ensure that all locking devices are engaged before use.

Do not let your child play with this product.

Check the bassinet or seat unit or car seat attachment devices are correctly engaged before use.

It is unsafe to use accessories other than those approved by the manufacturer. The maximum weight for the shopping basket is- 2kg.

Do not use the vehicle on steps, stairs or escalators; as it may be dangerous to your child/ children.

Ensure the travel lock is engaged before lifting the chassis with the carry strap.

Only use the Egg seat units, carrycots, accessories and car seats recommended by Egg.

Only use the Egg tandem in the configurations described and illustrated on page 27.

## Product Information.

The egg stroller has been designed in the UK with safety and style in mind. Soft touch fabrics create smooth curves and continuous lines to give the egg® a luxury, stylish look. Outstanding engineering creates the perfect ride for baby and ultimate ease of use for parents. The egg has been fitted with Tru-Ride technology® tyres which have been engineered for comfort, superior handling and added durability. The one-hand fold chassis is compact and freestanding when folded and the three position recline, parent and forward facing seat unit is spacious and comfortable. A lie flat carrycot can be purchased as an optional extra, is suitable for occasional overnight sleeping and comes complete with padded liner and mattress.

- Carrycot suitable from birth and occasional overnight sleeping with padded liner, mattress and raincover.
- Three position recline, parent and forward facing seat unit. 0 to 15/25kg.
- Complete with apron, insect net, raincover and seat liner.
- One-hand fold, compact chassis.
- Five position handle height adjustment. 94 - 105cms.
- Fixed or swivel front wheels.
- Features PU Polymer Tru-Ride Technology® tyres.
- Quick release wheels.
- All round suspension.
- Car seat adaptors available as optional extra to add a Group 0+ infant carrier car seat.
- Co-ordinating accessories include; parasol, changing bag, seat liner, footmuff and cup holder.
- Option to convert to a tandem stroller with the addition of the tandem adaptor kit.

### Weights and dimensions:

Chassis weight with wheels - 9.7kgs.

Chassis weight with wheels and seat unit - 13.5kg.

Carrycot weight - 3.4kgs.

Stroller with wheels folded- 67 x 29 x 59cms.

egg®

## Section 1 - Chassis

### 1. Fitting/removing the front wheels.

Press the quick release button on the back of the wheel housing on the chassis and push the front wheel onto axle.

The wheels are marked L for left and R for right from the perspective of standing in front of the chassis.

**Important:** Check the wheels are secure by pulling downwards.

To remove; press the quick release button on the back of the wheel housing on the chassis and pull the wheel away from the axle.



### 2. Fitting/removing the rear wheels.

Press the button in the centre of the rear wheel and push onto the rear wheel housing.

**Important:** Check the wheels are secure by pulling outwards.

To remove; press the button in the centre of the rear wheel and pull the wheel away from the wheel housing.



### 3. Opening the chassis.

Ensure the chassis is stood upright

Push the chassis locking clip to release the front section of the chassis. Allow the front of the chassis to move forwards. You may have to pull forward gently to assist this.



Release the stroller handle by pushing the handle lock.

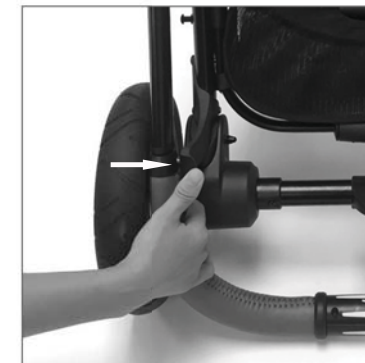

Lift the handle upwards until you hear the lock engage with a click.

**WARNING: Ensure the locking devices are engaged before use.**



### 4. Operating the parking brake.

Press down on the pedal to engage the parking brake

Press down and release to disengage the parking brake.

**WARNING: Never leave the vehicle without first fully engaging the parking brake.**



egg®

egg®

**5. Operating the front swivel wheels.**

Press the button until it clicks to switch between fixed or swivel wheel travel.

**6. Adjusting the handle height.**

Rotate the central section of the handle forward (1) and slide into the desired position (2). **Note:** The handle has 5 height positions.

**7. Folding the chassis.**

**Important:** Remove the seat unit/carrycot/car seat and any adaptors before attempting to fold the chassis and ensure the shopping basket is empty.

**Note:** The chassis will not fold unless the handle is in the lowest position and seats, carrycots adaptors etc have been removed from the chassis.

Engage the parking brake.

Ensure the handle is in its lowest position.

Ensure the front wheels are unlocked and in the swivel position.

Fully rotate the central section of the handle bar towards you, the hub locks will release.



egg®

Lower the handle towards the floor.



Lift the carry handle, found in the centre of the basket to allow the front of the chassis to move towards the rear of the chassis.



Secure the chassis using the travel lock.



egg®

## Section 2 - Seat Unit

### 1. Fitting the seat unit to the chassis.

**Important:** Ensure that both the legs are in the same position before attempting to attach the seat unit to the chassis. Failure to do so may cause damage to the seat unit.

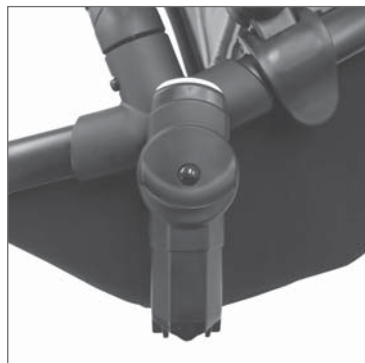

Insert the seat unit legs into the main housings on the chassis until the seat locks in place with a click.

**WARNING:** Ensure the seat unit is locked in place on the chassis before use.

**Note:** The seat unit can be used in forward facing or parent facing modes. Simply attach the seat unit in the same way in your preferred facing mode.



### 2. Fitting the bumper bar.

Slot the bumper bar into the sockets on the seat unit whilst holding down the release button.

**Important:** Ensure the bumper bar is locked in place before use by pulling the bumper bar upwards.



### 3. Removing the bumper bar

Press the small buttons on the seat unit under the bumper bar and pull the bumper bar away from the seat unit.



**Note:** The bumper bar can be released one side at a time to allow easy access for placing your child in or removing your child from the seat unit.



### 4. Adjusting the seat unit.

Lift the adjustment handle on the top side of the seat unit and adjust the seat to the desired position. The seat unit will lock into position when the handle is released.

**Note:** The seat unit has 3 positions.



egg®

egg®

**5. Adjusting the calf support.**

Pull the calf support upwards to raise.

Depress both grey buttons at the side of the footrest to lower into the desired position.

**Note:** The calf support has 4 positions.

**6. Fitting/removing the seat unit hood.**

Attach and fasten the zip; push the plastic clips firmly onto the seat unit frame then close the clips.

To remove; unfasten the clips from the seat unit frame and open the zip.

**7. Fitting the seat unit apron.**

Slide the bottom of the apron over the calf support. Pull upwards into place and fold the apron flap over the bumper bar. Secure using the press studs on the apron flap.

**8. Using the 5 point safety harness.**

Fit together the two connectors on the harness straps and push firmly into the buckle housing until they click together.

**Important:** Ensure they are fully engaged before use.

As your child grows, the height of the shoulder straps can be altered. Reach inside the seat back rest and locate the buckles. Thread through the opening in the seat back and seat cover, adjust to the correct height position and re-thread back through the seat fabric and seat back rest. Ensure the buckles are fitted correctly before use.

Adjust the straps to suit the child using the sliders on the harness.

To release the connectors depress the grey button on the buckle housing, the two connectors will release from the main housing.

**WARNING: To avoid serious injury always use a 5 point safety harness.**

**Important:** Always ensure the parking brake is engaged when placing and removing children from the vehicle.

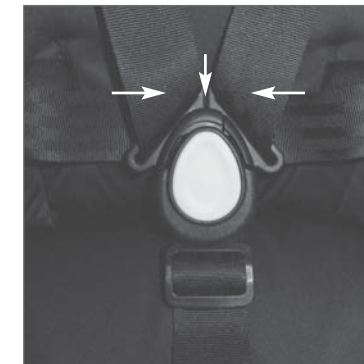
**9. Removing the seat unit from the chassis.**

Depress the grey buttons on the side of the seat unit and lift the seat upwards from the chassis.

**Important:** Always remove your child from the seat unit before removing the seat unit from the chassis.



egg®

egg®

**10. Fitting the raincover.**

Slide the raincover on from the footrest end first ensuring it slides underneath the footrest. Pull up and over the extended stroller hood and secure at the back with the velcro tabs.

**WARNING: Never leave raincovers, hoods, aprons and baby nests on or over the stroller indoors, in a hot atmosphere or near a heat source, your child may overheat.**

**11. Fitting the insect net.**

The insect net is located in a pocket on the underside of the leg support. Remove the insect net (leaving the press stud attached), pull up and over the extended stroller hood.

**12. Fitting the baby nest.**

Remove the comfort pads on the shoulder straps and the crotch strap; unclip the shoulder strap buckles and thread the straps and crotch strap through the corresponding holes in the baby nest. Re-fasten the buckles.



egg®

**13. Fitting the seat liner.**

Place the seat liner in the seat unit with the straps passing through the corresponding holes. Fasten the velcro on the back of the seat liner where the shoulder straps pass through.



egg®

### Section 3 - Carrycot

#### 1. Assembling the carrycot.

Remove the apron and mattress to gain access to the stay bars in the bottom of the carrycot.

Using the tabs, pull the stay bars into the clips on the baseboard until you hear them click into place. Reposition the lining and place the mattress back into the carrycot.

**Important:** Ensure that the stay bars are fully engaged before using the carrycot.



#### 2. Attaching the carrycot apron.

Fasten the zip of the apron to the zip on the carrycot and pull all the way around.



#### 3. Adjusting the carrycot hood.

Depress the buttons on the side of the hood and pull up until you hear it click into place.

Depress the buttons again to put the hood down. The carrycot hood has an intermediate position (45 degrees) to allow viewing when the carrycot is used in the tandem mode, lower position.



#### 4. Fitting the carrycot.

Lower the carrycot onto the chassis parent facing. Insert the carrycot legs into the main housings on the chassis and push down firmly until it clicks and locks onto the chassis.

**WARNING: Ensure the carrycot is locked in place on the chassis before use.**



#### 5. Removing the carrycot.

Depress the buttons on the side of the carrycot and lift upwards from the chassis.



#### 6. Fitting the carrycot raincover.

The carrycot hood must be fully extended to support the Raincover. Place Raincover over the carrycot and secure the side panels (left and right) using the velcro tabs behind the main chassis housings.

**WARNING: Never leave raincovers, hoods, aprons and baby nests on or over the stroller indoors, in a hot atmosphere or near a heat source, your child may overheat.**



egg®

### 7. Fitting the carrycot insect net.

Using the insect net from the seat unit which is located in the pocket on the underside of the leg support, place the insect net over the carrycot with the hood extended and secure at the sides.



**WARNING:** The egg carrycot is suitable for a child who cannot sit unaided, rollover or push itself up on its hands and knees.

**WARNING:** Do not let other children play unattended near the carrycot.

**WARNING:** Do not use if any part is broken, torn or missing.

**WARNING:** Do not add a mattress which is thicker than 30mm.

**Never use the carrycot on a stand.  
Do not leave your child unattended.**

#### Important:

- Only use the carrycot on a horizontal, firm, level and dry surface.
- Inspect the handle and base of the carrycot on a regular basis.
- Be aware of the risk of open fire and other strong heat sources such as electric fires, gas fires etc in the vicinity of the carrycot.
- This carrycot is not a safe means of transport by car and should NEVER be used as such.

egg®

## Section 4 - Car Seat Adaptors

### 1. Fitting the car seat adaptors.

Insert the car seat adaptors onto the left and right sides of the main chassis housings.

The adaptors are marked L for left and R for right from the perspective of standing behind the handle of the chassis. Press down firmly until they click into place.

**WARNING: Ensure the adaptors are engaged before use by pulling them upwards.**



### 2. Fitting the car seat parent facing only.

Align the car seat with the adaptors and press down firmly until the car seat clicks into place.

**WARNING: Ensure the car seat is locked into place by gently pulling the car seat upwards.**



### 3. Removing the car seat.

Depress the buttons on either side of the car seat and lift off the adaptors.



egg®

**4. Removing the car seat adaptors.**

Depress the buttons on the adaptors and lift off the chassis.



The egg has been designed and tested for use with a number of leading brand car seats, for full details please visit [eggstroller.com](http://eggstroller.com) or check with your local retailer.

**WARNING: Do not use any car seat unless specifically recommended by egg.**

For car seats used in conjunction with a chassis, this vehicle does not replace a cot or a bed. Should your child need to sleep, then it should be placed in a suitable pram body, cot or bed.

egg®

**Section 5 - Using the egg in tandem mode.****1. Fitting the tandem adaptors.**

Insert the tandem adaptors onto the left and right sides of the main chassis housings until it locks into place with a click. Ensure the locating hook is aligned with the locating pin on the rear lower leg.

**WARNING: Ensure the adaptors are engaged before use by pulling them upwards.**

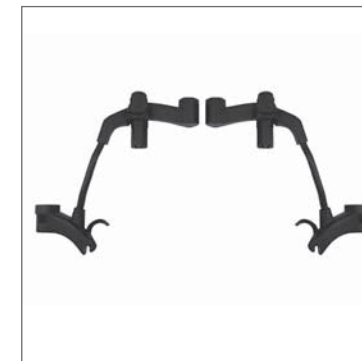
**2. Removing the tandem adaptors.**

Depress the grey buttons, un-hook the lower section from the rear leg and remove from the chassis.



egg®

**3. Fitting the tandem seat units.**

Fit the tandem adaptors as described in point 1. Fit the lower seat unit adaptor cups on to the seat legs (left and right). With the chassis handle fully extended, lower the seat unit into the tandem adaptors until it locks into place with a click.

**Note:** The adaptor cups are only for use with the tandem seat in the lower position.

**Note:** Always fit the lower seat first in the forward facing position. The lower seat unit has a 2 position recline only. Do not try force the seat into the 3rd recline position. Always fit the upper seat unit in the forward facing position.

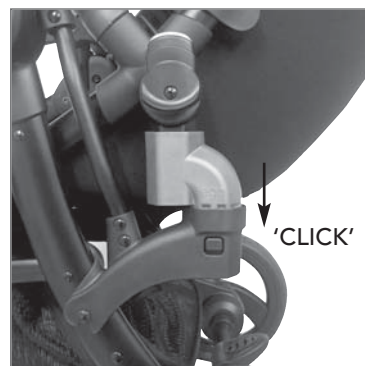
**4. Removing the tandem seat units.**

Depress the grey buttons on the side of the seat unit and lift the seat upwards from the chassis.

Remove the adaptor cups.



egg®

**5. Fitting the tandem carrycots.**

Fit the tandem adaptors as described in point 1. Holding the lower carrycot by the carry handle; guide the carrycot in horizontally foot-end first until the fittings on the carrycot line up with the fittings on the tandem adaptor. Push the carrycot into the tandem adaptor until it locks into place with a click.

**Note:** Always fit the lower carrycot first, in the forward facing position. Always fit the upper carrycot in the parent facing position.



The carrycot hood has an intermediate position (45 degrees) to allow viewing when the carrycot is used in the tandem mode, lower position.

**6. Removing the tandem carrycots.**

Depress the buttons on the side of the carrycots and lift upwards from the chassis.



egg®

**7. Fitting the tandem car seat adaptors.**

Fit the tandem adaptors as described in point 1.  
Fit the lower car seat adaptors (curved) to the lower position until they click into place.  
Fit the upper car seat adaptors (straight) to the upper position until they click into place.  
The adaptors are marked L for left and R for right from the perspective of standing behind the handle of the chassis.

**WARNING: Ensure the adaptors are engaged before use by pulling them upwards.**

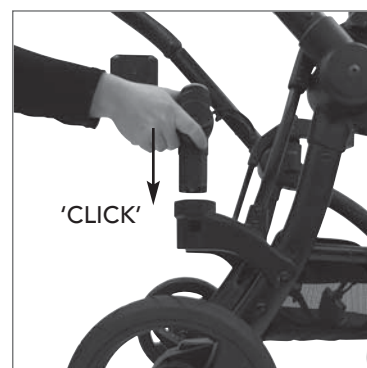
**8. Removing the tandem car seat adaptors.**

Depress the grey buttons on the car seat adaptors and lift off the chassis.



egg®

**9. Fitting the tandem car seats.**

Lower the car seats onto the adaptors and press down firmly until the car seats clicks into place.

**WARNING: Ensure the car seat is locked into place by gently pulling the car seat upwards.**

**Note:** Always fit the lower car seat first, parent facing. Always fit the upper car seat parent facing.

**10. Removing the tandem car seats.**

Depress the buttons on either side of the car seat and lift off the adaptors.



egg®

## Tandem Modes

**WARNING:** Never attempt to use the egg in any other combinations other than shown.

## 1. Tandem Seat Units



## 2. Tandem Carrycots



## 3. Tandem Car Seats



## 4. Forward facing lower carrycot, parent facing upper car seat.



## 5. Forward facing lower seat unit, parent facing upper car seat.



## 6. Forward facing lower carrycot, forward facing upper seat unit.



egg®

## Care and Maintenance.

- Regularly check screws, rivets, bolts and fastenings to ensure they are locked tight and secure. Replace any parts in an inferior condition. When using this product during the winter, by the sea or off-road it is important to clean using clean fresh water and dry thoroughly. Salt water and salt and grit from the roads will corrode metal parts unless removed.
- Check on a regular basis that all chassis locking devices are working correctly.
- If any part of the product is damaged, contact your local egg retailer immediately.
- Do not expose the product to excessive sunlight for extended periods of time, even normal exposure to sunlight may cause change to the colour of the fabrics.
- Take care not to tear fabrics when transporting the product.
- Light oil or silicone spray can be used to lubricate moving parts. Use petroleum jelly to lubricate the front axle stubs. Periodically remove the front swivel wheel units to clean and lubricate using petroleum jelly.
- Ensure zips are either fully open or closed to prevent damage.
- Always use the raincover in inclement weather.
- Do not place items on top of the hood/canopy, it could damage the fabrics or render the product unsafe.
- Any load attached to the handle and/or on the back of the backrest and/or on the sides of the vehicle will affect the stability of the vehicle. Do not hang any load from the handle or chassis when using as a tandem vehicle.
- Tyres can leave marks on some surfaces such as vinyl flooring and carpet.
- Fabrics should be cleaned in accordance to the care labels.
- Do not place fabrics in a washing machine, hand wash or sponge clean only using a mild detergent and warm water (30°C).
- Do not use a buggy board with this product as it will invalidate your warranty.

### Should you find a defect with this product:

Keep your original receipt of purchase safe with your warranty information as it will be required should you unfortunately find a defect. The receipt must show the date of purchase clearly. In the first instance you must contact the original place of purchase. Exchanging or returning the product cannot be requested. Repairs to any part of this product do not extend the warranty period. Do not return your product direct to the manufacturer.

### Servicing of your egg product.

We recommend that this product is regularly maintained and is serviced by an egg authorized dealer at least every 12 months and before upgrading to a tandem mode. Only replacement parts supplied or recommended by the manufacturer/distributor shall be used.

### Disclaimer.

Whilst we believe the information set out in this instruction manual to be correct and reliable at the time of print, we do not accept responsibility for its accuracy and we shall not be liable for its interpretation and its use. We reserve the right to change, modify add or delete product specifications at any time without prior notice.

## Your egg Warranty.

At egg we pride ourselves in manufacturing high quality products with our customers' safety and wellbeing at the forefront of our minds.

### Registering your egg product.

Thank you for purchasing an egg product. To activate your warranty and register your product visit [eggstroller.com](http://eggstroller.com) and click on 'Register your product' to complete the registration online.

### Your warranty policy.

At egg, we guarantee your product has been manufactured in accordance with all current European safety standards which are applicable to this product, and that this product is free from defects in workmanship and material at the time of purchase.

During the production process this product has gone through rigorous quality checks. Despite our efforts, if this product does show a manufacturing or material defect within the 24 months warranty period for the chassis and seat frames and 6 months for carrycot, seat fabrics and PVC raincover we will comply to the warranty terms and conditions providing the product has been used for normal use as described within the instructional manual and it has been serviced and maintained correctly also described within the instruction manual.

For further information please contact the place of purchase. Please retain your original receipt of purchase safely in the back of this booklet.

### Warranty terms.

- Chassis and seat frames: 24 consecutive months.
- Seat fabrics, carrycot, accessories and PVC raincover: 6 consecutive months.
- The warranty only applies to the original purchaser and is non-transferrable.

### The warranty will be invalidated in the following circumstances:

- a. This product has not been used for its purpose other than described within the instruction manual.
- b. If the product is returned for repair through a dealer which is not authorized by us.
- c. If the original receipt of purchase cannot be provided.
- d. If the defect is as a result of improper use or incorrect maintenance, negligence or impact damage.
- e. If the parts show normal wear that may be expected from daily use of the product, (wheels, rotating or moving parts etc).

The warranty of this product becomes valid from the date of purchase as stated on the original receipt of purchase. This does not affect your statutory rights.

### Register your product today at [eggstrolleraustralia.com.au](http://eggstrolleraustralia.com.au)

Hong Kong Design Application No. 1500774.7  
Chinese Invention Patent Application No. 201520389910.3.



egg®

## Trouble Shooting.

**Chassis will not fold after rotating grip backwards.**

Ensure the handle is in the lowest 'locked' position and that the centre section of the handle is fully rotated backwards.

Make sure no downward or upward force is applied to the handle when rotating, rotate fully before lowering the handle.

Ensure the chassis is free of the seat unit, carrycot or any adaptors.

**Bumper bar will not insert.**

Ensure the button below the bumper bar housing is pressed in while inserting the bumper bar.

**Front wheels only lock in forwards position.**

Ensure the wheels are fitted to the Right and Left (R and L marked on the top of the wheel units) from the perspective of standing facing the front of the stroller.

**Front wheels will not swivel freely.**

Remove front wheels clean axle stubs lubricate and replace.

**Removing car seat from adaptors is stiff.**

Check the adaptors are clean and free from burrs or damage, check the car seat opening where the adaptors insert is clean and not damaged.

Spray furniture polish on to the adaptor parts that insert into the car seat or apply a little vaseline and wipe away excess. Always ensure the car seat is locked in position before use.

**Tandem Carrycot in lower position difficult to fit.**

Angle the foot end of the carrycot down slightly as you lower forwards onto and into the adaptors. If the carrycot is angled back towards the head end it may be obstructed by plastic parts on the chassis.

## Notes:

egg®



Egg  
Imported and serviced by  
**love<sup>n</sup>care**  
Love N Care PTY LTD,  
297 Canterbury Road,  
Revesby,  
NSW 2212

This instruction manual:  
© BabyStyle UK Limited Exclusively for Love N Care 2016

LJS 1331/14112016v2