

# love<sup>h</sup>care™

## chicstroller

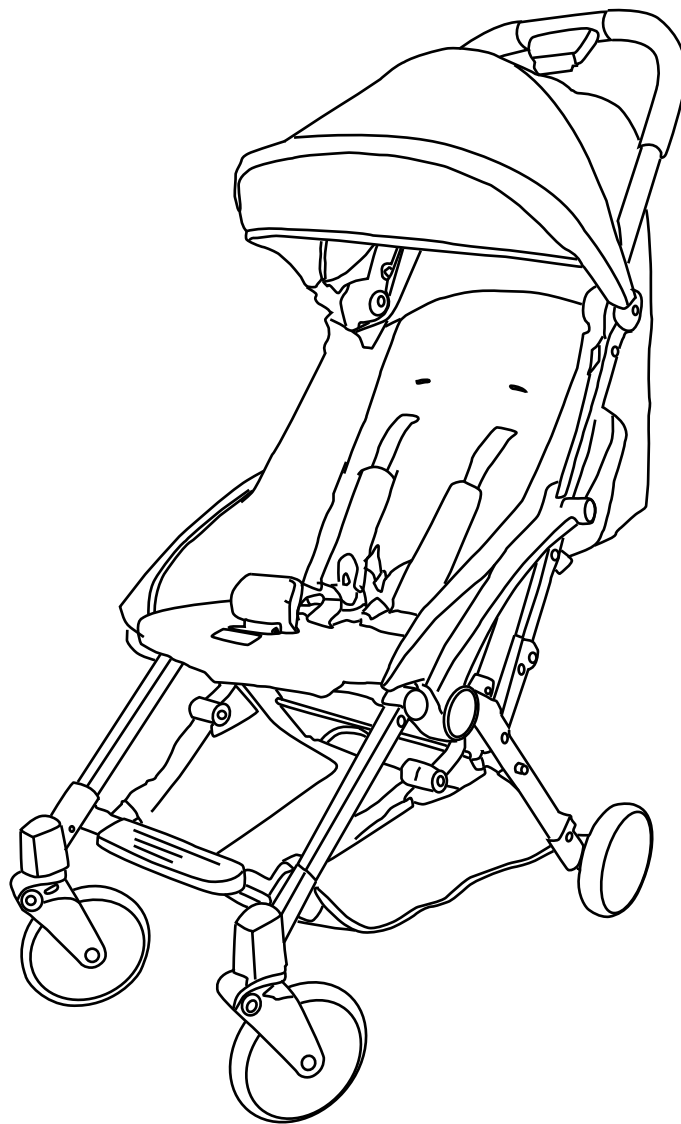

**BP 9820**

# Instruction manual

Please read these instructions carefully and keep for future reference



SAFETY GUIDELINES AND INSTRUCTIONS MUST ALWAYS BE FOLLOWED BEFORE MAKING USE OF THIS PRODUCT. PLEASE RETAIN THESE INSTRUCTIONS FOR FUTURE REFERENCE. READ ALL INSTRUCTIONS CAREFULLY BEFORE ASSEMBLY AND USE OF THIS STROLLER.

THIS PRODUCT COMPLIES WITH PRODUCT SAFETY STANDARD AS/NZS 2088:2013



## **WARNINGS**

### **TO AVOID INJURY OR DEATH**

FOLLOW THE MANUFACTURER'S INSTRUCTIONS.

PUT ON ALL THE BRAKES WHENEVER YOU PARK THE STROLLER.

ALWAYS APPLY THE BRAKES WHENEVER THE STROLLER IS STATIONARY.

DO NOT LEAVE CHILDREN UNATTENDED.

SECURE THE CHILD IN THE HARNESS AT ALL TIMES.

DO NOT CARRY EXTRA CHILDREN OR BAGS ON THIS STROLLER.

DO NOT USE THIS SEAT WITH ANY OTHER MODELS OF STROLLER.

MAKE SURE CHILDREN ARE CLEAR OF ANY MOVING PARTS IF YOU ADJUST THE STROLLER, OTHERWISE THEY MAY BE INJURED.

CHECK THAT ALL SAFETY LOCKS ARE ENGAGED BEFORE PLACING A CHILD IN THE STROLLER.

USE THE HARNESS AT ALL TIMES.

WHEN NOT IN USE DISCONNECT SHOULDER STRAPS FROM THE WAIST STRAP AND/OR BUCKLE TO PREVENT STRANGULATION.

THE HARNESS CAN FORM LOOPS WHICH MAY BE A STRANGULATION HAZARD.

NEVER LEAVE A HARNESS CONNECTED WHEN NOT FITTED TO A CHILD IN THE STROLLER.

TO AVOID SERIOUS INJURY ALWAYS USE THE HARNESS PROVIDED TO SECURE THE CHILD. (ADJUST THE STRAPS TO SUIT THE SIZE OF YOUR CHILDS BODY)

IT IS UNSAFE TO USE ACCESSORIES OTHER THAN THOSE SUPPLIED BY LOVE N CARE.

CARE SHOULD BE TAKEN IF THE STROLLER IS TO BE USED ON STAIRS OR ESCALATORS.

THIS STROLLER SHOULD NOT BE USED NEAR AN OPEN FIRE OR AN EXPOSED FLAME.

CARE SHOULD BE TAKEN WHILST FOLDING AND UNFOLDING THE STROLLER TO PREVENT FINGERS BEING TRAPPED.

ENSURE YOUR CHILDS FINGERS, HANDS AND ALL OTHER BODY PARTS ARE CLEAR FROM ANY MOVING PARTS WHEN ADJUSTING THE SEAT OR HANDLE ON YOUR STROLLER.

USE THE TETHER STRAP TO PREVENT THE STROLLER FROM ROLLING AWAY.

DO NOT RUN WHILE USING THIS STROLLER.

THE UPRIGHT POSITIONS ARE NOT SUITABLE FOR USE WHEN CHILD IS LESS THAN 6 MONTHS OLD. THE LOWEST RECLINE POSITION SHOULD BE USED FOR CHILDREN UNDER 6 MONTHS.

**MAXIMUM WEIGHT OF CHILD SHOULD NOT EXCEED: 20KG**

**MAXIMUM WEIGHT FOR BASKET: 5KGS**

**AGE SUITABILITY: NEWBORN - 36 MONTHS**

# partslist

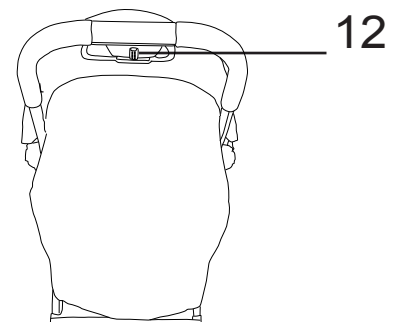
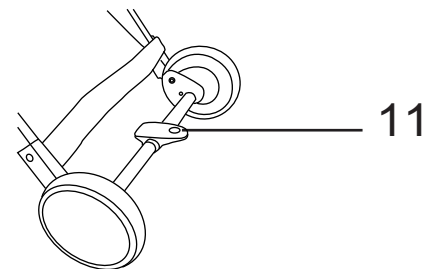
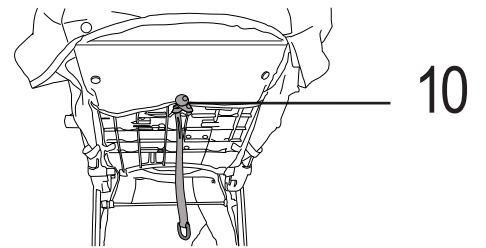
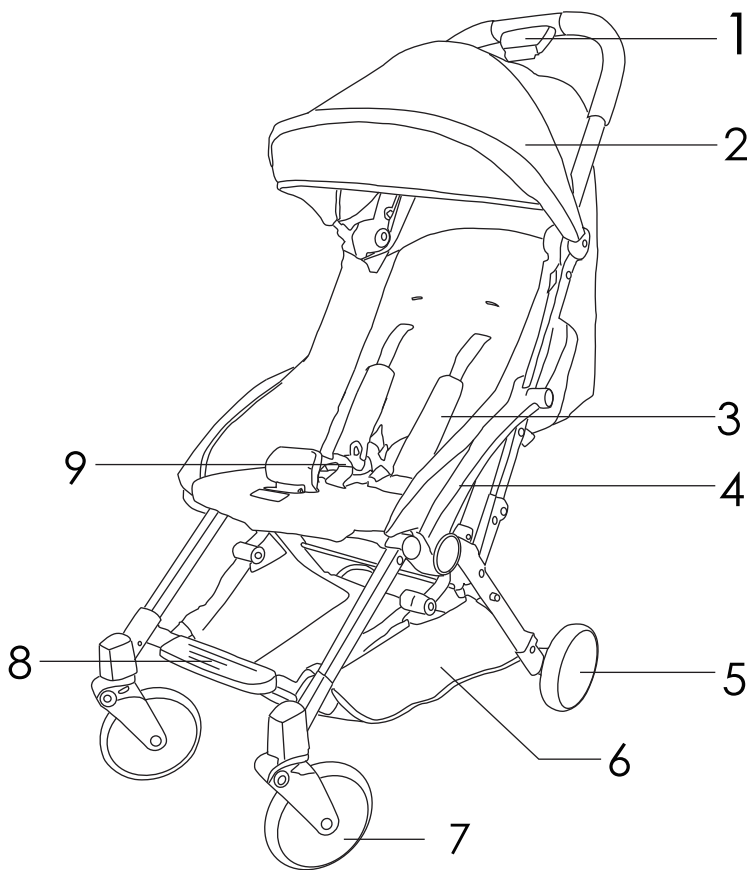

- 1.Folding button
- 2.Canopy
- 3.Shoulder Protector
- 4.Arrest
- 5.Rear Wheels
- 6.Basket
- 7.Front wheels

- 8.Foot Rest
- 9.Harness Buckle
- 10.Adjustable Button
- 11.Brake Lever
- 12.Handle Released Button

# assembly

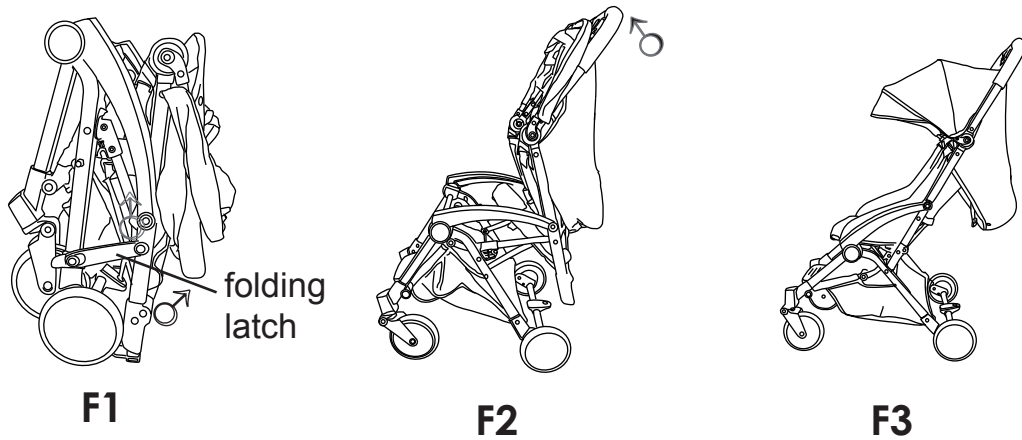

- 1.To unfold frame:see F1,release the locked folding latch;Hold handle grip by one hand,pull up the buggy unit unfolded complete.
- When opening or folding the stroller ,be aware of the danger of being injured by moving parts and locking devices during this process. Keep all hands and limbs clear of these parts and in particular be aware to keep children away from any danger.
  - Open the stroller slowly and be careful where you place your hands. Keeping your hands on the handle is the best way to fold or unfold the stroller.

- 2.To use brakes:step down brake levers and the pushchair is braked;step up brake levers and the braking is released.

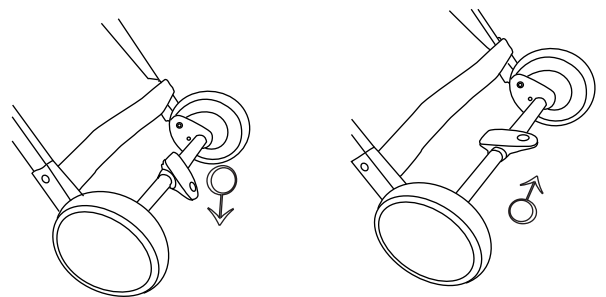

- 3.To use canopy:push back the canopy rod,the canopy can fold step by step;pull the canopy rod,the canopy can open step by step.

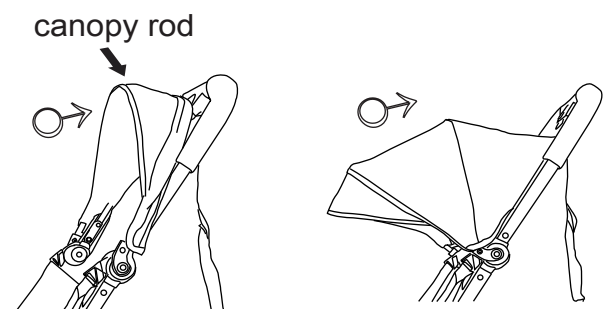

# instructions

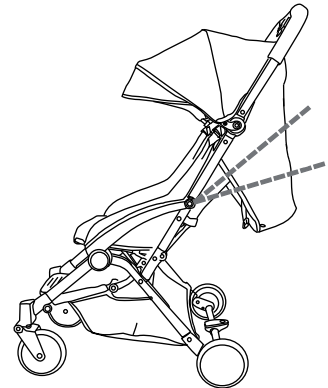
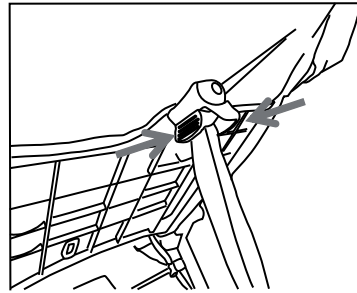
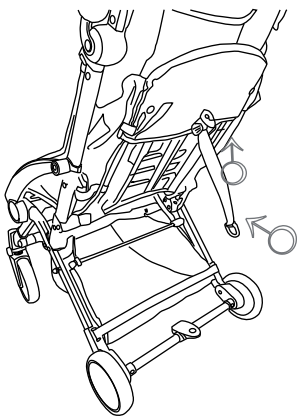

4.To use reclining back rest:pinch the recline button and push up,the other hand hold the recline strap and adjust,the back rest can change between 105 degrees and 155 degrees.

5.To use restrain system:to use the harness place the shoulder harness (1)over the child's shoulder onto the crotch strap buckle then place the waist strap around the child's waist and insert into crotch strap. They should click into place. Pull on it slightly to make sure. To Release press on the release button on the crotch strap.

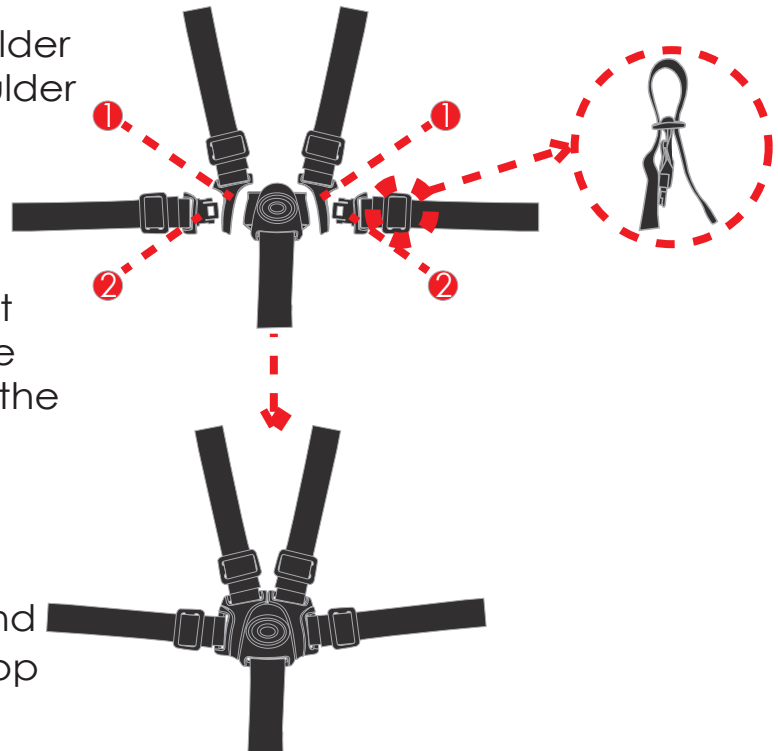

6.To adjust the harness length:as picture,shorten:draw to top clitellum the draw the end belt,locked,elongate:pull the top clitellum the shorten the end belt,locked

**WARNING! Always use the crotch strap in combination with waist belt.**

# CARE AND MAINTENANCE

## **maintenance**

All Love N Care products have one year warranty from the date of purchase.

After a few months of using your stroller it may get a bit dirty from usage.

These tips will help you take care of your Love N Care Stroller and keep it running smoothly.

- Clean the frame with a soft towel and lukewarm water and wipe off any remaining water with a dry cloth.
- Use a soft brush to clean sand and dirt from the mechanisms. Take care to brush away from any sliding joints.
- Use a sponge, warm water and liquid soap to gently rub off any dirt on the handlebar. Wipe clean any soap residue left on the handlebar.
- Use a brush and water to clean dirt on the wheels. Periodically, remove the wheels from the frame and brush off any dirt or sand in the inside axle of the wheel.
- Store your stroller and its accessories in a dry place and leave them unfolded when wet to prevent mould.

7.To fold:

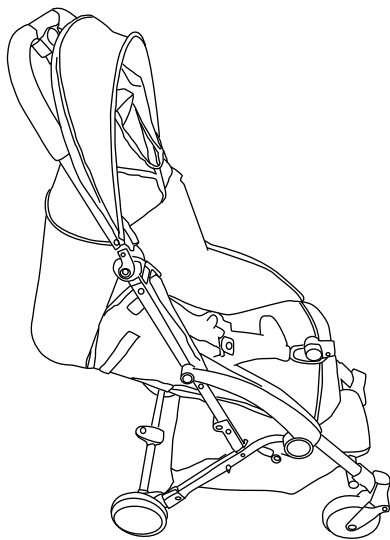

A

1)fold the canopy upright as shown in position(A)

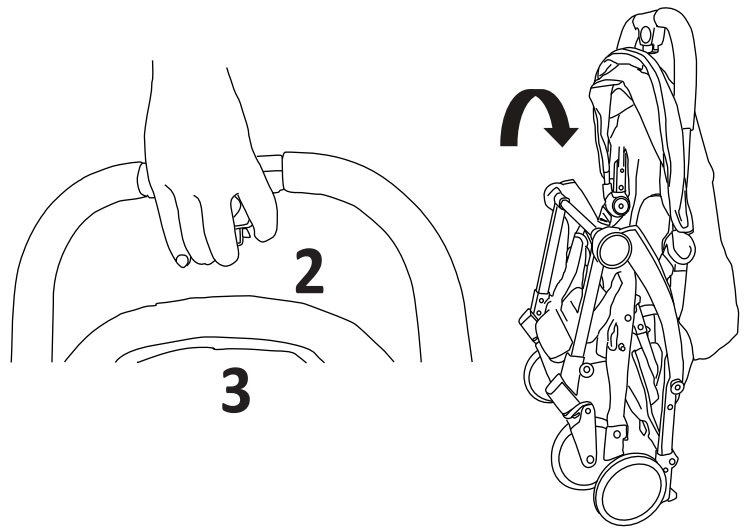

B

2)hold the handles,press button 2, in the meantime press button 3, press down the handles until the stroller can stand by itself(B)

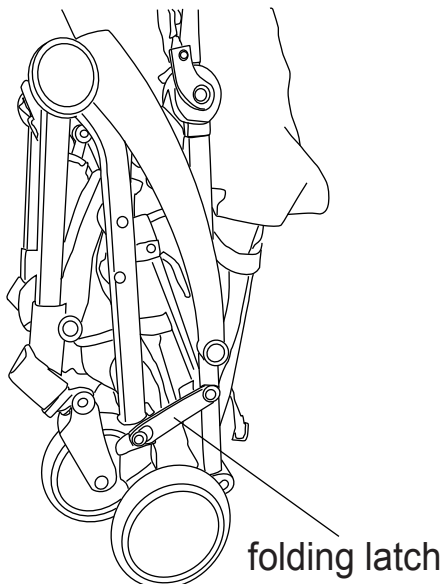

C

3)close the folding latch and and ensure it's locked(C)

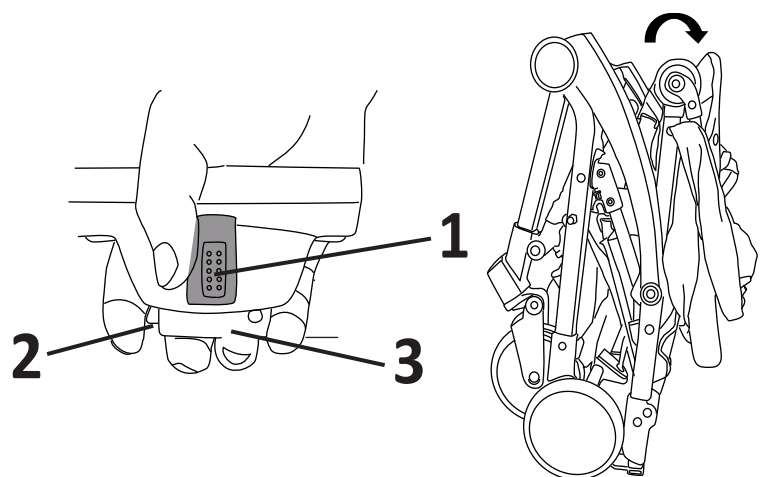

D

4)hold the handles,press button 1, in the meantime press button 2 and button 3,move back the handles until in the end position(D)



## **WARNINGS:** USE THE TETHER STRAP TO STOP THE STROLLER ROLLING AWAY.

- THE STROLLER IS DESIGNED FOR USE ON FLAT OR GENTLY SLOPING SURFACES, AND MAY BE UNSTABLE ON HIGHER SLOPING AND UNEVEN SURFACES AND USERS SHOULD BE AWARE OF THE POSSIBILITY OF THE STROLLER ROLLING AWAY OR TIPPING OVER.
- NEVER LET GO OF THE STROLLER WHEN PARKED ON AN INCLINE OR SLOPING SURFACE BECAUSE IT MAY SLIDE OR TIP OVER. ALWAYS PARK ON A FLAT SURFACE AND APPLY THE BRAKES.
- ALWAYS APPLY THE BRAKES WHENEVER THE STROLLER IS STATIONARY

A WRIST TETHER STRAP IS PROVIDED ON THE HANDLE GRIP. SLIDE YOUR HAND THROUGH THE TETHER STRAP LOOP WHENEVER YOU USE THE STROLLER. ONLY REMOVE YOUR HAND FROM THE TETHER STRAP LOOP WHEN THE BRAKES HAVE BEEN APPLIED TO THE STROLLER WHEELS.



### **WARNING**

USE THIS STRAP TO STOP THE PRAM/ STROLLER ROLLING AWAY

## **Lifting and carrying the CHIC STROLLER safely:**

**IMPORTANT:** Do not lift or carry the CHIC STROLLER when a child is in it.

**IMPORTANT:** Do not lift or carry the CHIC STROLLER when fully assembled. Only lift and carry when folded.

Safe lifting and carrying of the **CHIC STROLLER** frame when folded

### **IMPORTANT:**

1. Always lift and carry the frame using two hands.
  2. Ensure the frame fold latch is engaged.
- TO AVOID INJURY: BEND YOUR KNEES WHEN OPENING, LIFTING, CARRYING, FOLDING, UNFOLDING OR ADJUSTING THE STROLLER OR ANY ACCESSORIES.
  - TO LIFT THE STROLLER, GRASP THE FRAME APPROXIMATELY HALFWAY ALONG THE STROLLER, SO THE STROLLER IS BALANCED.



# WARRANTY AGAINST DEFECTS

ALL LOVE N CARE PRODUCTS ARE GUARANTEED FOR TWELVE MONTHS FROM THE DATE OF PURCHASE.

OUR GOODS COME WITH GUARANTEES THAT CANNOT BE EXCLUDED UNDER THE AUSTRALIAN CONSUMER LAW. YOU ARE ENTITLED TO A REPLACEMENT OR REFUND FOR A MAJOR FAILURE AND FOR COMPENSATION FOR ANY OTHER REASONABLY FORSEEABLE LOSS OR DAMAGE. YOU ARE ALSO ENTITLED TO HAVE THE GOODS REPAIRED OR REPLACED IF THE GOODS FAIL TO BE OF ACCEPTABLE QUALITY AND THE FAILURE DOES NOT AMOUNT TO A MAJOR FAILURE.

THIS COVERS AGAINST FAULTS WHICH DEVELOP THROUGH FAULTY MATERIALS AND WORKMANSHIP. MISUSE, ACCIDENTAL DAMAGES, NORMAL WEAR AND TEAR OR NEGLECT ARE NOT COVERED.

IF A FAULT BECOMES APPARENT, PLEASE RETURN THE ITEM TO THE STORE OF PURCHASE WITH YOUR RECEIPT. YOU MUST INFORM THE STORE WHAT THE DEFECT IS. WE WILL THEN ARRANGE FOR ITS REPAIR OR IT WILL BE ASSESSED FOR REPLACEMENT AS EXPEDIENTLY AS POSSIBLE. THE BENEFITS OF THIS WARRANTY ARE IN ADDITION TO OTHER RIGHTS AND REMEDIES UNDER THE LAW IN RELATION TO THE GOODS AND SERVICES TO WHICH THIS WARRANTY RELATES.

IF YOU ARE UNABLE TO RETURN THE ITEM TO THE STORE OF PURCHASE, YOU CAN CONTACT LOVE N CARE ON FREECALL 1300732599. WE WILL THEN ORGANISE FOR EITHER SOMEBODY TO INSPECT THE ITEM OR ARRANGE FOR A COURIER TO PICK IT UP AND RETURN IT BACK TO YOU.

FOR MORE INFORMATION PLEASE CONTACT: LOVE N CARE PTY LTD  
EMAIL: [info@lovencare.com.au](mailto:info@lovencare.com.au)  
WEB: [www.lovencare.com.au](http://www.lovencare.com.au)  
PHONE: 1300 732 599  
FAX: 02 9774 4633



## Contact Us

Head Office:  
Love N Care Pty Ltd.  
297-299 Canterbury Rd, Revesby  
NSW 2212 Australia  
Contact No: 02 9774 4655  
Fax: 02 9774 4633  
Email: [info@lovencare.com.au](mailto:info@lovencare.com.au)  
Website: [www.lovencare.com.au](http://www.lovencare.com.au)

 <http://www.facebook.com/lovencare1>

 [http://twitter.com/love\\_ncare](http://twitter.com/love_ncare)



100 % AUSTRALIAN OWNED SINCE 1984

let's be friends!

**lovehncare™**  
[lovencare.com.au](http://lovencare.com.au)