

love^hcare™

HARMONY BOUNCER



BP 6619

IMPORTANT! READ CAREFULLY AND KEEP FOR FUTURE REFERENCE.

CONGRATULATIONS

Congratulations on purchasing your new Love N Care Bouncer.

In just a few steps you should be able to assemble this unique product and have it ready to meet your beautiful child :)



WARNINGS



WARNING: Prevent serious injury or death:



WARNING: NEVER leave child unattended.



WARNING: ALWAYS use restraint system.



WARNING: NEVER use for a child able to sit up unassisted.



FALL HAZARD: Child's activity may move product.
Use only on floor. Never use on an elevated surface.



SUFFOCATION HAZARD: Never use on a soft surface (bed, sofa, cushion), as seat may tip over and cause suffocation.

- Never leave baby in the bouncer without supervision.
- Do not use the bouncer once the child can sit up unaided.
- Baby's movements could make the bouncer tip over.
- Do not use the bouncer if any part is broken or missing.
- Always use the safety attachment system.
- Before using, check that all parts are properly locked into position and adjusted correctly.
- Check the suspension system of the rocker regularly.
- Only use a 3-point safety harness.
- Do not use the bouncer without its seat liner.
- It is dangerous to put this bouncer on any surface high up.
- Never place the bouncer on a soft surface (bed, sofa, cushion), as seat may tip over and be dangerous for baby.
- This bouncer is not designed for baby to spend long periods asleep in it. You are recommended to put your baby in a bed.
- The bouncer is not a carrycot, nor a car seat. Always use the straps and adjust them properly, even if baby will only be in the rocker swing for a short time.
- Never lift the bouncer using the toy bar.
- Never lift or carry the bouncer with baby in it.
- Keep the plastic bags of the packaging out of reach of babies and young children to avoid any risk of suffocation.
- Never add any pillow, blanket or padding: use only the head cushion supplied with the bouncer.

WARNINGS

- Do not put objects with strings around the neck of your baby, do not hang strings from the rocker swing and do not attach strings to toys. This could lead to strangling.
- Do not put the bouncer close to a window where the strings of a blind or curtains could lead to strangling.
- Do not allow your baby to play with the bouncer folded up.
- Do not attach other toys than those supplied.

NEVER place a child under 5 lbs. (2.26 kg) or over 20 lbs. (9 kg) in the product.

- Discontinue use of product should it malfunction or become damaged. Please contact our customer service department at 1300-732-599 to arrange for repair or obtain replacement parts.

The maximum weight of the child for which the reclined cradle is intended, that is **9kg**.; The highest position maximum weight is **9kg**, the second position maximum weight is **6kg**, the lowest position maximum weight is **6kg**.

COMPONENTS

- A. Frame
- B. Fabric cover
- C. Toy bar

- A1 - Base frame
- A2 - Recline tube
- A3 - Back supporting tube
- A4 - Back Rest adjustment mechanism
- A5 - Red second lock for folding
- B1 - Safety Harness
- B2 - Crotch Pad
- C1 - Toys

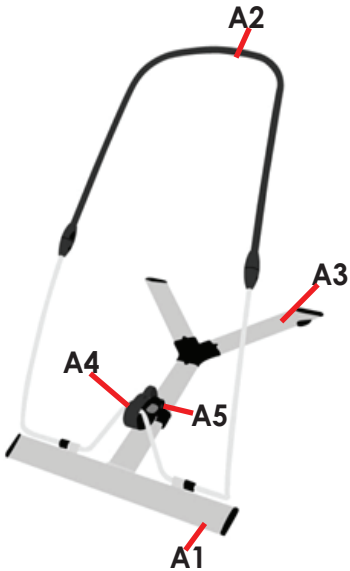

A- Frame

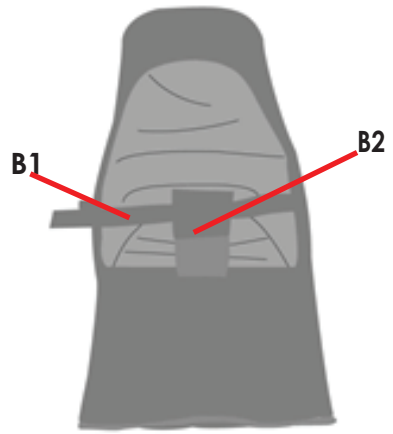

B- Fabric Cover

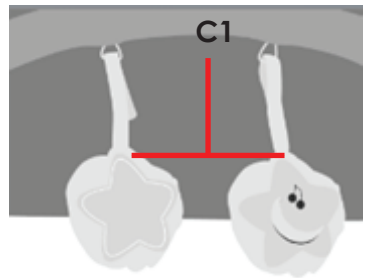

C- Toy Bar

ASSEMBLING THE BOUNCER

1. Remove the product from carton box, connecting the Base frame (A1) with back supporting tube (A3) by bolts, as shown in (1.1)
2. Hold the recline tube (A2) and connect with base frame (A1) by rotating the plastic knuckle tightly, repeat the same operation with the other side, as shown in (2.1)
3. Slide the fabric cover (B) go through the recline tube (A2), pulling down to the bottom base, fix the fabric cover with elastics on both sides tightly as shown in (3.1)
4. Fix the toy bar (C) on the seat as shown in (4)

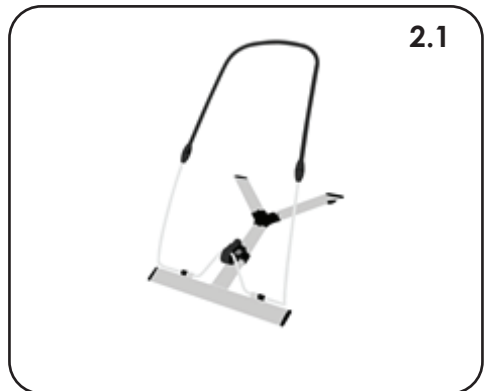
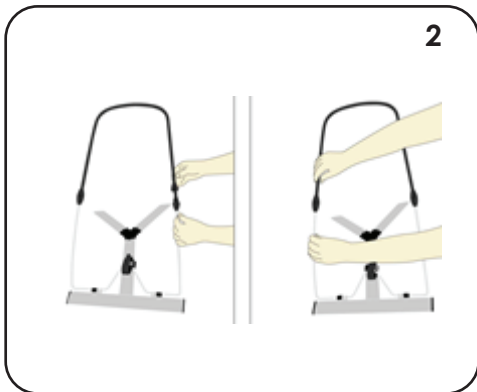
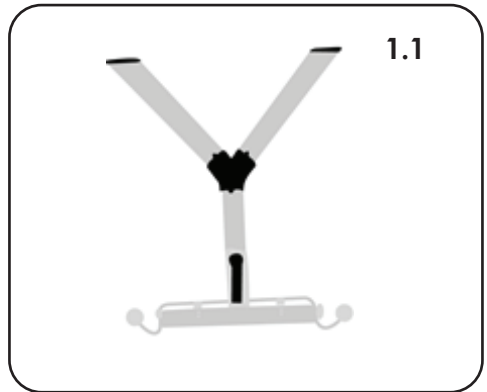
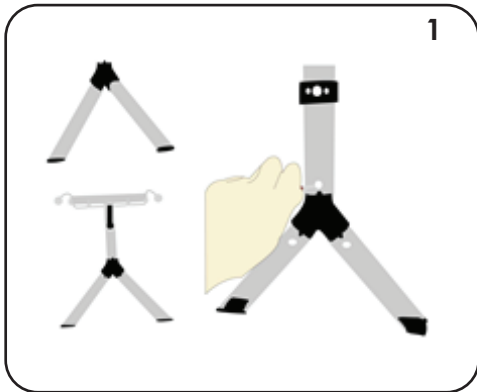

ASSEMBLING THE BOUNCER

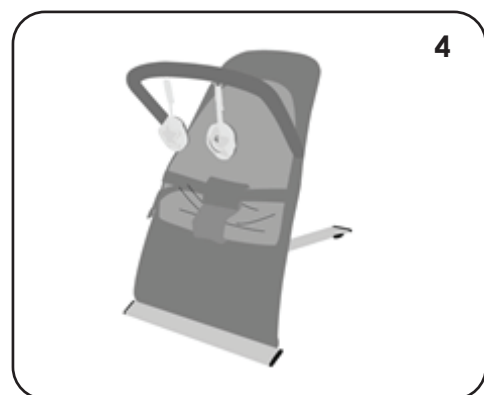
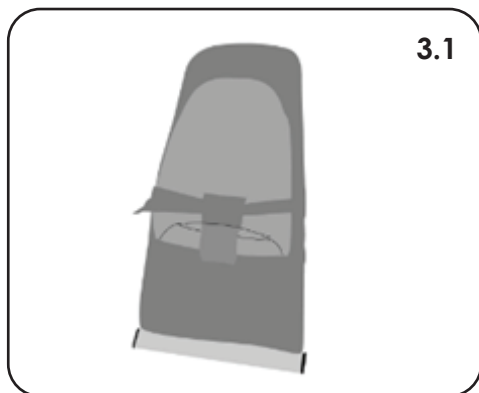
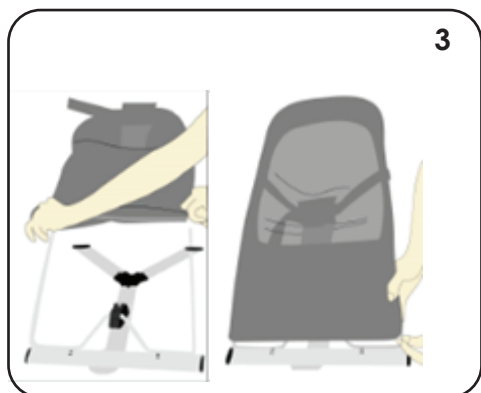

Above is the fully assembled bouncer and is ready to be used.

WARNING: Check to make sure that all of the fasteners have been correctly attached

USING THE BACKREST RECLINE ADJUSTMENT

Lift up the back rest recline adjustment (1.1), This has three position adjustment, shown as (1.2),

Remark: Adjust the recline from lowest position to highest position, only lift up the backrest directly with one hand.

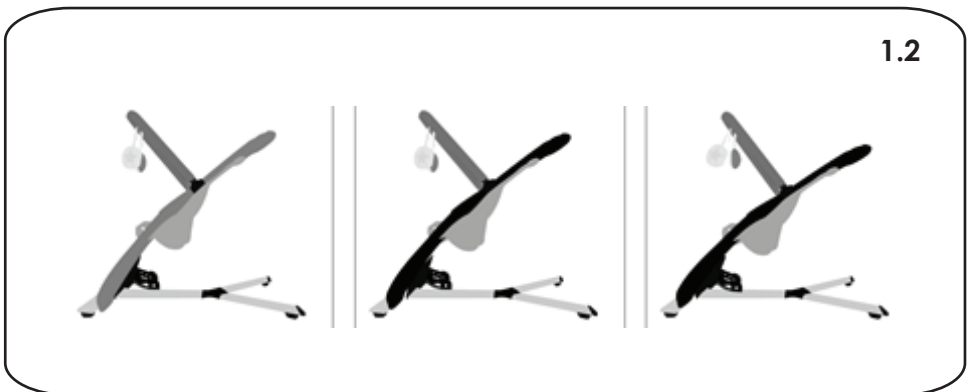
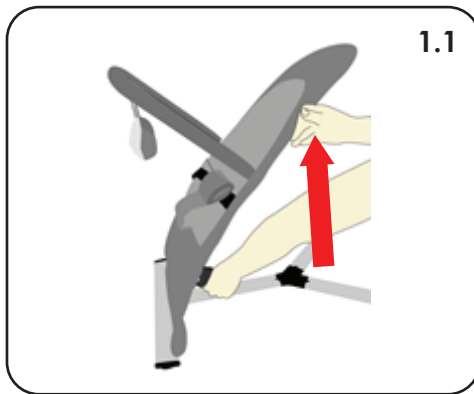

FOLDING THE BOUNCER

In order to store the bouncer easily or for transportation.
Pls follow up below steps to fold it:

1. Folding the seat, need to lift up the backrest first with right hand (2.1), upwards the backrest adjustment mechanism with left hand (2.1), when you reach the lowest position, lift up the red second lock (A5), then fold the seat, as shown in (2.2)

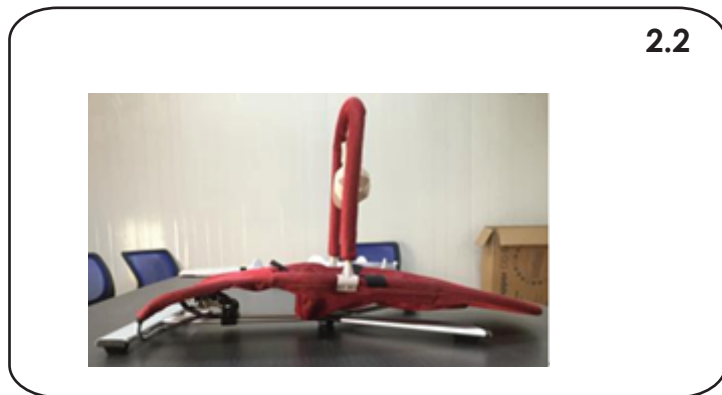
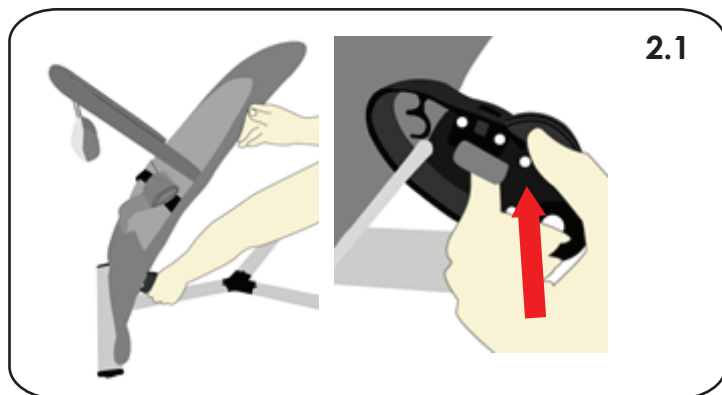

WARNING: in order to fold the bouncer for storage / or transportation, the secondary safety lock must be pressed and activated.

REMOVING THE LINER

Disassemble the elastics on the bottom of the seat on both sides. (1.1)

Then pull out the removable fabric lining from the seat frame (2.1). Pay attention not to damage the lining.

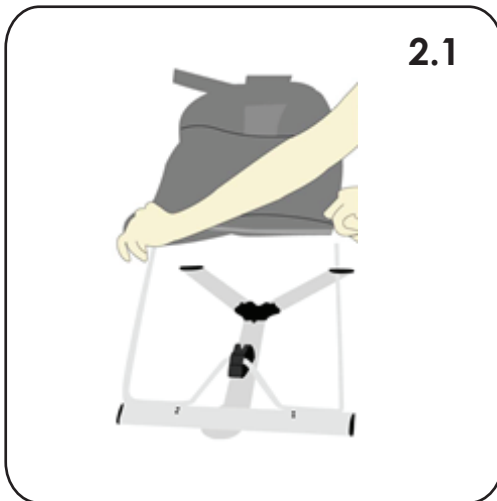
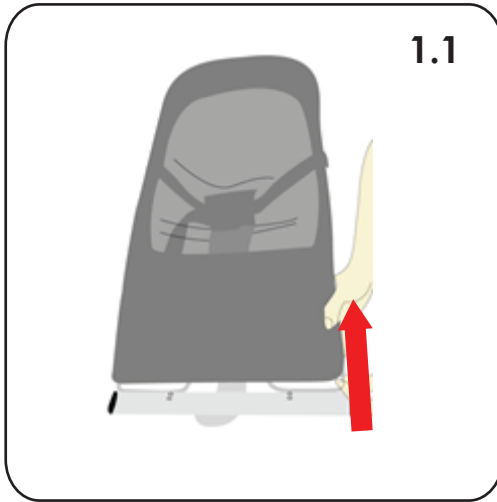

CARE AND MAINTENANCE

The bouncer has a resistant fabric cover which is completely removable and washable.

To wash the fabric seat, loosen the two elastic loops at the bottom and pull it off the frame.

Wash separately, **HAND WASH ONLY**. Do not tumble-dry.

For cleaning, do not use solvents, abrasive or aggressive products.

Do not use accessories or replacement parts other than those approved by the manufacturer.

Hand wash only

Do not bleach

Do not Iron

Do not dry clean

Do not tumble dry



WARRANTY AGAINST DEFECTS

All Love N Care products are guaranteed for twelve months from the date of purchase. Our goods come with guarantees that cannot be excluded under the Australian Consumer Law.

You are entitled to a replacement or refund for a major failure and for compensation for any other reasonably foreseeable loss or damage.

You are also entitled to have the goods repaired or replaced if the goods fail to be of acceptable quality and the failure does not amount to a major failure.

This covers against faults which develop through faulty materials and workmanship. Misuse, accidental damages, normal wear and tear or neglect are not covered.

If a fault becomes apparent, please return the item to the store of purchase with your receipt.

You must inform the store what the defect is. We will then arrange for its repair or it will be assessed for replacement as expediently as possible. The benefits of this warranty are in addition to other right and remedies under the law in relation to the goods or services to which this warranty relates.

If you are unable to return the item to the store of purchase, you can contact Love N Care on free call 1300 732 599.

Where you send the product directly to the manufacturer then you may be liable for the costs of transportation to and from Love N Care.

Love N Care will meet the reasonable expenses incurred by a consumer in a making a warranty claim. You can claim expenses incurred in making a claim by contacting our customer service team on 1300 732 599 or by email at info@lovenecare.com.au



12 MONTH WARRANTY

BP 6619 Harmony Bouncer

Please fill in this section to validate your warranty and send to: **297 Canterbury Rd Revesby NSW 2212**

Name: _____

Store Purchased: _____

Address: _____

Date Purchased: _____

Product Name/No. _____

Contact Us

Head Office:

Love N Care Pty Ltd.
297-299 Canterbury Rd, Revesby
NSW 2212 Australia
Contact No: 02 9774 4655
Fax: 02 9774 4633
Email: info@lovencare.com.au
Website: www.lovencare.com.au

love^hcare
lovencare.com.au

Let's be friends!

 <http://www.facebook.com/lovencare1>



100 % AUSTRALIAN OWNED SINCE 1984