

love^hcare™ BP 6617

2-in-1 LUNAR SWING

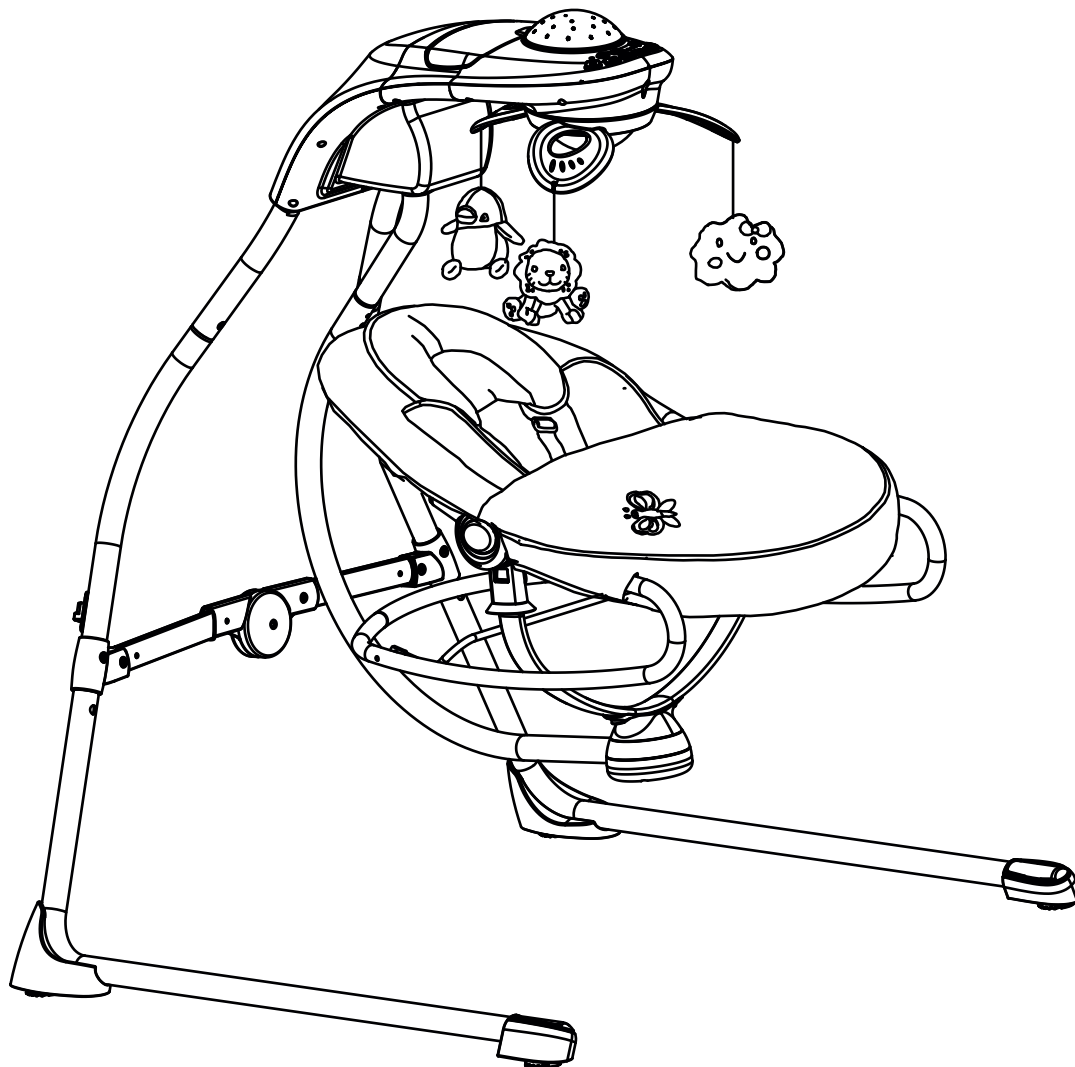

Read all instructions before assembly and use of product. Keep instructions for future use.





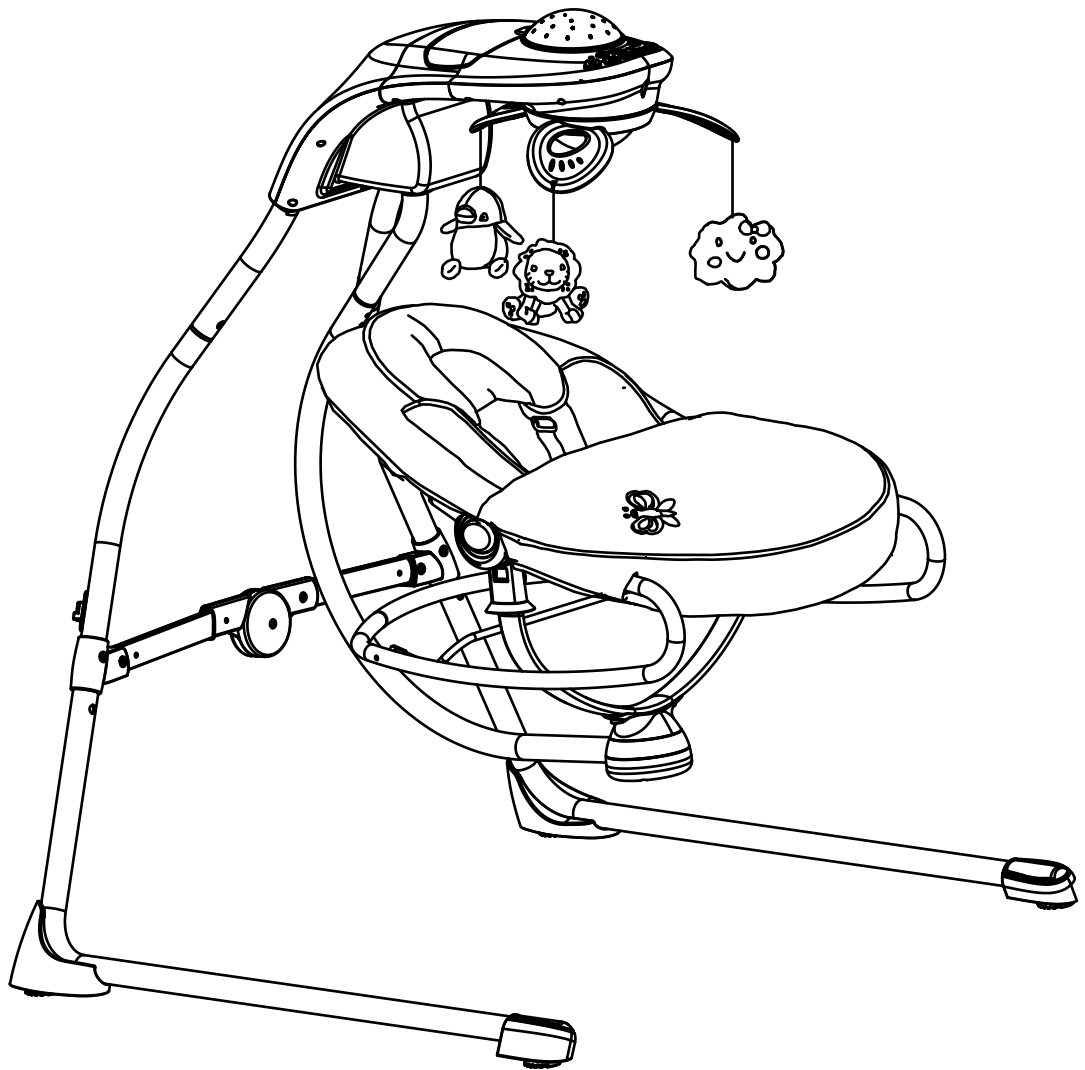

Congratulations

Congratulations on purchasing your new Love N Care Swing/Rocker. In just a few steps you should be able to assemble this unique product and have it ready to meet your beautiful child :)



- Please read this instruction manual carefully before using the bouncer and keep it together with packaging for future reference.
- Swinging unit requires 4 x LR20 batteries 1,5 V (not included).
- This bouncer is intended for children weighing up to 9 kgs.
- Actual product may differ from image shown.

WARNINGS

-  **WARNING:** Prevent serious injury or death:
-  **WARNING:** NEVER leave child unattended.
-  **WARNING:** ALWAYS use restraint system.
-  **WARNING:** NEVER use for a child able to sit up unassisted.
-  **FALL HAZARD:** Child's activity may move product.
Use only on floor. Never use on an elevated surface.
-  **SUFFOCATION HAZARD:** Never use on a soft surface (bed, sofa, cushion), as seat may tip over and cause suffocation.

NEVER place a child under 5 lbs. (2.26 kg) or over 20 lbs. (9 kg) in the product.

- All plastic packaging and elements which are not a part of the bouncer set should be removed before giving it to the child.
 - The bouncer must be assembled by an adult only. The product should be checked by an adult before every use.
- The bouncer set includes small parts and should be kept away from babies before it is assembled.
- Never leave the child unattended. Never use for a baby who is able to leave the bouncer on its own.
 - Use in reclined position until your child is not able to hold up head unassisted.
 - Do not use if your child is able to sit upright unaided or weighs more than 9 kgs.
 - Never use on a soft surface (e.g. bed), as bouncer may tip over and cause suffocation.
 - Never leave the bouncer on uneven or sloping surfaces.
 - Never use this product on an elevated surface e.g. table - it is dangerous. Always use it on the floor.
 - This bouncer is not intended for prolonged period of sleeping. It does not replace a bed. Should your child need to sleep, then it should be placed in a bed.
 - Always use the restraint system while child is in the bouncer.
 - Never lift the bouncer using a toy bar as a handle.
 - Never lift or move the bouncer when the baby is inside.
 - Never use the bouncer if there are any parts missing or broken. Never use any accessories or replacement parts unless they are ones approved by the manufacturer. Regularly check the condition of the bouncer.
 - Keep bouncer away from open fire and other sources of heat.
 - If the bouncer is not used for prolonged period of time - remove batteries. After dismantling - keep parts away from babies.

IMPORTANT! Small parts are included in the box. Product must be assembled by an adult.

Parts List

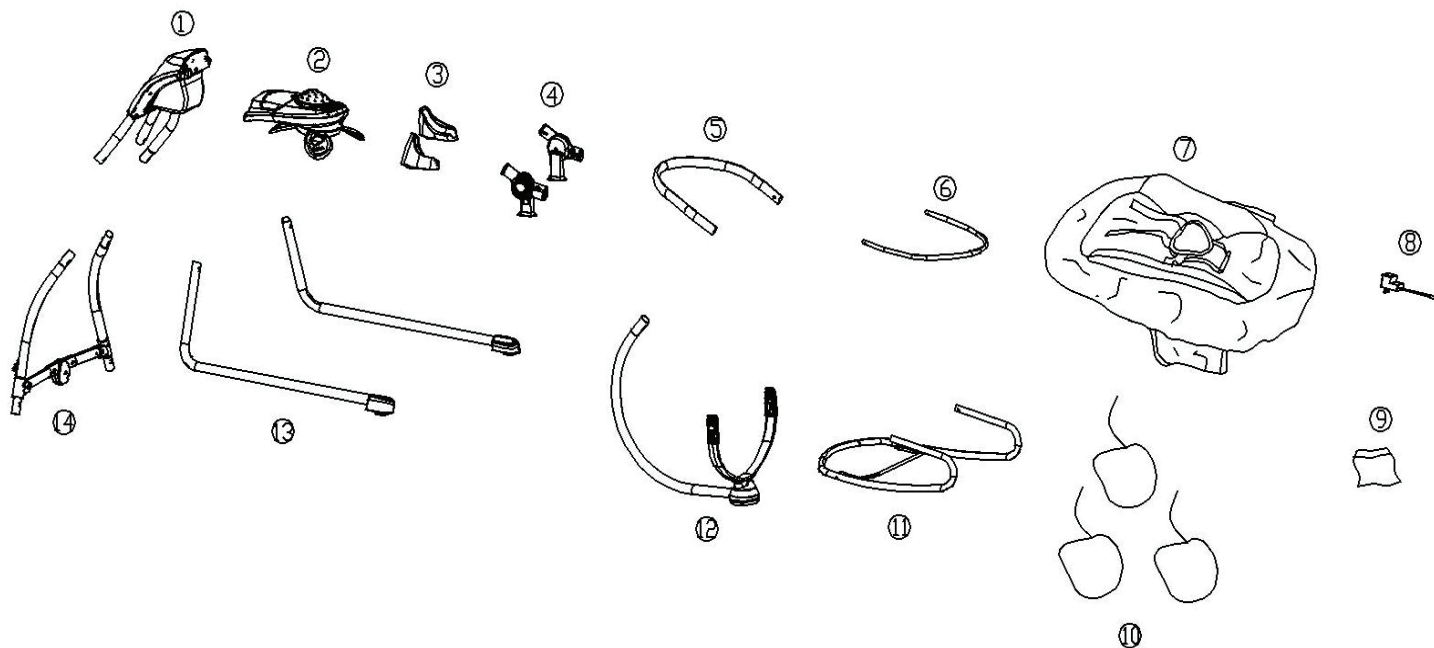

NO.	Content
1	Drive Box
2	Control Box
3	Rear Base Covers L+R
4	Position Adjustment Component × 2
5	Backrest Tube
6	Footrest Tube
7	Seat Cover
8	Adapter (Option)
9	Spare Parts Bag
10	Toys
11	Seat base Frame
12	Swing Frame
13	Base Tubes L+R
14	Support Frame

- Actual product and Parts may differ from images shown.

Please make sure all parts are included before proceeding to assembly

Assembly

1. Push the socket of Control Box into the one of Drive Box parallelly according to Fig.1.
Ensuring the sockets of both boxes are corresponding and correctly inserted and both of the two boxes shall be on the horizon after installation.

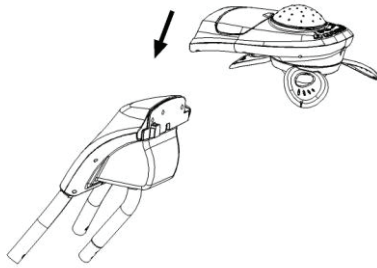

Fig.1

2. Assembling the Left and Right rear base covers on the base tubes with specified screws, the rear base covers are in different pointing and with marker for correctly installation. (Fig.2 No.1)

Join the support frame and the base tubes together, push the ends into the both base tubes housing until the snap pins click and lock into place. (Fig.2 No.2)

Connect the support frame with the power unit assembly on the step 1. Push the free ends together until the snap pins click and lock into place. (Fig.2 No.3)

Join the free ends of the power cables from the support frame and the drive box. (Fig. 2 No.4)

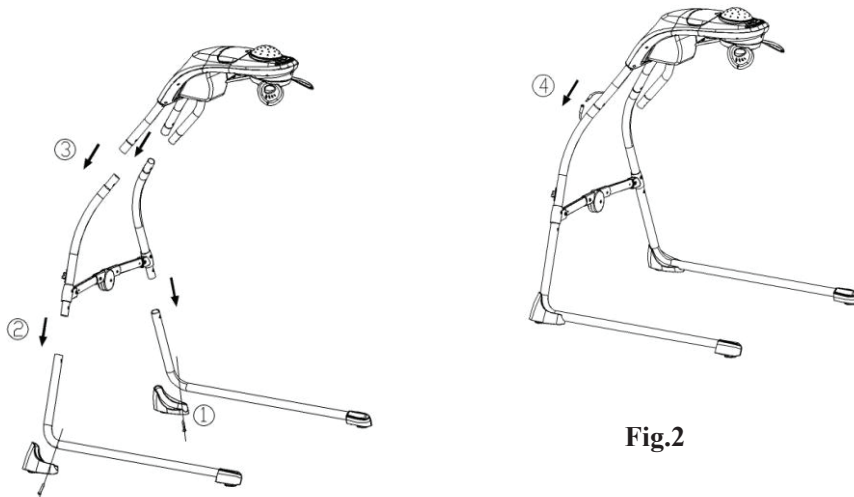

Fig.2

- 3. Join the swing frame into the corresponding housing of the drive box, fix with the given screws of spare parts bag and ensuring to screw up. (Fig.3)**

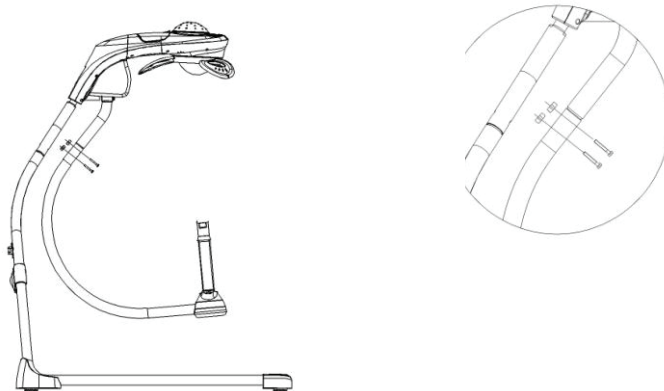

Fig.3

- 4. Separately push the backrest tube/footrest tube into the FRONT/BACK of the position adjustment component holders until the snap pins click and ensure that it has locked into place. (Fig.4)**

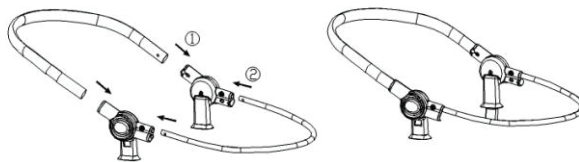

Fig.4

- 5. Slide the seat cover on to the seat frame assembly. (Fig.5)**

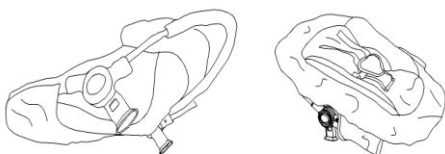

Fig.5

- 6. Attach the seat base frame to the corresponding slot at each side of the seat cover. Push the seat base frame into the lower end of the position adjustment component until the snap click and lock into place. (Fig.6)**

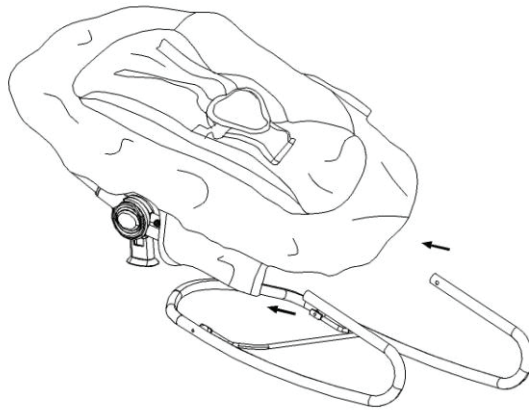

Fig.6

- 7. Join the completed seat into the U shape tube on the swing frame until the snap click and ensure it is securely in place. (Fig.7)**

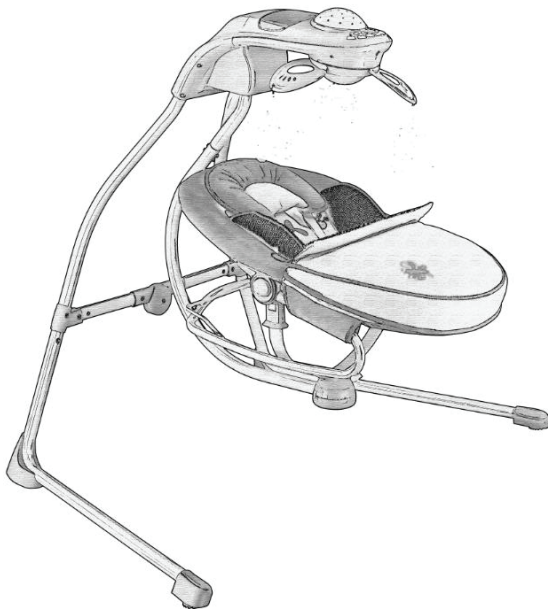

Fig.7

8. Hang the toys onto the toy plate. (Fig.8)



Fig.8

III. Operation

- 1. For batteries, remove the battery cover using a screwdriver with 4 pcs "D" batteries (Not Supplied) . (Fig.9)**

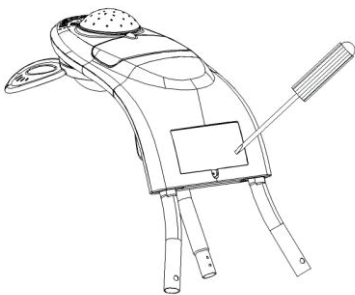

Fig.9

- 2. For Adapter (not supplied), plug into the connector at the back of support frame. (Fig.10)**

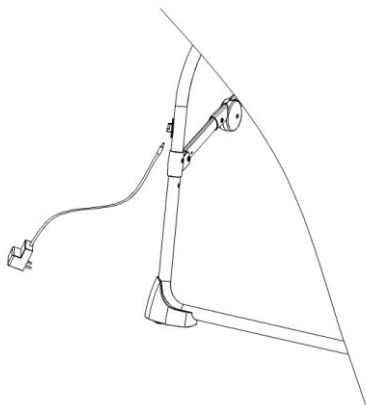

Fig.10

3. Correctly perform the functions according to the designation markers on the control box. (Fig.11)

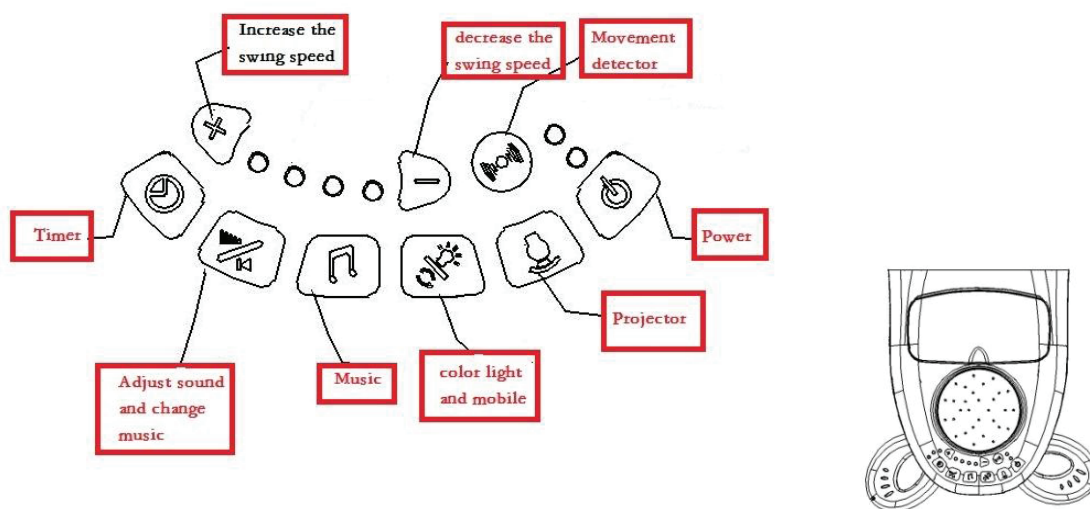

Fig.11

4. For playing more music/melodies from mobile phone, connect mobile phone with the power cable from the mounting groove on the control box. (Fig.12)

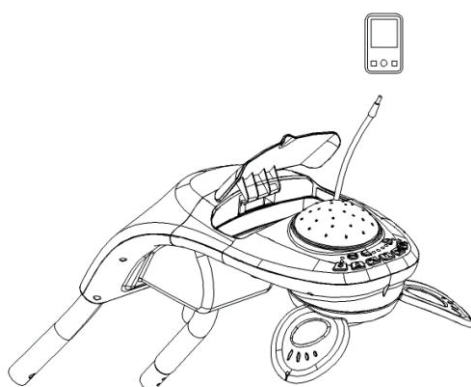

Fig.12

5. Secure the baby to the Swing by fastening the buckles on the seat. (Fig.13)



Fig.13

6. The product is a 2 in 1 design, the seat could be used as a Rocker when pull it up and out from the swing. Please don't leave the baby onto the seat when taking out. (Fig.14)

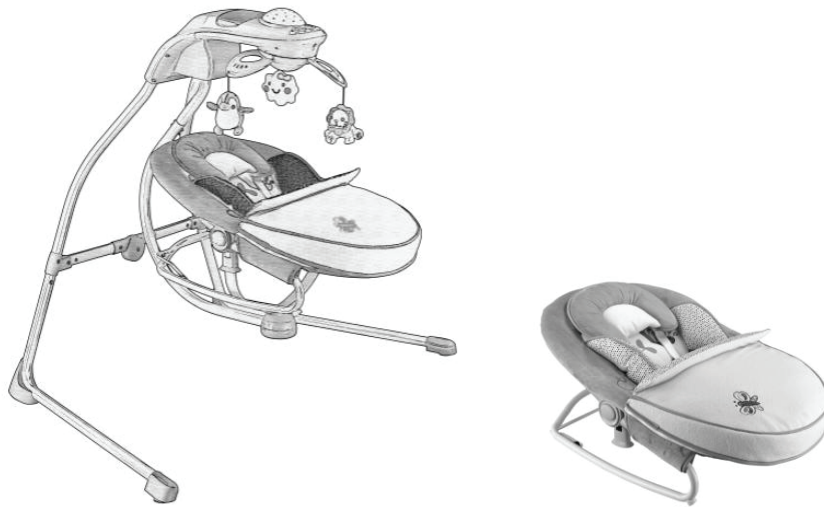

Fig.14

7. 3 reclining positions by the button on the seat assembly for option. (Fig. 15)



Fig.15

8. To use the seat as a Rocker in stationary mode, pull down the shiftable tube at the rear of seat base frame. (Fig.16)



Fig.16

9. Press the button at the back of the frame to fold or extend the product. (Fig.17)

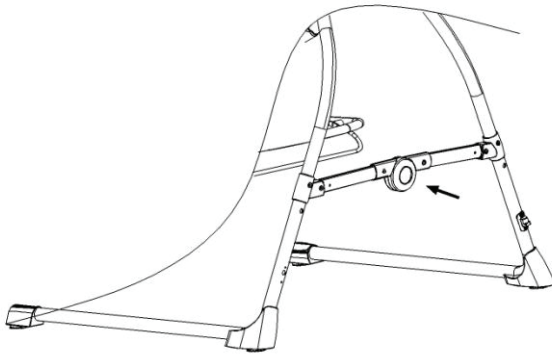

Fig.17

BATTERIES REPLACEMENT

- Battery chamber is located on the bottom of base support front tube / on the top of Rainbow lights.
- Unscrew battery cover with phillips screwdriver. Remove cover and place 4 xLR20 batteries into the battery chamber (fig.12.)
- Rainbow lights - Operation by 3x LR6 (AA) batteries (fig.14.)
- Close the battery chamber and tighten the screw.

ALL ACTIONS ASSOCIATED WITH BATTERY REPLACEMENT MUST BE PERFORMED BY AN ADULT

1. Insert the batteries into the chamber indicated on the packaging or the product itself. In order to insert the batteries to the chamber, unscrew the securing cover and place the batteries in line with the polarity. After the batteries are inserted, screw the cover back on.
2. In order to take the batteries out, unscrew the securing cover, remove the batteries and close the cover again.
3. Batteries which are not suited for charging are not to be charged.
4. Chargeable batteries can be charged under adult supervision.
5. Chargeable batteries should be removed from the product before charging.
6. Batteries should be inserted maintaining proper polarity.
7. Do not mix together different types of batteries or new and used batteries.
8. Only use batteries of a recommended type or equivalents.
9. Depleted batteries should be immediately removed from the product.
10. Do not short circuit the battery clamps.
11. The product uses replaceable batteries.
12. The product cannot be connected to more power sources than recommended.
13. Used batteries should be thrown into specially marked containers intended to collect used batteries and used electronic equipment.



CLEANING AND MAINTENANCE

- Keep the product in dry places. In order to keep the product attractive - avoid prolonged sun exposure.
- Check condition of the bouncer regularly. Before each use check if it is assembled regularly.
- Use only parts recommended and provided by manufacturer.
- Clean the bouncer regularly.
- In order to clean plastic parts and tubes - use damp cloth.
- Padding can be hand washed with a bit of delicate soap. Do not bleach!
- Fabric of the seat pad can be cleaned with a damp cloth.

WARRANTY AGAINST DEFECTS

All Love N Care products are guaranteed for twelve months from the date of purchase. Our goods come with guarantees that cannot be excluded under the Australian Consumer Law.

You are entitled to a replacement or refund for a major failure and for compensation for any other reasonably foreseeable loss or damage.

You are also entitled to have the goods repaired or replaced if the goods fail to be of acceptable quality and the failure does not amount to a major failure.

This covers against faults which develop through faulty materials and workmanship.

Misuse, accidental damages, normal wear and tear or neglect are not covered.

If a fault becomes apparent, please return the item to the store of purchase with your receipt. You must inform the store what the defect is. We will then arrange for its repair or it will be assessed for replacement as expediently as possible.

The benefits of this warranty are in addition to other right and remedies under the law in relation to the goods or services to which this warranty relates.

If you are unable to return the item to the store of purchase, you can contact Love N Care on free call 1300 732 599.

Where you send the product directly to the manufacturer then you may be liable for the costs of transportation to and from Love N Care.

Love N Care will meet the reasonable expenses incurred by a consumer in making a warranty claim. You can claim expenses incurred in making a claim by contacting our customer service team on 1300 732 599 or by email at info@lovenecare.com.au

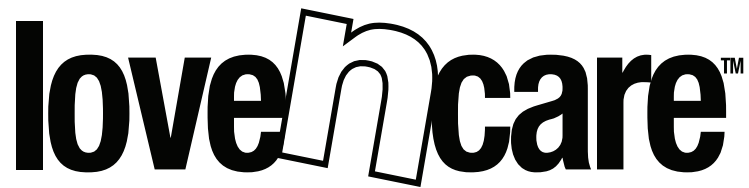

lovencare.com.au

Contact Us

Head Office:
Love N Care Pty Ltd.
297-299 Canterbury Rd, Revesby
NSW 2212 Australia
Contact No: 02 9774 4655
Fax: 02 9774 4633
Email: info@lovencare.com.au
www.lovencare.com.au

let's be friends!

 <http://www.facebook.com/lovencare1>

 http://twitter.com/love_ncare



100 % AUSTRALIAN OWNED SINCE 1984