

Instruction Manual

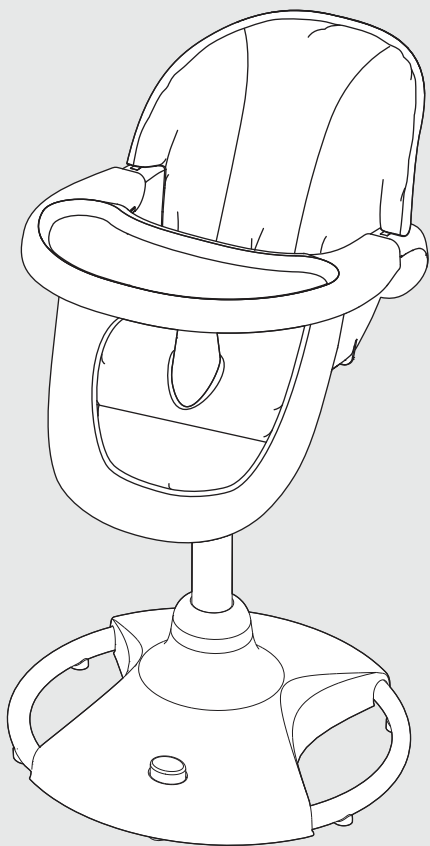

love^hcareTM

"Revolution" High Chair



IMPORTANT: PLEASE KEEP THESE INSTRUCTIONS FOR FUTURE REFERENCE.

WARNING

IMPORTANT: KEEP FOR FUTURE REFERENCE

Read all instructions before assembly and use of product. Make sure high chair is fully assembled and secure before use. Failure to follow these warnings, cautions and the assembly instructions could result in serious injury or death.

WARNING: PREVENT SERIOUS INJURY OR DEATH FROM FALLS OR SLIDING OUT.

- Always secure child in the restraint. Always keep child in view while in high chair. Never leave child unattended.
- The child should be secured in the high chair at all times by the restraining system. The tray is not designed to hold the child in the chair. It is recommended that the high chair be used only by children capable of sitting upright unassisted.
- Never recline seat while child is seated in chair.
- Never use as a car seat, booster or carrier.
- Do not use without main tray securely attached to high chair.
- Only use recline position with infants up to 20 lbs (9 kilos).
- Only use upright position with children up to 50 lbs (23 kilos) who can sit unassisted.
- Do not lift or move with child in high chair.
- Be aware of the risk of open fire and other sources of strong heat, such as electric barfires, gas fires etc. in the vicinity of the high chair.
- Do not use the high chair until the child can sit up unaided
- Do not use the high chair if any part is broken, torn or missing.
- Ensure that the highchair is used on a level stable surface.
- Remove child from highchair before moving, removing or fitting tray, or folding.
- Do not use the high chair without seat pad.
- Do not use the high chair unless all components are correctly fitted and adjusted.

CAUTION:

- Adult assembly required.
- Tool required for assembly: Phillips screwdriver (not included).
- This product contains small parts. Keep small parts out of children's reach during assembly.
- Assembly components may have sharp points and edges. Exercise care when unpacking and assembling product.
- After assembly is complete, properly discard all packaging materials, including notice on tray liner and label near button on base.

Parts list /

Seat Back x1

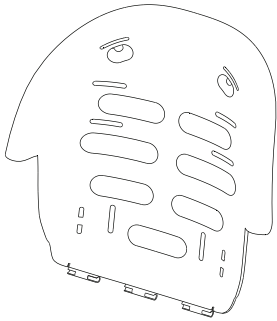

Main Tray x1

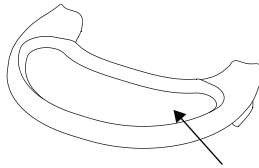

Dishwasher safe Tray x1

Hinge Rod x1



Bolt M6 x5



Base x1

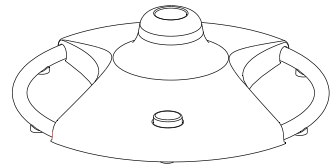

Vertical Leg x1

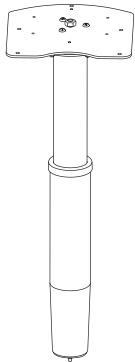

Seat Base x1

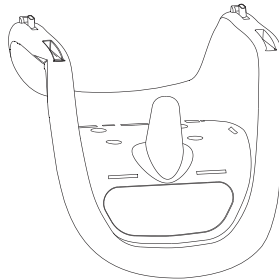

Harness x1

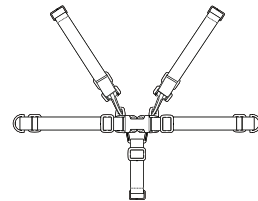

Seat Cover x1

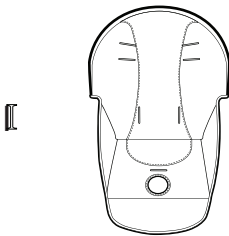

Seat Cover x1

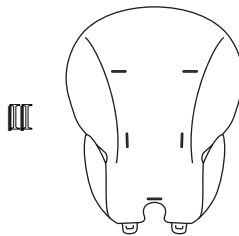

Seat Cover x1

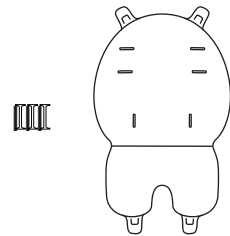

Tool Needed:

1. Phillips Screwdriver (not included)

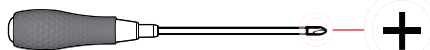

ATTACH VERTICAL LEG TO BASE

Push vertical leg into the hole of base. Ensure the slot and buckle are aligned before inserting. You will hear a “click” when they are secured into place.

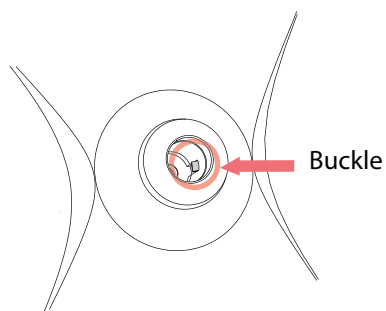
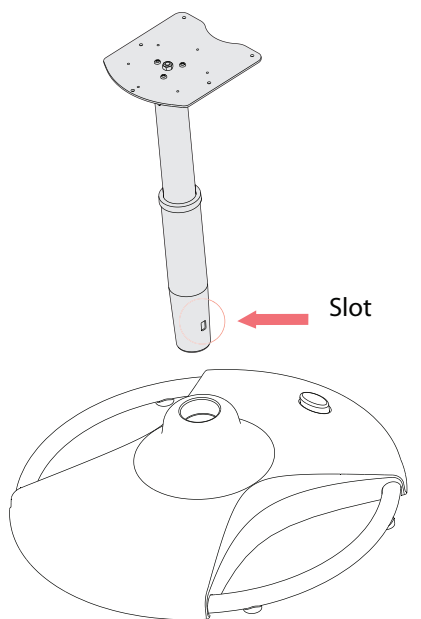

ATTACHING THE SEAT

Raise tube to highest position by stepping the air control button.

Place the seat onto the vertical leg as shown.

Ensure the chair is aligned as in the illustration for correct assembly.

Secure the seat with 5 x M6 bolts with a screw driver.

WARNING:

Do not use the highchair unless all components are correctly fitted.

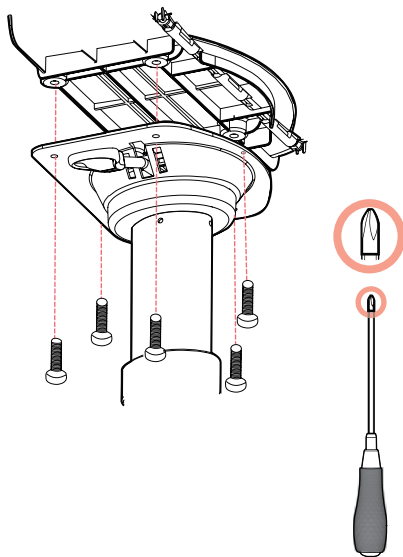
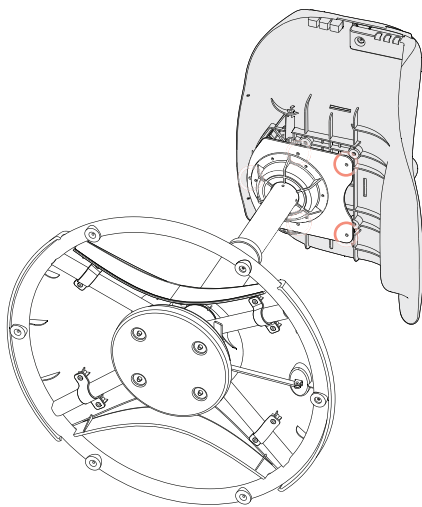

ATTACHING SEAT BACK

1. Insert the seat back into the seat base. Ensure the recline bar is properly inserted in the hole, see diagram A.
2. Ensure the hooks securely locks to the seat base, see diagram B.
3. Insert the hinge rod into the seat back securely through the side of seat base, see diagram C.

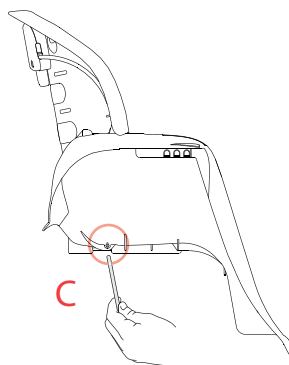
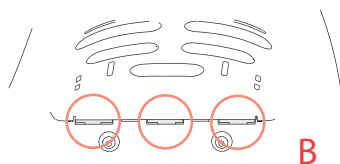
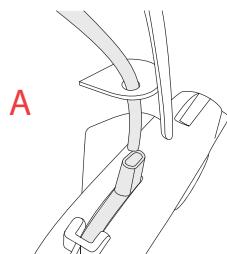
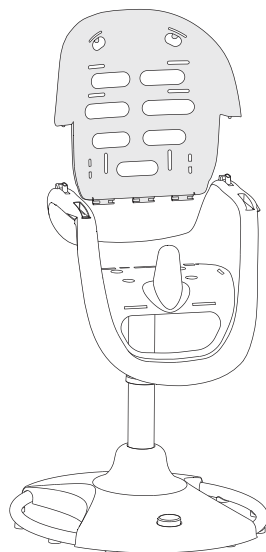

TO RECLINE THE SEAT

To operate, squeeze the recline handle and move the seat until it locks into one of the three positions.

WARNING: Before placing the child into the seat, make sure it is properly secured.

WARNING: Make sure the metal clip is locked into position as shown before use.

WARNING: Never recline seat whilst the child is seated in high chair. Only use recline position with infants up to 9Kg (20 lbs).

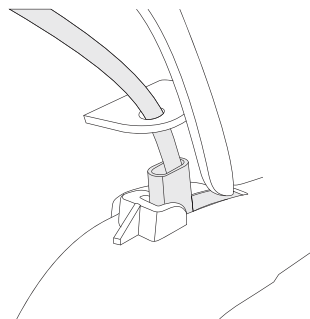
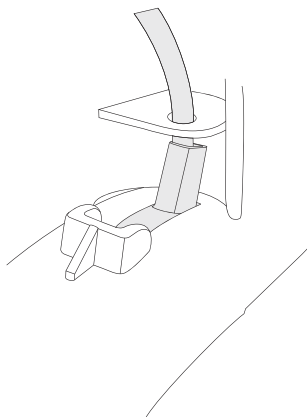
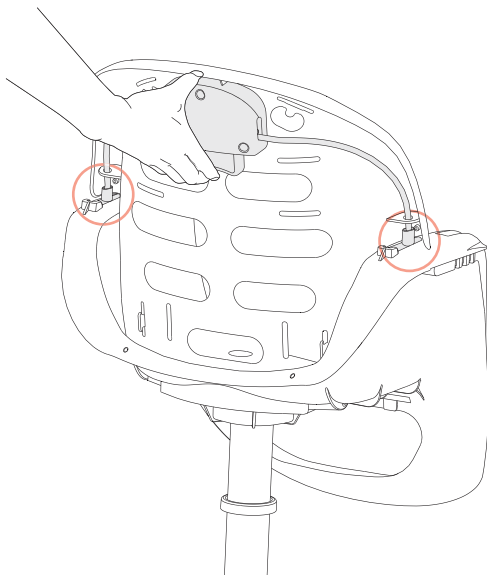

DELUXE SEAT PAD MODELS ONLY

ATTACHING AND USING THE HARNESS

1. Place the seat cover onto the seat unit, see diagram.
2. To fit the harness, first feed the lower harness buckles (**A . B**) through the seat cover. Then, feed the buckles through the slot at the front of the seat, see diagram. Rotate so the buckles cannot come back through the slots.
3. Repeat for the top two buckles (**C . D**).

4. Repeat for the bottom buckles (**E**).
- NOTE:** There are two height options, use the height that best suits your child.

WARNING: Once the harness is in place, ensure the buckles are rotated so they cannot be pulled back through the slots. Check the correct fitting by giving the harness a sharp tug, it should remain in place. A harness must be worn at all times whilst your child is in the highchair.

1

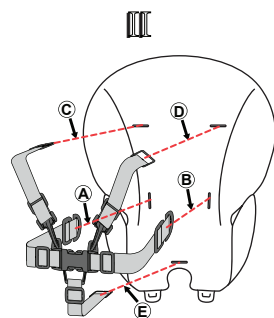
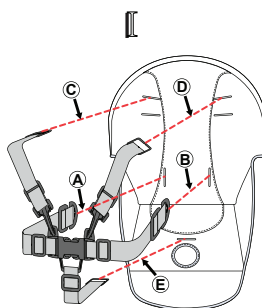

2

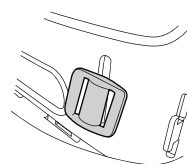
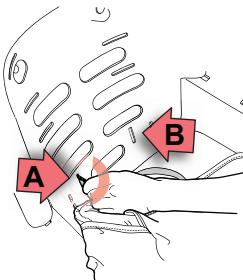

3

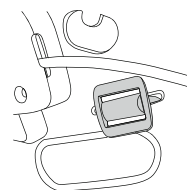
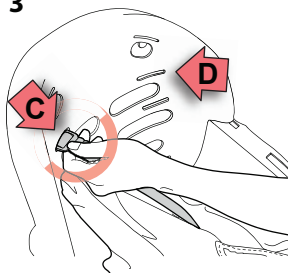

4

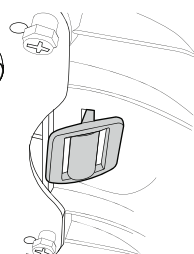
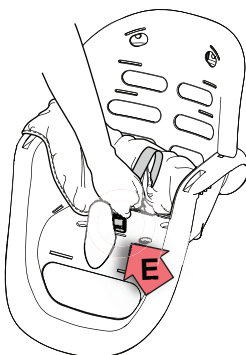

ATTACHING THE SEAT COVER

Place seat cover over the seat and pull down into position. place seat cover over the crotch post as shown.

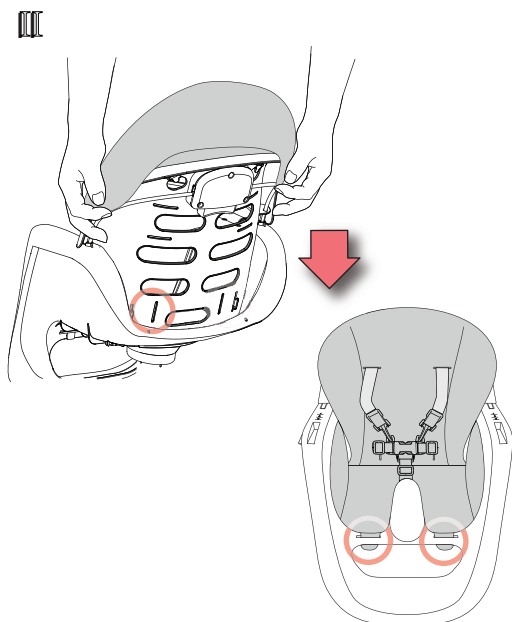
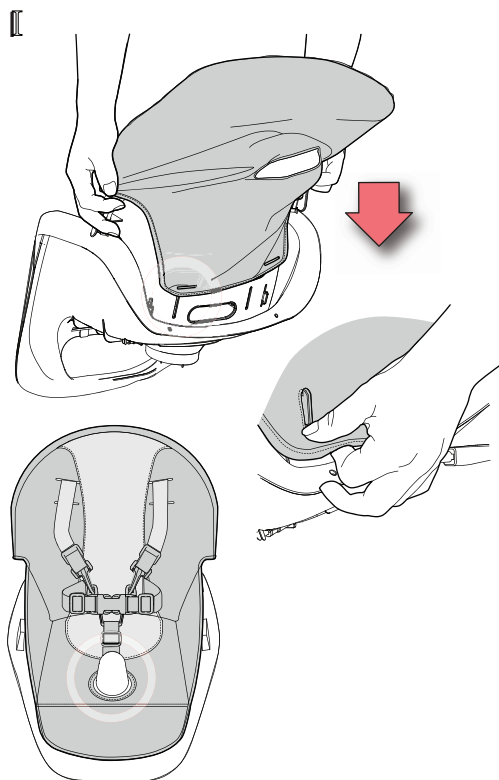

SIMPLE SEAT PAD MODELS ONLY

ATTACHING AND USING THE HARNESS

1. To fit the harness, first feed the lower harness buckles (**A . B**) through the seat cover. Then, feed the buckles through the slot at the front of the seat, see diagram. Rotate so the buckles cannot come back through the slots.
2. Repeat for the top two buckles (**C . D**).
3. Repeat for the bottom buckles (**E**).
4. Position the seat pads' ears into the holes of the seat unit, see diagram.
5. Hook the ears on the plastic tabs on the back of seat unit.

NOTE: There are two height options, use the height that best suits your child.

WARNING: Once the harness is in place, ensure the buckles are rotated so they cannot be pulled back through the slots. Check the correct fitting by giving the harness a sharp tug, it should remain in place. A harness must be worn at all times whilst your child is in the highchair.



1-3

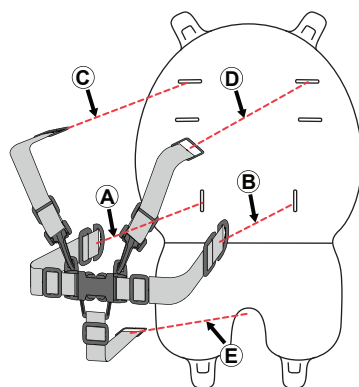

4-5

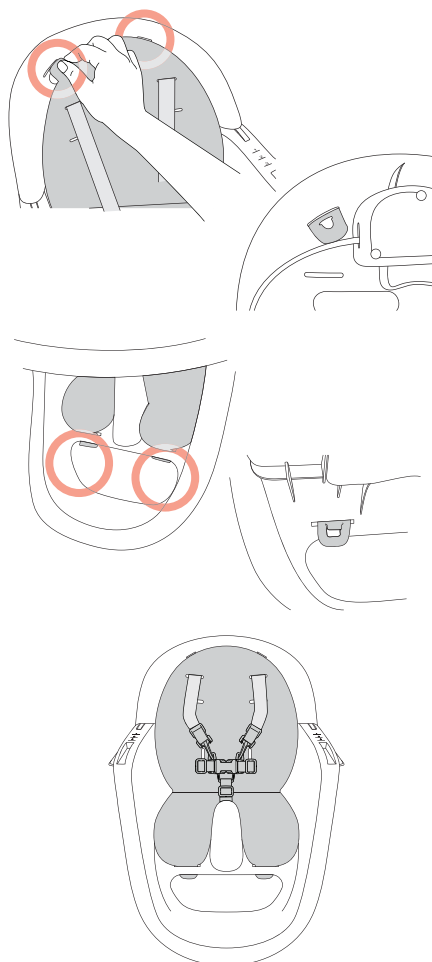

ATTACHING AND USING THE HARNESS

The buckle clips together as shown and are released by pressing (**A & B**) simultaneously.

The harness can be adjusted by buckles (**C, D & E**) to suit your child.

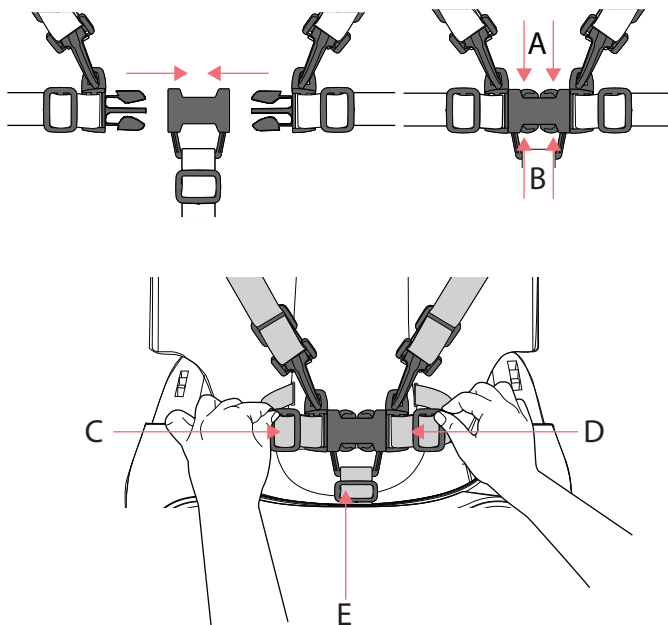

ATTACHING THE DISHWASHER SAFE TRAY

The dishwasher safe tray can be insert or removed by the clip at the rear of the tray .

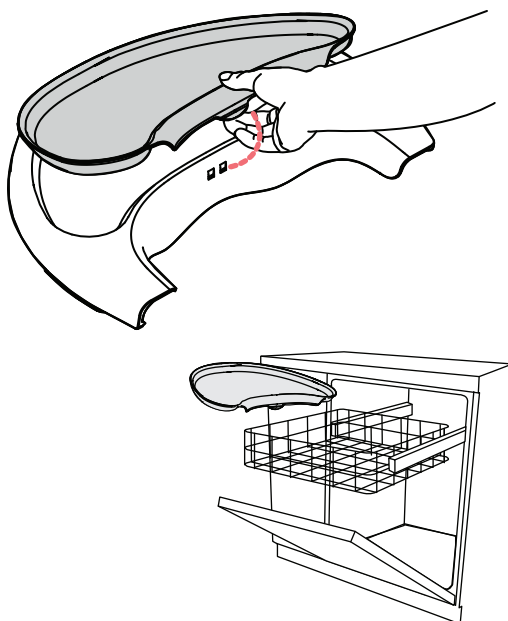

ATTACHING THE TRAY

Attach the tray by sliding it down the tracks on the arm of the chair, pull out the handles simultaneously and lock it into one of the three positions (1, 2 & 3) to best suit your child.

CAUTION: When the tray is in the required position pull it forward to ensure that it is secured.

WARNING: The tray is not designed to hold the child into the chair. The child should be secured in the highchair at all times by the harness.

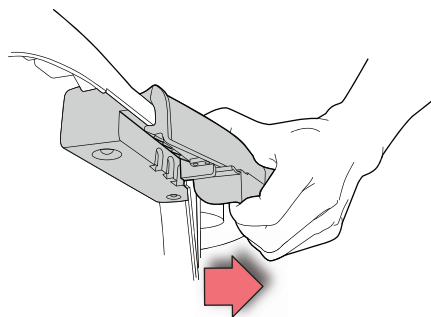
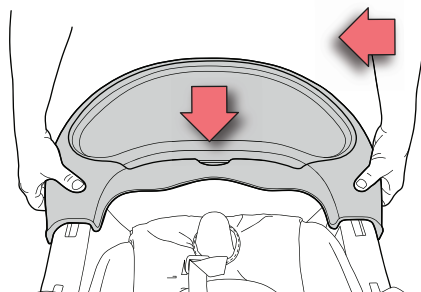
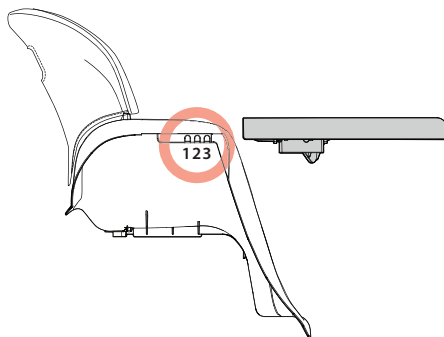

ADJUSTING THE SEAT HEIGHT

1. To raise the seat height:
step on the air control button.
The chair will raise to its
maximum position.
2. To lower the seat height:
While pushing the air control
button, push down on the
seat unit.

CAUTION:

Only press down in the middle of
the seat to avoid the highchair
from tipping.

WARNING:

Never adjust the seat height
when child is in the highchair.

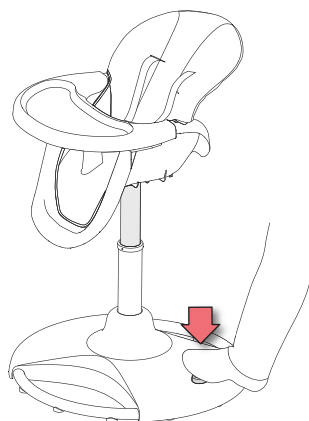
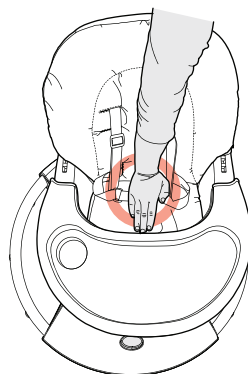
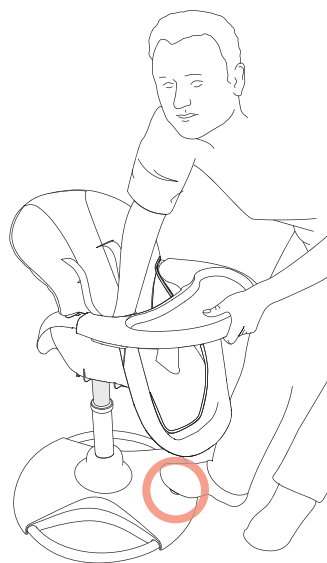

SEAT ORIENTATION

The seat unit can rotate 6 positions.

Twist the seat unit to the required position until it clicks into place.

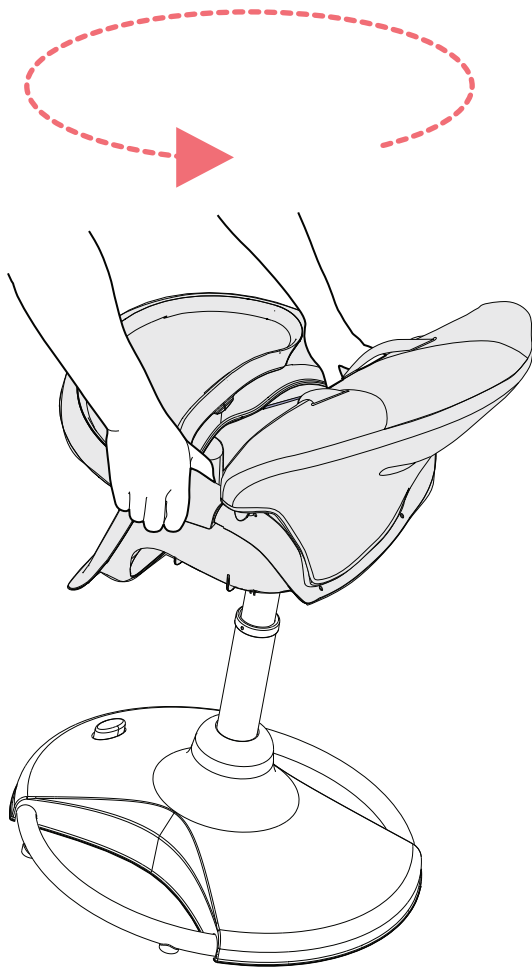
**Care & Maintenance**

- Ensure all locking devices work correctly & regularly check the locks & fittings for security.
- DO NOT use spray lubricants, simply wipe clean after use.



Contact Us:

Love N Care Pty Ltd.

297-299 Canterbury Rd, Revesby

NSW 2212 Australia

Contact No: 02 9774 4655

Fax: 02 9774 4633

Email: info@lovencare.com.au

Website: www.lovencare.com.au