

# lovehncare™

## Snuggles Swing

BP 6618

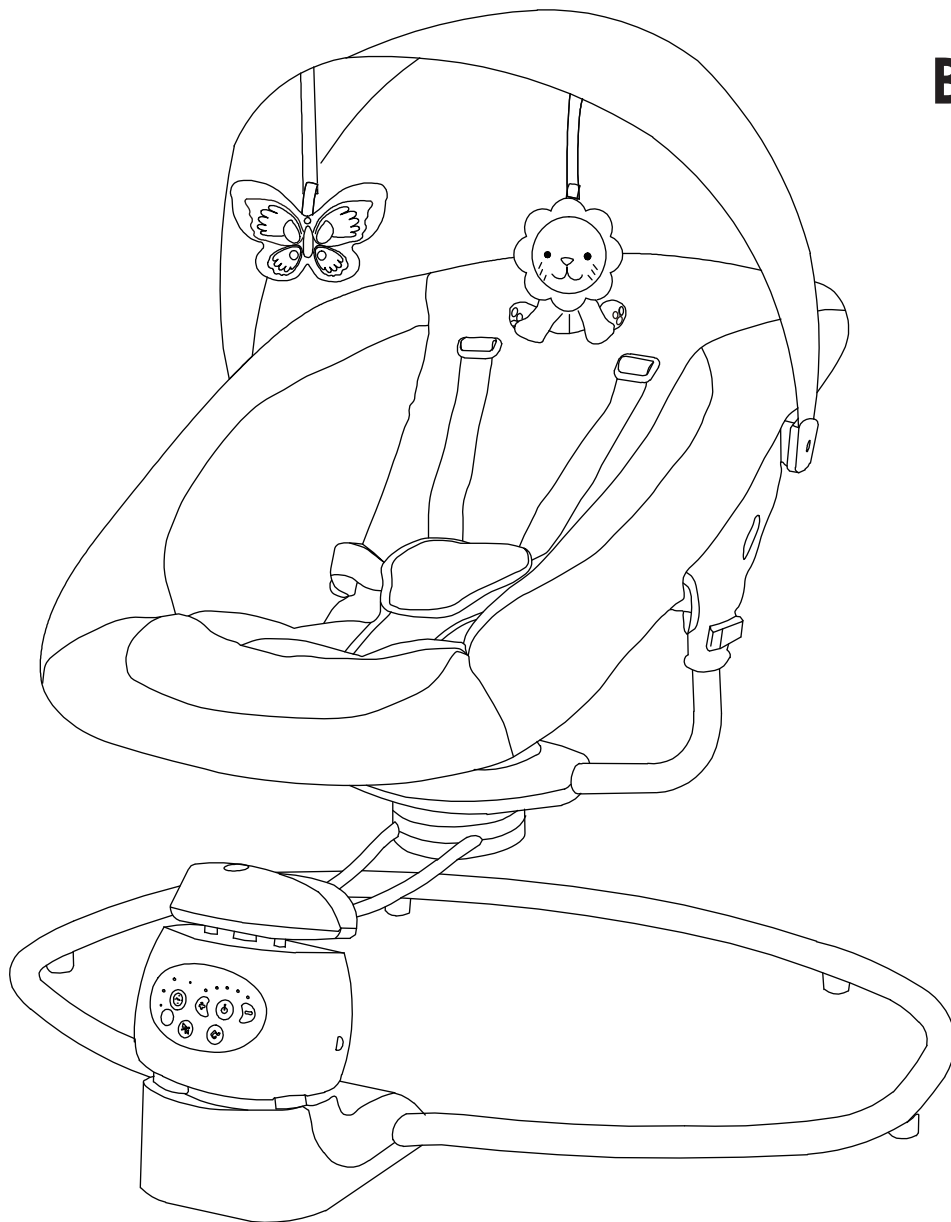

Read all instructions BEFORE assembly and USE of product. KEEP INSTRUCTIONS FOR FUTURE USE.

# Congratulations

Congratulations on purchasing your new Love N Care Swing.

In just a few steps you should be able to assemble this unique product and have it ready to meet your beautiful child :)

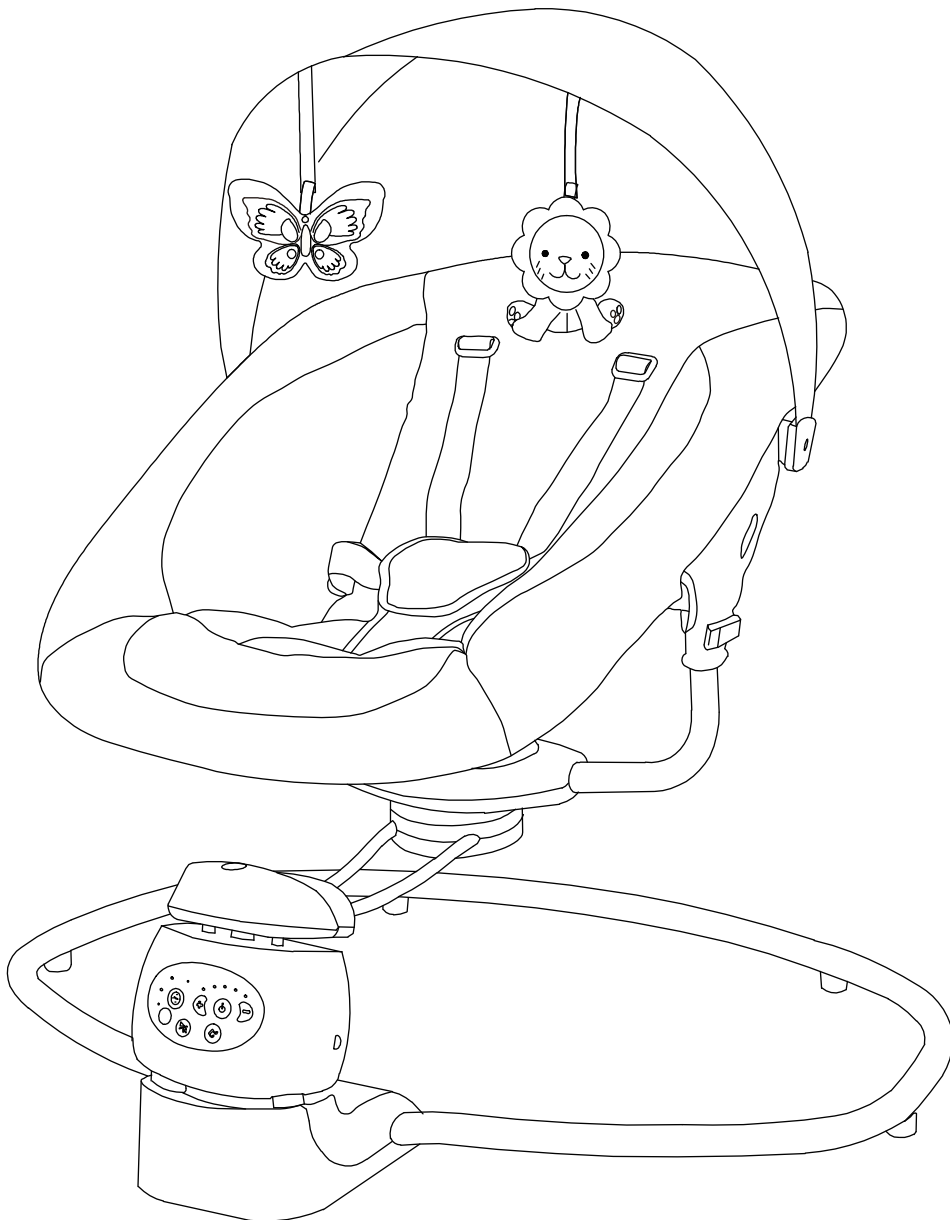

- Please read this instruction manual carefully before using the bouncer and keep it together with packaging for future reference.
- Swinging unit requires 4 x LR20 batteries 1,5 V (not included).
- This bouncer is intended for children weighing up to 9 kgs.
- Actual product may differ from image shown.

# WARNINGS



**WARNING:** Prevent serious injury or death:



**WARNING:** NEVER leave child unattended.



**WARNING:** ALWAYS use restraint system.



**WARNING:** NEVER use for a child able to sit up unassisted.



**FALL HAZARD:** Child's activity may move product.  
Use only on floor. Never use on an elevated surface.



**SUFFOCATION HAZARD:** Never use on a soft surface (bed, sofa, cushion), as seat may tip over and cause suffocation.

**NEVER** place a child under 5 lbs. (2.26 kg) or over 20 lbs. (9 kg) in the product.

- All plastic packaging and elements which are not a part of the bouncer set should be removed before giving it to the child.
- The bouncer must be assembled by an adult only. The product should be checked by an adult before every use.
- The bouncer set includes small parts and should be kept away from babies before it is assembled.
- Never leave the child unattended. Never use for a baby who is able to leave the bouncer on its own.
- Use in reclined position until your child is not able to hold up head unassisted.
- Do not use if your child is able to sit upright unaided or weighs more than 9 kgs.
- Never use on a soft surface (e.g. bed), as bouncer may tip over and cause suffocation.
- Never leave the bouncer on uneven or sloping surfaces.
- Never use this product on an elevated surface e.g. table - it is dangerous. Always use it on the floor.
- This bouncer is not intended for prolonged period of sleeping. It does not replace a bed. Should your child need to sleep, then it should be placed in a bed.
- Always use the restraint system while child is in the bouncer.
- Never lift the bouncer using a toy bar as a handle.
- Never lift or move the bouncer when the baby is inside.
- Never use the bouncer if there are any parts missing or broken. Never use any accessories or replacement parts unless they are ones approved by the manufacturer. Regularly check the condition of the bouncer.
- Keep bouncer away from open fire and other sources of heat.
- If the bouncer is not used for prolonged period of time - remove batteries. After dismantling - keep parts away from babies.

**IMPORTANT!** Small parts are included in the box. Product must be assembled by an adult.

# Parts List

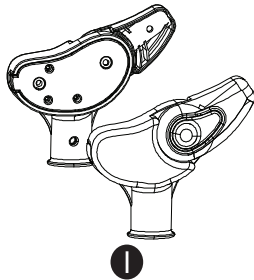
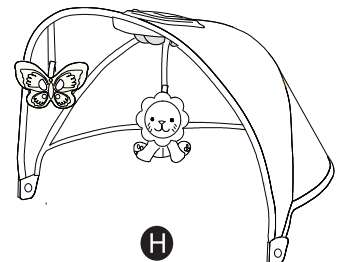
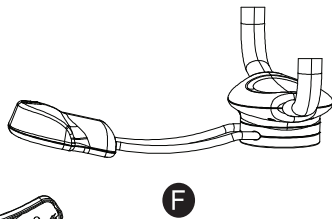
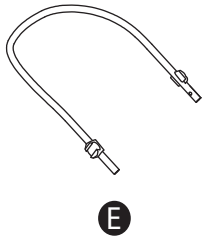
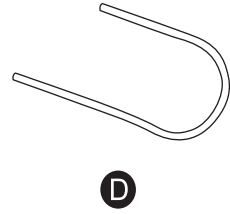
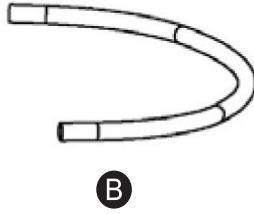
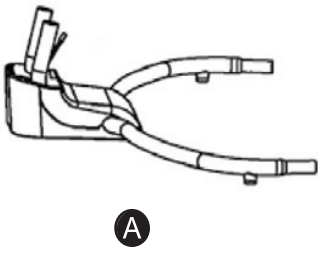

**A** - Base support front tube  
**B** - Base support rear tube  
**C** - Swing control module  
**D** - Seat frame front tube  
**E** - Seat frame backrest tube

**F** - Seat support frame  
**G** - Seat pad with padding  
**H** - Toy bar  
**I** - Adjustable backrest moulding  
**J** - AC adapter (not included - Sold Separately)

- Actual product and Parts may differ from images shown.

Please make sure all parts are included before proceeding to assembly

# Assembly

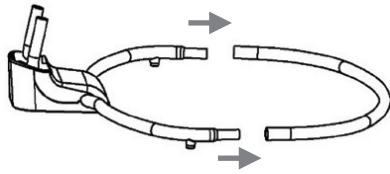

Fig.1.

1) Assemble base support front tube and rear tube (fig.1.). Ensure the pop pins are locked in place so the front and rear tubes are secured.



Fig.2

2) Connect the swing control module wire with the battery compartment wire. Place the swing control module on the base support tube.

**IMPORTANT!** Place extra wire into the wire casing on the base support tube to avoid the wire being crushed after swing control module is in place. Ensure the pop pins are securely locked in place and that the swing control module cannot be separated from the base support tube.



Fig.3.

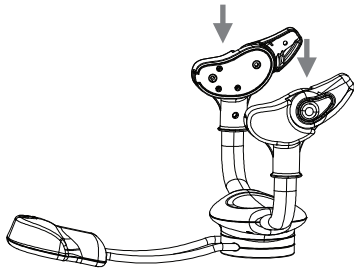

Fig.4.

3) Ensure that the two adjustable backrest supports are attached to the seat support frame. Assembly as shown in fig.4. If not - follow fig.4. to do it. Ensure that it is done properly and that pop pins are locked.

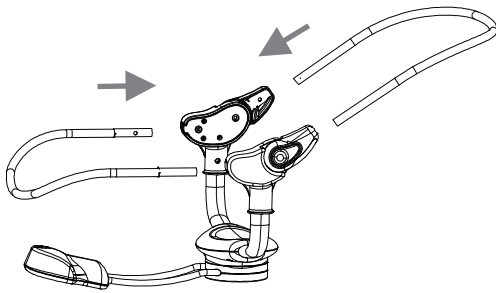

Fig.5.

4) Insert the seat frame front tube and backrest tube into the seat support frame. Ensure that the pop pins are locked.

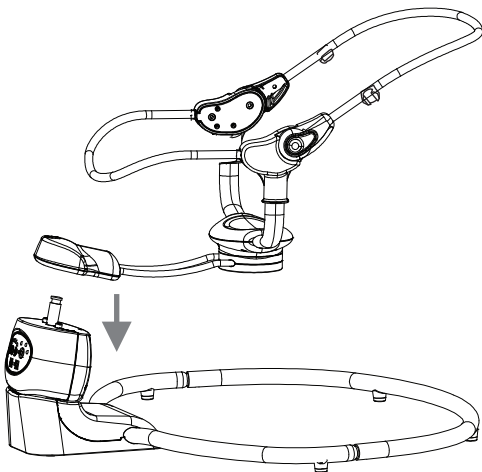

Fig.6.

5) Place the seat support frame assembled in point.4. onto the swing control module (fig.6.).

In order to disconnect swinging module from seat support frame - release grey button (fig.7.) and lift the seat frame at the same time.

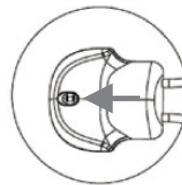

Fig.7.

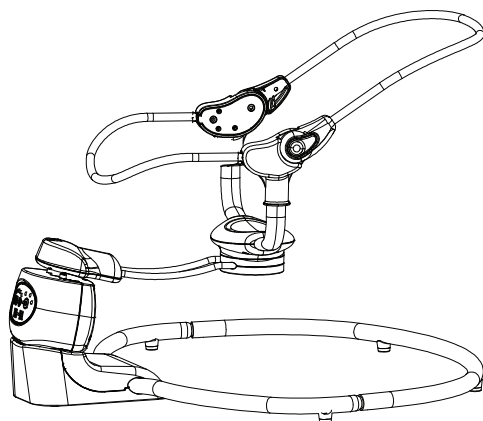
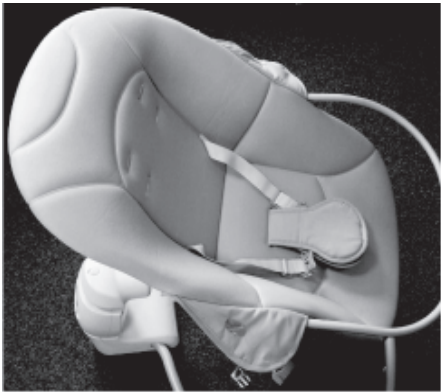

Fig.8.

6) After proper assembly seat frame should look like in the fig.8.

7) In order to mount seat pad, padding and toy bar - follow as shown in pictures as below.



A



B

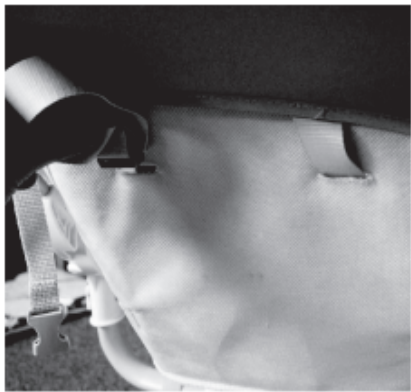

C



D



E



F



G



H



I



J



K



L



M



N



O

## FUNCTIONS

8) In order to adjust the backrest - press simultaneously buttons on both adjustable backrest mouldings and set it in one of 3 possible positions.

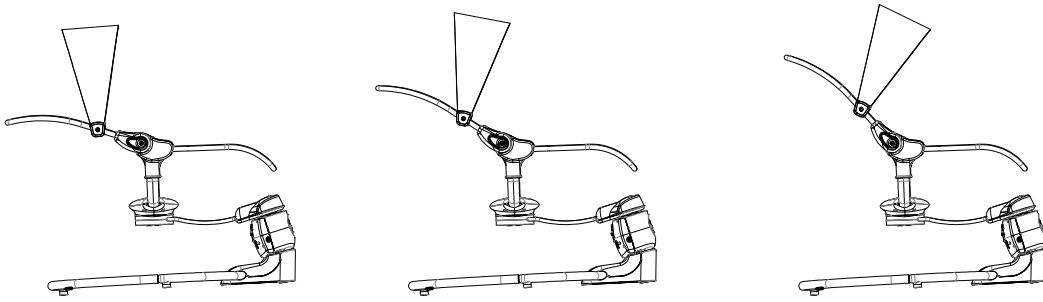

Fig.9.

9) Bouncer can be rotated 360 degrees around bouncer axis.

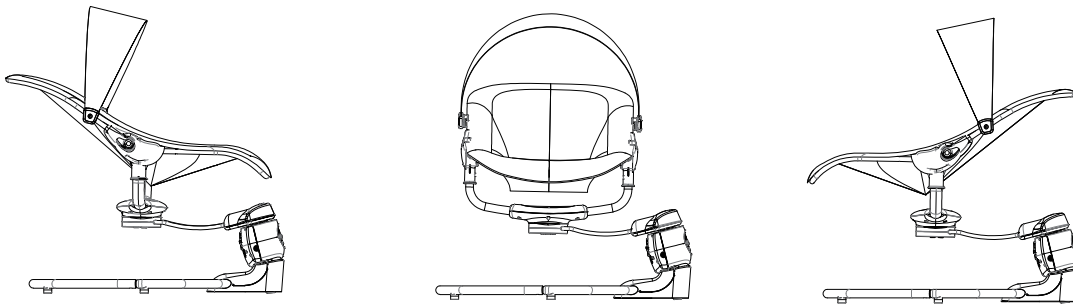

Fig.10.

10) In order to lock swinging possibility of bouncer - set it to the central position and then move slider up (fig.11). Never block swinging when the bouncer is turned ON!



Fig.11.

11) In order to insert safety belts follow figures: **B, H-M** from point 7. Remember to always adjust shoulder and crotch belts after putting baby inside. All buckles must be locked (pictures - **K** and **L** point.7).

## SWINGING UNIT

12) Swinging unit and all functions are described and shown below (fig.13.):

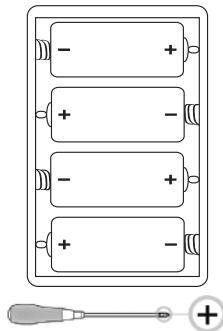

Fig.12.

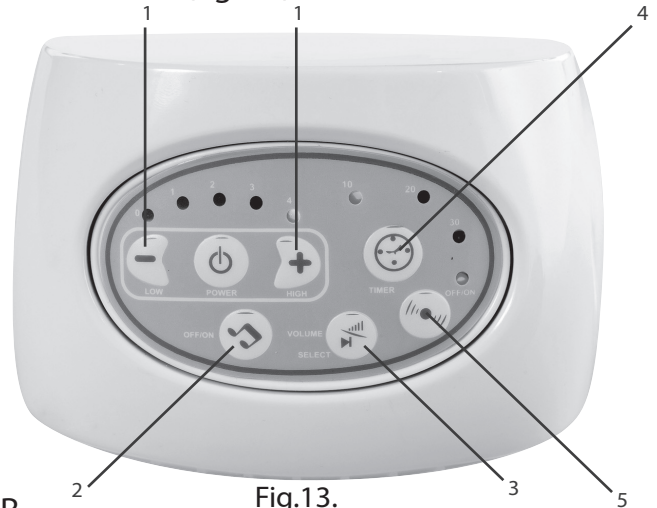

Fig.13.

- In order to turn the bouncer on - press button - POWER.
- Buttons „-“ and „+“ (**1**) are used to control swinging speed of the bouncer. Press „+“ to increase the swinging speed, „-“ to decrease swinging speed. One of 4 speeds can be set. Because of the age of babies - speeds does not differ much. Current speed is indicated by LED light.
- Music button (**2**) can be used to turn the music ON and OFF.
- Music/Volume change button (**3**) can be used to change current music (quick press) or to change the sound volume level (press the button for a longer time).
- Timer is set by pressing button (**4**). It is possible to set one of the 3 possible timers - 10, 20 and 30 mins. Current timer set is indicated by LED light. Deafult set - timer is turned OFF (non of the LED lights shine) after turning ON - bouncer will swing until the power is turned OFF.
- Move detector button (**5**) after turning this function on - bouncer will be automatically start swinging after detecting baby movement. Move detector option is indicated by LED light next to the button.

## RAINBOW LIGHTS

- Push to button (1)- Music on and Rainbow lights switch as the music, OR; No music, Rainbow lights regularly switch for 60 seconds, then off for 30 seconds, and then circularly goes on.
- Push to button (2)- Rainbow lights just turn on, can't be switched, either with music or w/o music.
- Reset to button (1)- Music will be changed.

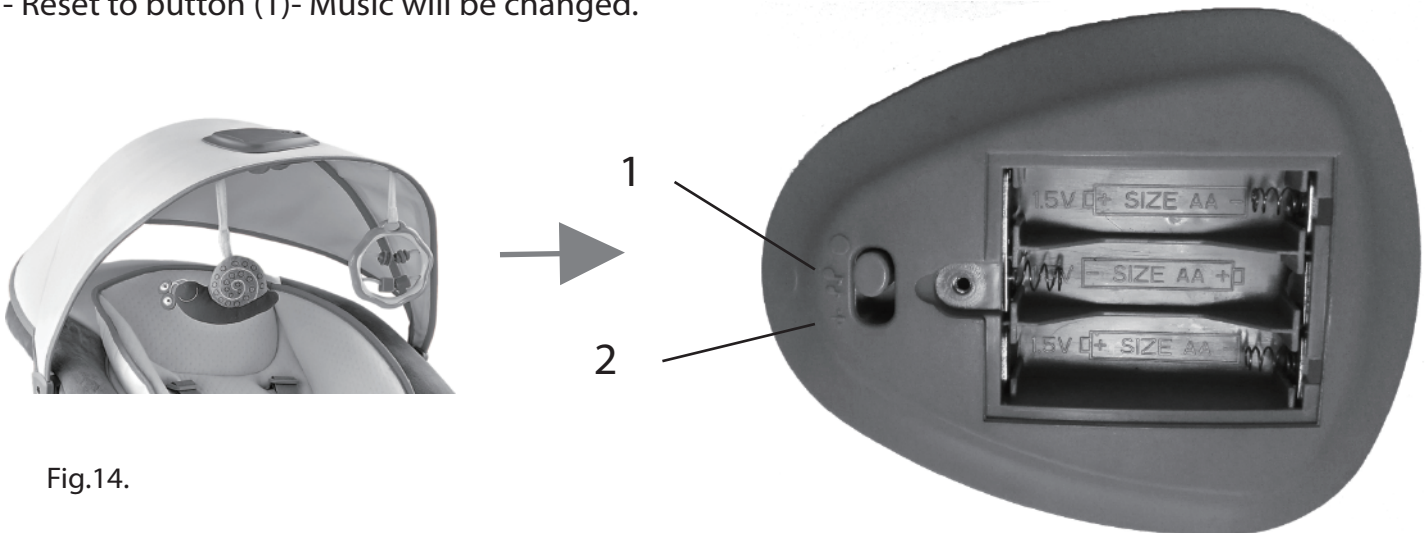

Fig.14.

## BATTERIES REPLACEMENT

- Battery chamber is located on the bottom of base support front tube / on the top of Rainbow lights.
- Unscrew battery cover with phillips screwdriver. Remove cover and place 4 xLR20 batteries into the battery chamber (fig.12.)
- Rainbow lights - Operation by 3x LR6 ( AA ) batteries (flg.14.)
- Close the battery chamber and tighten the screw.

### **ALL ACTIONS ASSOCIATED WITH BATTERY REPLACEMENT MUST BE PERFORMED BY AN ADULT**

1. Insert the batteries into the chamber indicated on the packaging or the product itself. In order to insert the batteries to the chamber, unscrew the securing cover and place the batteries in line with the polarity. After the batteries are inserted, screw the cover back on.
2. In order to take the batteries out, unscrew the securing cover, remove the batteries and close the cover again.
3. Batteries which are not suited for charging are not to be charged.
4. Chargeable batteries can be charged under adult supervision.
5. Chargeable batteries should be removed from the product before charging.
6. Batteries should be inserted maintaining proper polarity.
7. Do not mix together different types of batteries or new and used batteries.
8. Only use batteries of a recommended type or equivalents.
9. Depleted batteries should be immediately removed from the product.
10. Do not short circuit the battery clamps.
11. The product uses replaceable batteries.
12. The product cannot be connected to more power sources than recommended.
13. Used batteries should be thrown into specially marked containers intended to collect used batteries and used electronic equipment.



## CLEANING AND MAINTENANCE

- Keep the product in dry places. In order to keep the product attractive - avoid prolonged sun exposure.
- Check condition of the bouncer regularly. Before each use check if it is assembled regularly.
- Use only parts recommended and provided by manufacturer.
- Clean the bouncer regularly.
- In order to clean plastic parts and tubes - use damp cloth.
- Padding can be hand washed with a bit of delicate soap. Do not bleach!
- Fabric of the seat pad can be cleaned with a damp cloth.

## WARRANTY AGAINST DEFECTS

All Love N Care products are guaranteed for twelve months from the date of purchase. Our goods come with guarantees that cannot be excluded under the Australian Consumer Law.

You are entitled to a replacement or refund for a major failure and for compensation for any other reasonably foreseeable loss or damage.

You are also entitled to have the goods repaired or replaced if the goods fail to be of acceptable quality and the failure does not amount to a major failure.

This covers against faults which develop through faulty materials and workmanship.

Misuse, accidental damages, normal wear and tear or neglect are not covered.

If a fault becomes apparent, please return the item to the store of purchase with your receipt. You must inform the store what the defect is. We will then arrange for its repair or it will be assessed for replacement as expediently as possible.

The benefits of this warranty are in addition to other right and remedies under the law in relation to the goods or services to which this warranty relates.

If you are unable to return the item to the store of purchase, you can contact Love N Care on free call 1300 732 599.

Where you send the product directly to the manufacturer then you may be liable for the costs of transportation to and from Love N Care.

Love N Care will meet the reasonable expenses incurred by a consumer in making a warranty claim. You can claim expenses incurred in making a claim by contacting our customer service team on 1300 732 599 or by email at [info@lovenecare.com.au](mailto:info@lovenecare.com.au)



lovencare.com.au

## Contact Us

Head Office:  
Love N Care Pty Ltd.  
297-299 Canterbury Rd, Revesby  
NSW 2212 Australia  
Contact No: 02 9774 4655  
Fax: 02 9774 4633  
Email: [info@lovencare.com.au](mailto:info@lovencare.com.au)  
[www.lovencare.com.au](http://www.lovencare.com.au)

let's be friends!

 <http://www.facebook.com/lovencare1>

 [http://twitter.com/love\\_ncare](http://twitter.com/love_ncare)



**100 % AUSTRALIAN OWNED SINCE 1984**