



# Instruction Manual

PLEASE KEEP INSTRUCTIONS FOR FUTURE REFERENCE



Congratulations on purchasing your  
new Love N Care Stroller

In under an hour you should be able  
to have this one of kind stroller ready  
to meet your beautiful child :)





SAFETY GUIDELINES AND INSTRUCTIONS MUST ALWAYS BE FOLLOWED BEFORE MAKING USE OF THIS PRODUCT. PLEASE RETAIN THESE INSTRUCTIONS FOR FUTURE REFERENCE.

THIS PRODUCT COMPLIES WITH PRODUCT SAFETY STANDARD AS/NZS 2088:2013

## WARNINGS

- Follow the manufacturer's instructions.
- Put on all the brakes whenever you park the stroller.
- Always apply the brakes whenever the stroller is stationary.
- Do not leave children unattended.
- Secure the child in the harness at all times.
- Do not carry extra children or bags on this stroller.
- Do not use this seat with any other models of stroller.
- Do not use this bassinet once the child can sit up unaided.
- Use the seat in the upright once this occurs.
- Make sure children are clear of any moving parts if you adjust stroller, otherwise they may be injured.
- Use the harness at all times.
- When not in use disconnect shoulder straps from the waist strap and/or buckle.
- The harness can form loops which may be a strangulation hazard.
- Never leave a harness connected when not fitted to a child in the stroller.
- To avoid serious injury always use the harness provided to secure the child. ( adjust the straps to suit the size of your child's body)
- It is unsafe to use accessories other than those supplied by vulu.
- Care should be taken if the stroller is to be used on stairs or escalators.
- This stroller should not be used near an open fire or an exposed flame.
- Care should be taken whilst folding and unfolding the stroller to prevent fingers being trapped.
- Ensure your child's fingers, hands and all other body parts are clear from any moving parts when adjusting the seat or handle on your stroller.
- Make sure that the stroller is fully unfolded and locked into position before placing your child inside.
- To avoid the risk of suffocation keep all plastic packaging and materials out of reach of children.
- Strings can cause strangulation! Do not place items with a string around a child's neck, such as hood strings or pacifier cords. Do not suspend strings over a bassinet or cradle or attach strings to toys.
- Always ensure that your child is clear of moving parts before you adjust the position of the backrest or hood.
- The product will become unstable if the manufacturer's recommended load is exceeded.
- This product is not suitable for running or skating.
- Always use the crotch strap in combination with the waist belt.
- Avoid serious injury from falling or sliding out. Always use the harness.
- The seat is suitable for newborns.

# WARNINGS

- Check the safety of the Urban Stroller before each use. Ensure that the seat fabric, the brake and the harness are all working properly, the handlebar is locked and that the seat is fitted correctly to the chassis.
- Take your child out of the stroller when going up or down stairs and around steep or unstable conditions. Also, take extra care when going up or down a curb or other uneven surfaces.

## **SUFFOCATION HAZARD:**

- In gaps between an extra pad and the side of the bassinet.
  - On soft bedding. NEVER add a mattress, pillow, comforter, or padding. Use ONLY the pad provided by manufacturer.
  - To reduce the risk of SIDS, paediatricians recommend healthy infants be placed on their backs to sleep, unless otherwise advised by your physician.
  - The seat is not intended for prolonged periods of sleeping.
- The safety harness should be checked on a regular basis to ensure that the webbing has not become frayed or damaged. In the event of damage, it is recommended that you purchase a new harness.
  - Ensure that your baby is comfortable and does not overheat when using the rain cover. The mesh ventilation panels on the sides of the rain cover are essential to aid the flow of cool air around your baby. The top section should be open or the rain cover removed unless it is raining or very cold.
  - Take note of any hazards when carrying the stroller up or down stairs and always ensure that the child is removed from the stroller before doing so.
  - Never use force. Adjustment and locks should be free and easy to operate.
  - Locking devices must be engaged before use.
  - Ensure the stroller is fully folded and storage latch is engaged before carrying.
  - The vehicle is designed for use on flat or gently sloping surfaces and may be unstable on higher sloping and uneven surface ; and user should be made aware of the possibility of the vehicle tipping over. Illustrations or diagrams may be used to demonstrate the hazard.

**WHEN USED IN SEAT POSITION MAX WEIGHT IS : 18KG**

**MAXIMUM WEIGHT FOR BASKET: 4.5KGS**

\*PICTURES USED IN THIS MANUAL ARE FOR ILLUSTRATIVE PURPOSES ONLY. THE ACTUAL STROLLER MAY VARY.

# WARNINGS



Avoid serious injury from falling or sliding out.  
Always use seat belt.



Never leave child unattended.



**DO NOT LIFT AND CARRY**  
the stroller while open with a child in it. The  
stroller may slip or the guardrail may come off.



Do not use the stroller on steep slopes, stairs,  
escalator, beaches, rough roads, mud etc.



Never carry more than one child in the stroller.  
Do not allow a child to ride or sit on areas of  
stroller other than the seat.  
**Maximum weight of child: 40lbs (18kg)**



Do not allow your child to stand in or on the  
stroller.



Do not put or hang things on the canopy or  
handle because it could cause the stroller to  
become unbalanced and tip over.



Always engage the brakes when parking the  
stroller.

## **WARNING**

Do not load more than 10lbs(4.5kg) in the ba-  
sket.

Excessive weight in basket (or items placed  
in basket which overflow the top or sides of  
basket) may cause a hazardous condition to  
exist.

Make sure that all locking mechanisms properly  
before using stroller are engaged.

Avoid scissoring baby's hand, Keep his hand away  
from the moving area of handle. After reversing the  
handle, Check the handle is fixed into position.

# CARE AND MAINTENANCE

## maintenance

All Love N Care products have one year warranty from the date of purchase.

After a few months of using your stroller it may get a bit dirty from usage.

These tips will help you take care of your Love N Care Stroller and keep it running smoothly.

- Clean the frame with a soft towel and lukewarm water and wipe water with a dry cloth.
- Use a soft brush to clean sand and dirt from the mechanisms. any sliding joints.
- Use a sponge, warm water and liquid soap to gently rub off and clean any soap residue left on the handlebar.
- Use a brush and water to clean dirt on the wheels. Periodical frame and brush off any dirt or sand in the inside axle of the wheel.
- Store your stroller and its accessories in a dry place and prevent mould.

## WARRANTY AGAINST DEFECTS

All love n care/Vulu products are guaranteed for twelve months from the date of purchase.

Our goods come with guarantees that cannot be excluded under the Australian consumer law.

You are entitled to a replacement or refund for a major failure and for compensation for any other reasonably foreseeable loss or damage. You are also entitled to have the goods repaired or replaced relates.

If the goods fail to be of acceptable quality and the failure does not amount to a major failure. This covers against faults which develop through faulty materials and workmanship. Misuse, accidental damages, normal wear and tear or neglect are not covered.

If a fault becomes apparent, please return the item to the store of purchase with your receipt. You must inform the store what the defect is. We will then arrange for its repair or it will be assessed for replacement as expediently as possible. The benefits of this warranty are in addition to other rights and remedies under the law in relation to the goods and services to which this warranty

If you are unable to return the item to the store of purchase, you can contact love n care on freecall 1300732599. We will then organise for either somebody to inspect the item or arrange for a courier to pick it up and return it back to you.

For more information please contact:

**love<sup>n</sup>care™**

Love N Care Pty Ltd

Email: [info@lovencare.com.au](mailto:info@lovencare.com.au)

Web: [www.lovencare.com.au](http://www.lovencare.com.au)

Phone: 1300 732 599

Fax: 02 9774 4633

# in the box

Please take a minute to check the contents of your package.  
If something is missing, please contact your retailer.

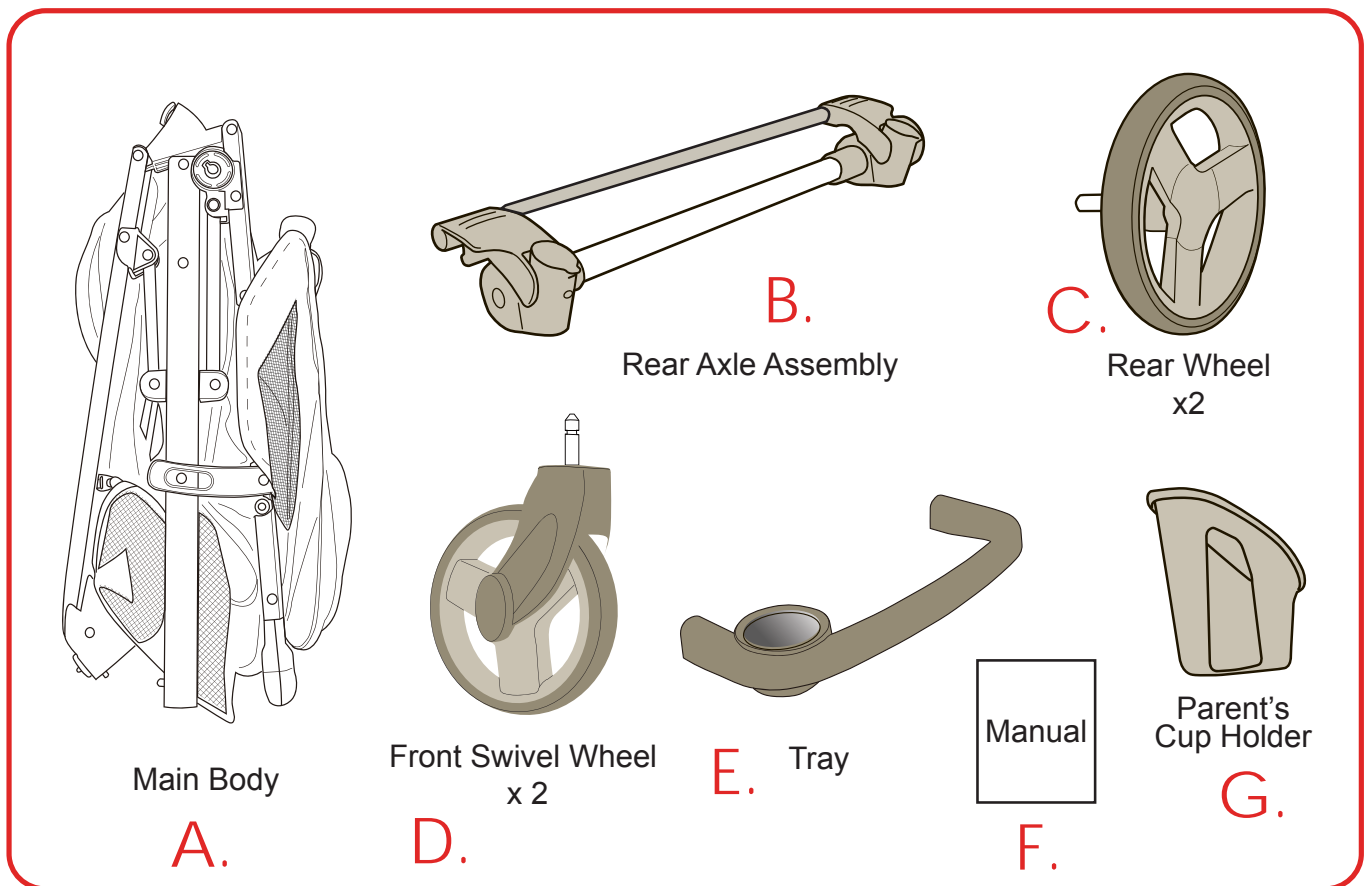

## PARTS LIST

- A. MAIN BODY
- B. REAR AXLE
- C. 2x REAR WHEEL
- D. 2x FRONT SWIVEL WHEEL
- E. FRONT TRAY
- F. INSTRUCTION MANUAL
- G. CUP HOLDER



# PARTS LIST

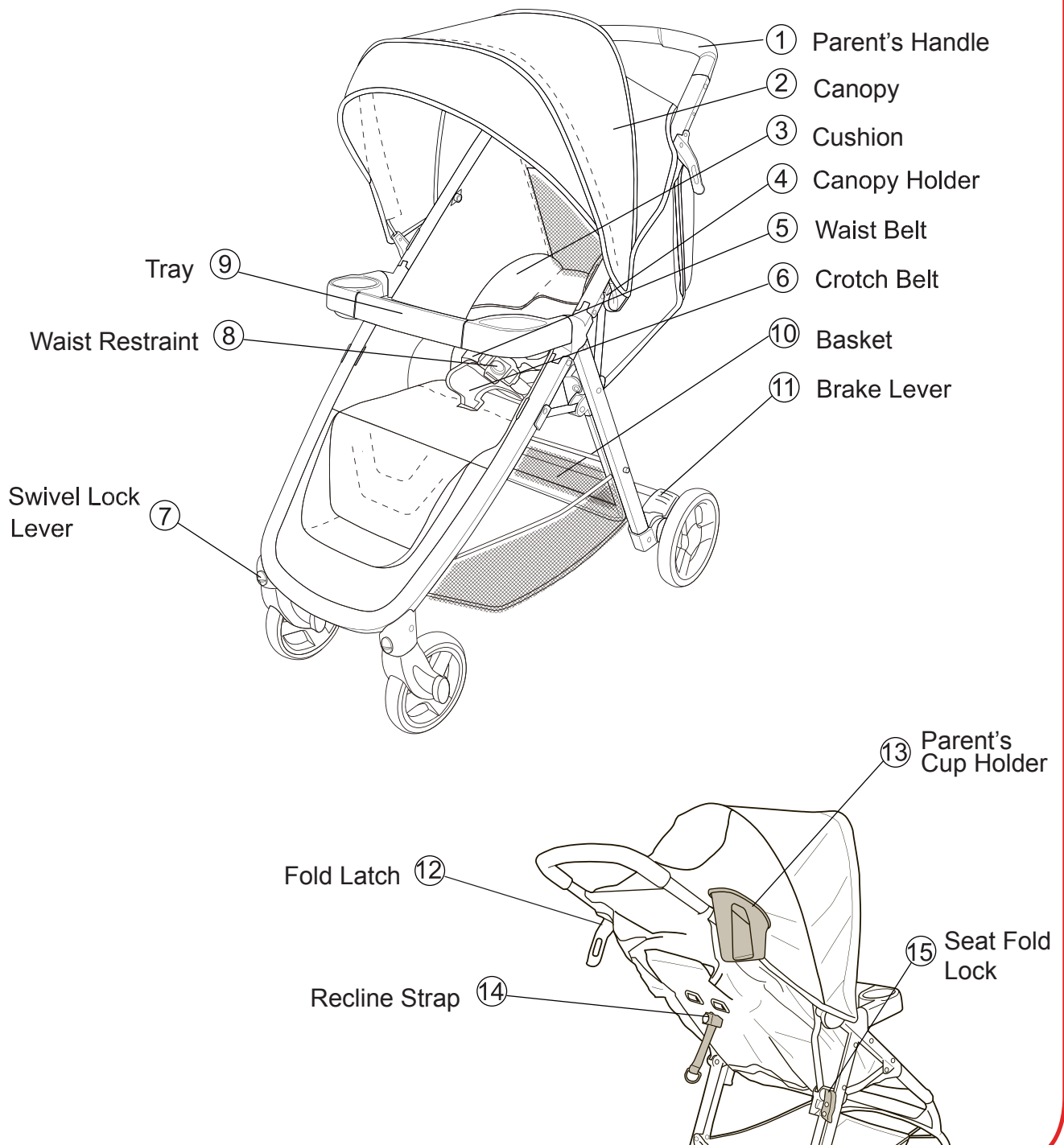



# ASSEMBLING THE STROLLER

## 1 Opening The Stroller

Unlock the fold latch **A**.

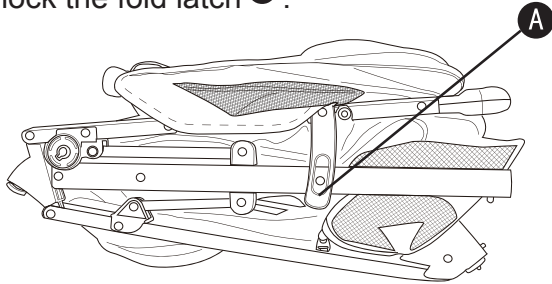

Grab the parent's handle **B** and pull upward until the stroller opens fully with an audible click. Make sure the stroller locks in the open position.

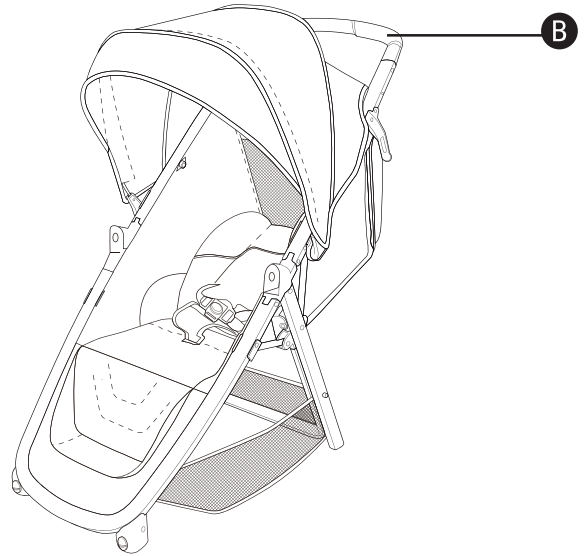

**WARNING** Lift and shake the stroller to make sure it is locked completely.

## 2 Front Wheels Assembly

Slide a front wheel assembly **C** into the front frame leg **D** until it locks into place with an audible click. Repeat for other side.

**CAUTION** To remove swivel wheels, press locking tab and slide the wheel off the leg.

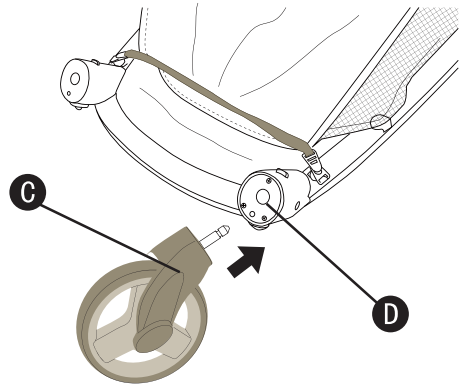

## 3 Rear Wheels Assembly

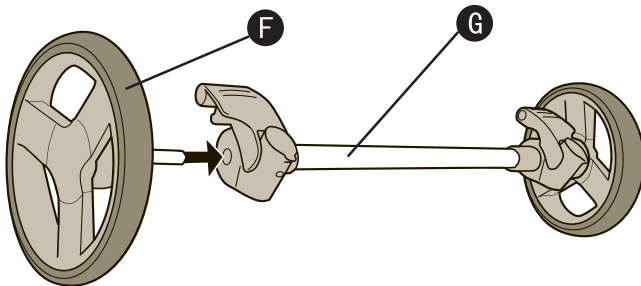

Install the rear wheels **F** on the rear axle assembly **G**. Make sure each wheel locks into position with an audible click. Pull the rear wheels to make sure they are locked securely.

Turn the stroller upside down.

Hold the rear wheel/axle assembly **G** so the brake levers **E** face toward the parent's handle **B**. Slide the rear wheel/axle assembly onto the stroller frame **H** until each side locks into place with audible clicks.

Pull upward on the rear wheel/axle assembly to make sure it is locked securely.

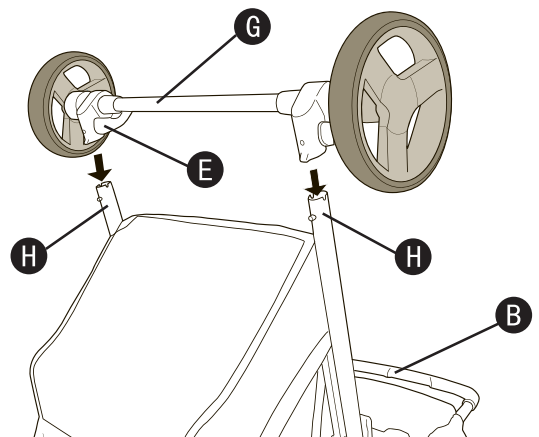

## 4 Attaching the Tray

Install the child's tray **I** onto the tray mounts **J**. Make sure the tray locks into position with audible clicks. Pull on the child's tray to make sure it is locked into place.



### CAUTION

Pull on each side of the tray to make sure it is completely attached.

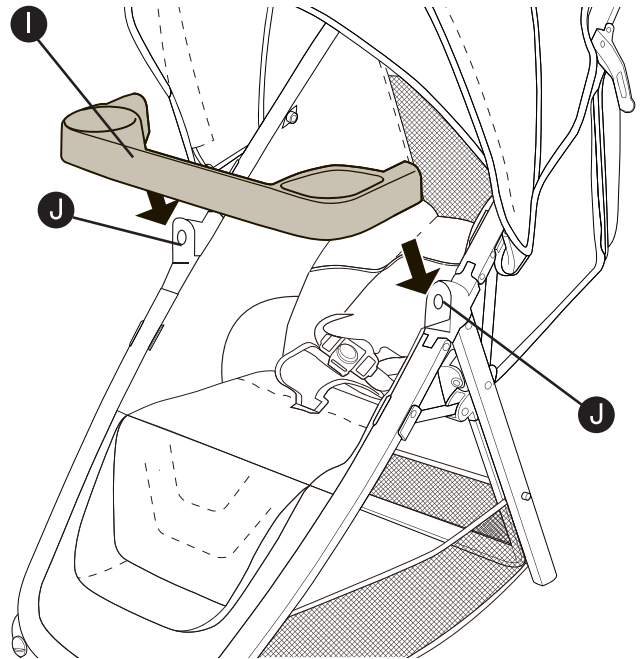

## 5 Attaching the Canopy

Install a canopy pivot **K** into each canopy mount **L** until it locks into place. Pull upward on the canopy to make sure it is securely installed.

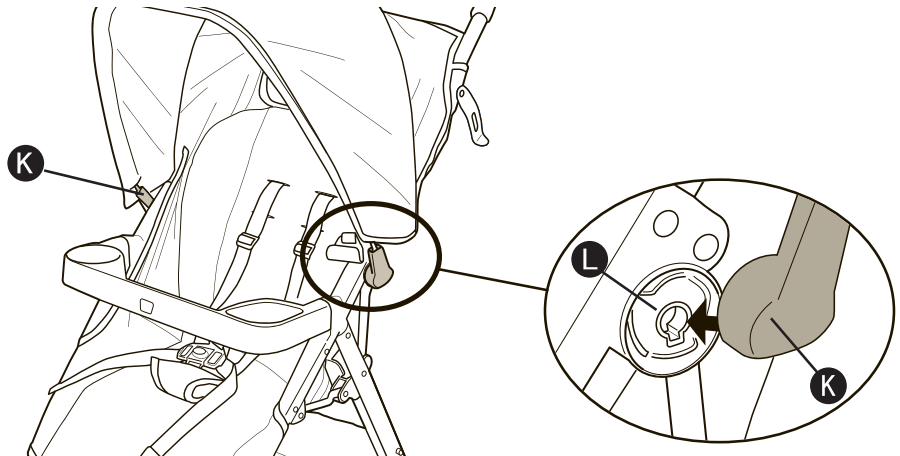

**WARNING** The canopy is not intended to provide UV protection.

## 6 Attaching the Parent's Cup Holder

Slide the parent's cup holder **M** onto the mounting post **N**. Pull up on the cup holder to make sure it locks into position.

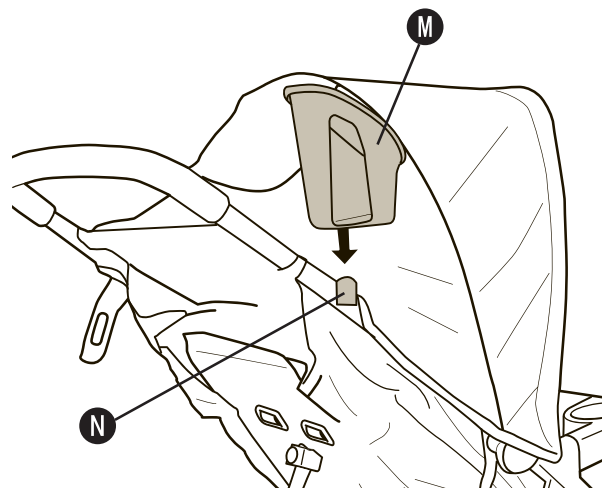

# USING THE STROLLER

## 1 Using the Brakes

Step on the rear brake levers **A** to lock the rear wheels on the stroller.

To release the brakes, lift up on the brake levers.



### CAUTION

Always engage the brakes on the side of handle when parking the stroller. Push the stroller forward to ensure that the brakes are properly engaged.

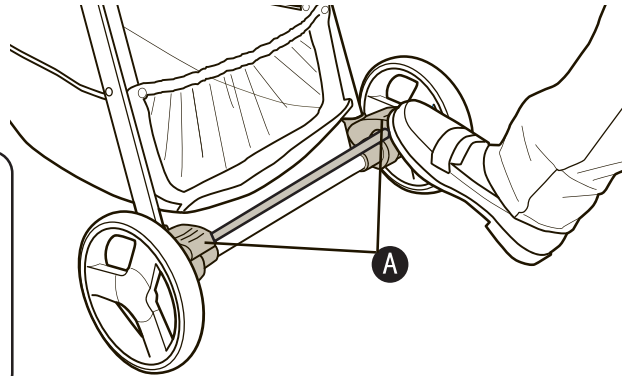

## 2 Using the Swivel Wheels

Some models feature swivel locks that improve handling over rough ground.

To keep wheels from swiveling, step down on the swivel lock levers **B**.

Flip up the swivel locks to restore the swivel action.

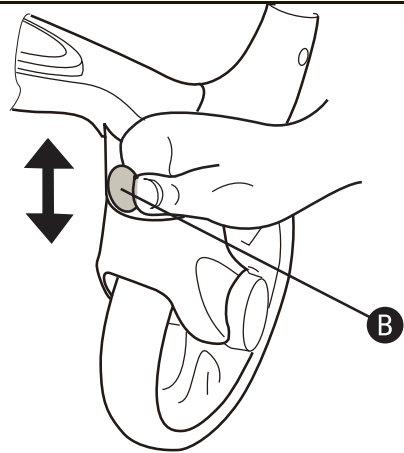

## 3 Using the Child's Tray

To open the child's tray **C**, pull a locking tab **D** on either side of the tray.



### CAUTION

You can open the tray from either side.

To remove the tray **C**, pull both tabs and remove the tray from the stroller.

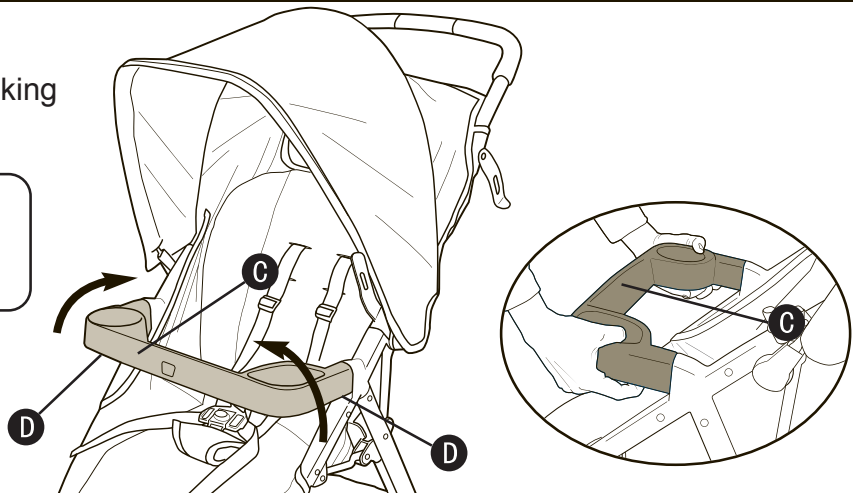

## 4 Using the Reclining Backrest

To recline seat, press the strap release button on the adjuster **E** and allow seat to recline.

To raise the seat, hold the D-ring **F**, then press the release button and slide the adjuster **E** toward the seat.



### WARNING

To avoid serious injury, DO NOT raise or recline seat with child in stroller.

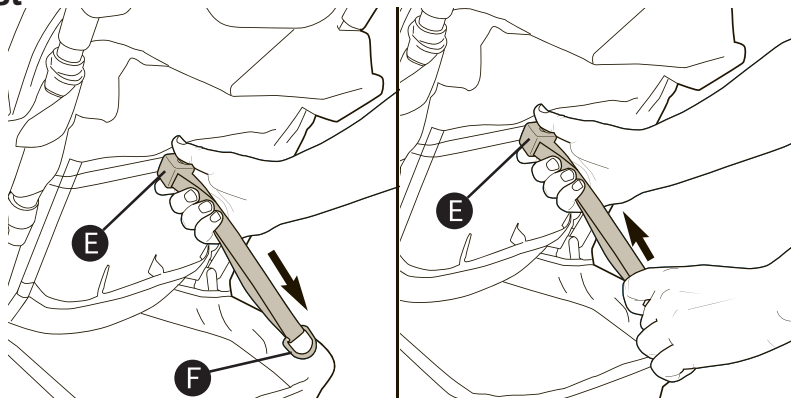

## 5 Adjusting the Seat Belt

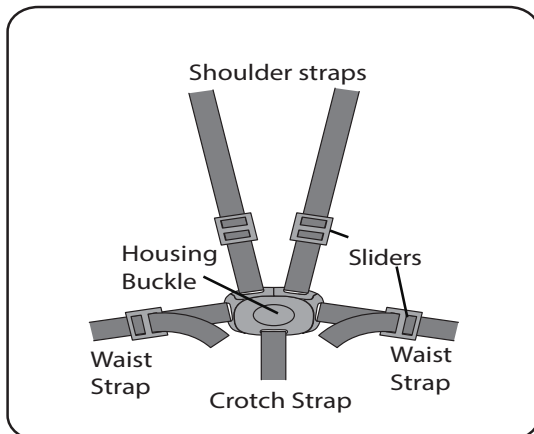

### **WARNING**

**WHEN NOT IN USE DISCONNECT SHOULDER STRAPS FROM THE WAIST STRAP AND/OR BUCKLE**

### **WARNING**

**USE THIS HARNESS AT ALL TIMES**

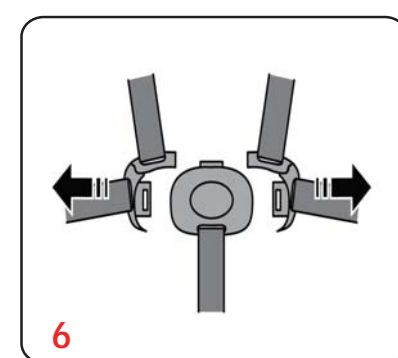
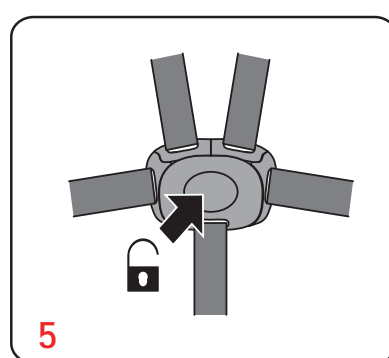
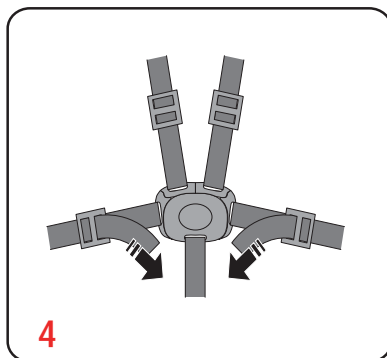
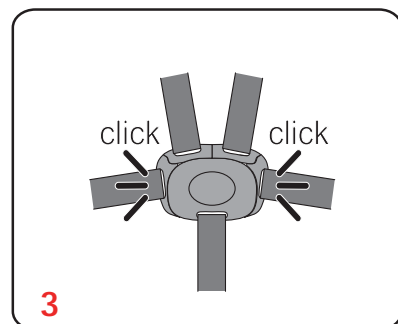
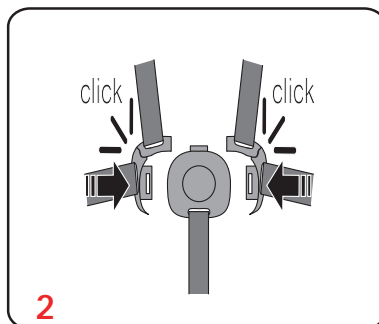
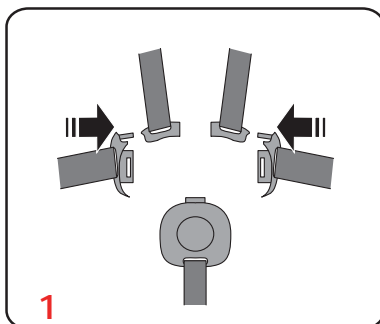

Familiarise yourself with all components of the 5 point harness. Place the child into the stroller seat and place the shoulder straps over the child's shoulders. Adjust the sliders until they are tight enough to keep the child in the seat. Repeat for both shoulder straps. For newborns or smaller children you should use the lower height position on the seat units. You can change the position of the height of the harness by threading the harness through the seat. As the child gets taller you should use the top position.

1. Carefully place your child into the seat and bring the waist straps around the child's waist and over the child's shoulders. Place the crotch strap between your child's legs. Tighten the harness to be snug around the child's waist and over its shoulders.
2. Attach each of the shoulder straps to the waist strap buckle with each end. Repeat this for both sides. The straps should click onto each other.
3. Once each shoulder strap is attached to the waist buckle, insert the waist strap end to the crotch strap buckle. Repeat on both sides.
4. You can then adjust the straps further if required by using the sliders.
5. To release the harness, squeeze the centre of the crotch strap buckle to release all straps.
6. The shoulder straps, waist straps and crotch strap should all come apart.

---

## 6 Using the Canopy

Pull canopy hoop **K** forward to extend canopy.  
Push canopy toward parent's handle to close.

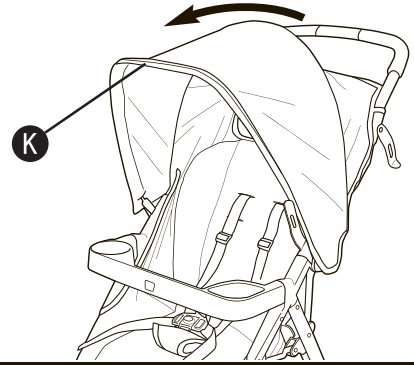

---

## 7 Tear Down the Rear Wheel

Press the rear wheel release button **L** located at the bottom of brake lever **M**, then pull off the wheel from the shaft.

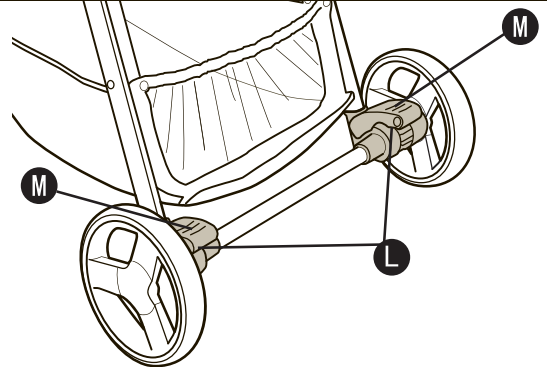

---

## 8 Tear Down the Front Swivel Wheel

Press the release button located **N**. Pull off parts of front wheels **O**. Wheels can be removed.

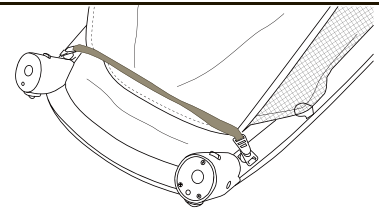

## 9 Folding the Stroller



### WARNING

Care must be taken when folding or unfolding stroller to prevent finger injury in hinge areas.

To fold the stroller, lock the front swivel wheels, lock the rear brakes, close the canopy, and remove your child.

Push the seat fold lock **P** inward while pulling upward on the in-seat fold strap **Q**. Lock the fold latch **R**.

To unfold the stroller, unlock the fold latch **R**, then grab the parent's handle and pull upward until you hear the stroller open fully with an audible click.

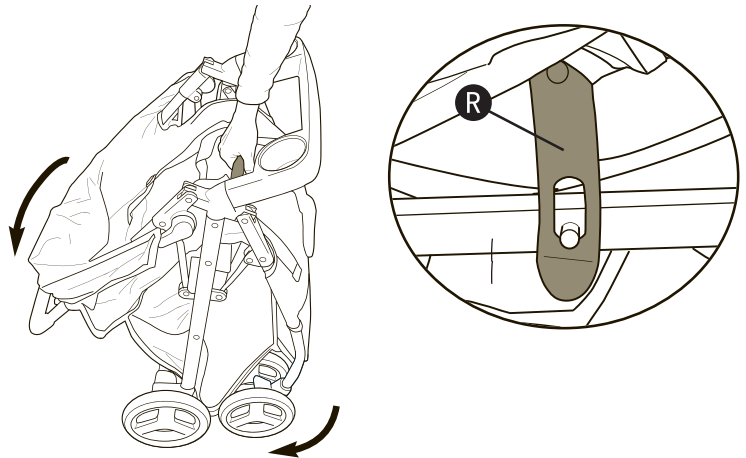
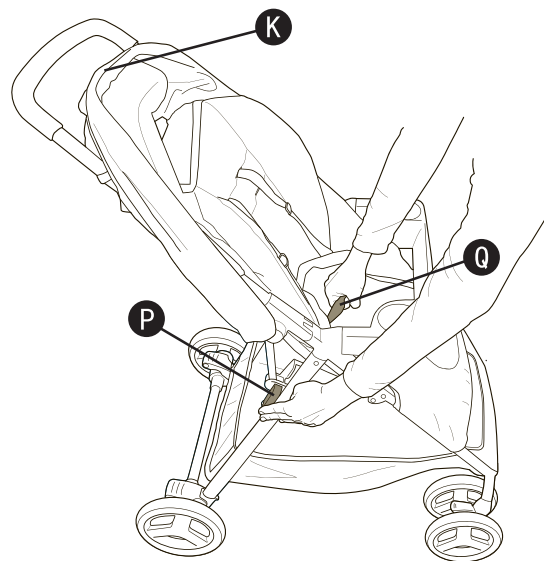

## 10 Removing/Attaching Cushion



### CAUTION

If seat cushion is ripped or torn, do not use.  
Do not use the stroller without the seat cushion.

#### Removing

Unbuckle the 5-point harness and pull all the belts through the seat cushion.

Grasp the seat cushion at the top and unfasten from the velcro.

#### Attaching

Pass the 5-point harness belts through the appropriate locations in the seat cushion.

Fasten the velcro.

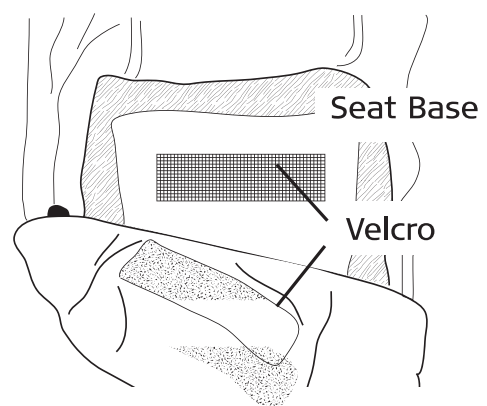



---

## **Trouble Shooting**

- \*Remove any items hanging from the handle. Make sure weight in basket is distributed evenly.
- \*Check that the brakes are not in the locked position.
- \*After prolonged normal use the wheels of your stroller may not swivel as easily as when it was new. This is usually due to build up of dirt in the swivel mechanism. Ensure swivel wheels are clean and free of dirt. If this does not help, please call customer service for further instruction.

### **\* Stroller won't fold**

- \*Make sure the canopy is folded completely and front swivels are locked.
- \*Check to see that the seat belt is not caught in the side.

### **Difficult getting up curbs**

Pulling backward makes going up a curb difficult, and could pose a safety hazard. Pull handle up to lift the rear wheels onto the curb, then pull the stroller backward until the front wheels clear.

Trying to traverse the curb by overweighing on the handle may result in danger such as stroller's damage.

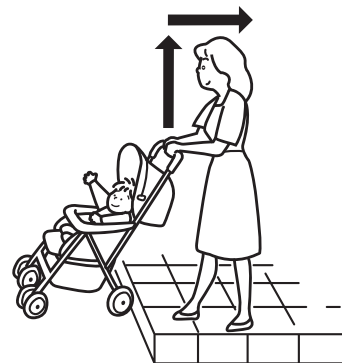
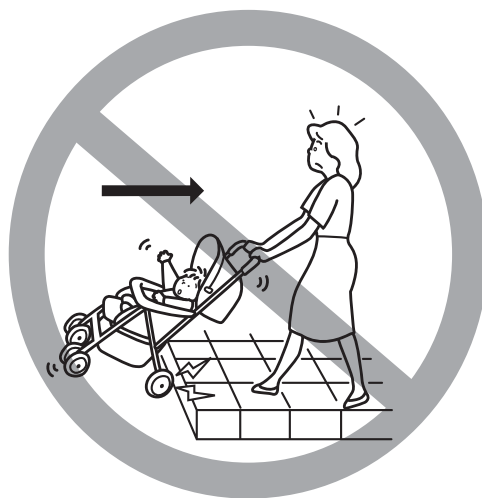





## Contact Us

Head Office:  
Love N Care Pty Ltd.  
297 Canterbury Rd  
Revesby NSW 2212  
Contact No: 02 9774 4655  
Fax: 02 9774 4633  
Email: [info@lovencare.com.au](mailto:info@lovencare.com.au)  
Website: [www.lovencare.com.au](http://www.lovencare.com.au)

let's be friends!

 <http://www.facebook.com/lovencare1>

 [http://twitter.com/love\\_ncare](http://twitter.com/love_ncare)



100 % AUSTRALIAN OWNED SINCE 1984

**lovehncare**<sup>™</sup>  
[lovencare.com.au](http://lovencare.com.au)