

## Contact Us

### Head Office:

Love N Care Pty Ltd.  
297-299 Canterbury Rd, Revesby  
NSW 2212 Australia  
Contact No: 02 9774 4655  
Fax: 02 9774 4633  
Email: [info@lovencare.com.au](mailto:info@lovencare.com.au)  
Website: [www.lovencare.com.au](http://www.lovencare.com.au)

### Brisbane

7-9 Eileen Street  
Underwood QLD 4119 Australia  
Contact No: 07 3290 4217  
Fax: 07 3209 5019

let's be friends!

 <http://www.facebook.com/lovencare1>  
 [http://twitter.com/love\\_ncare](http://twitter.com/love_ncare)

 100 % AUSTRALIAN OWNED SINCE 1984



**love<sup>n</sup>care**  
[lovencare.com.au](http://lovencare.com.au)

BP 891

# VENUS

## HIGH CHAIR

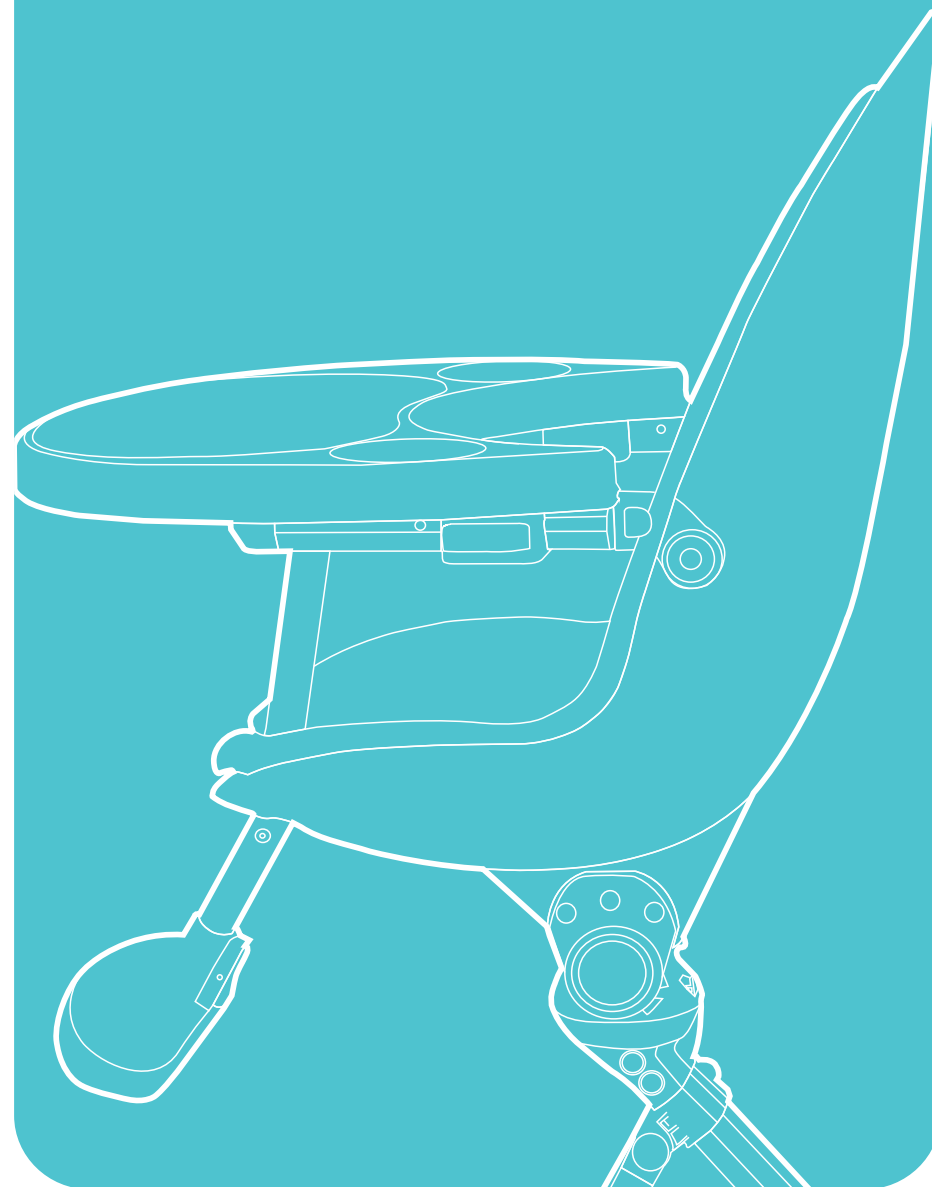

PLEASE KEEP INSTRUCTIONS FOR FUTURE REFERENCE

# VENUS

## HIGH CHAIR

Congratulations on purchasing your  
new Vulu Highchair

In under an hour you should be able  
to have this one of kind highchair ready  
to meet your beautiful child :)



## Warranty Against Defects

ALL VULU PRODUCTS ARE GUARANTEED FOR TWELVE MONTHS FROM THE DATE OF PURCHASE.

OUR GOODS COME WITH GUARANTEES THAT CANNOT BE EXCLUDED UNDER THE AUSTRALIAN CONSUMER LAW. YOU ARE ENTITLED TO A REPLACEMENT OR REFUND FOR A MAJOR FAILURE AND FOR COMPENSATION FOR ANY OTHER REASONABLY FORSEEABLE LOSS OR DAMAGE. YOU ARE ALSO ENTITLED TO HAVE THE GOODS REPAIRED OR REPLACED IF THE GOODS FAIL TO BE OF ACCEPTABLE QUALITY AND THE FAILURE DOES NOT AMOUNT TO A MAJOR FAILURE.

THIS COVERS AGAINST FAULTS WHICH DEVELOP THROUGH FAULTY MATERIALS AND WORKMANSHIP. MISUSE, ACCIDENTAL DAMAGES, NORMAL WEAR AND TEAR OR NEGLIGENCE ARE NOT COVERED.

IF A FAULT BECOMES APPARENT, PLEASE RETURN THE ITEM TO THE STORE OF PURCHASE WITH YOUR RECEIPT. YOU MUST INFORM THE STORE WHAT THE DEFECT IS. WE WILL THEN ARRANGE FOR ITS REPAIR OR IT WILL BE ASSESSED FOR REPLACEMENT AS EXPEDIENTLY AS POSSIBLE. THE BENEFITS OF THIS WARRANTY ARE IN ADDITION TO OTHER RIGHTS AND REMEDIES UNDER THE LAW IN RELATION TO THE GOODS AND SERVICES TO WHICH THIS WARRANTY RELATES.

IF YOU ARE UNABLE TO RETURN THE ITEM TO THE STORE OF PURCHASE, YOU CAN CONTACT LOVE N CARE ON FREECALL 1300732599. WE WILL THEN ORGANISE FOR EITHER SOMEBODY TO INSPECT THE ITEM OR ARRANGE FOR A COURIER TO PICK IT UP AND RETURN IT BACK TO YOU.



## WARNING!



Before assembling this highchair read and understand the instructions. Incorrect assembly may make the highchair unsafe. Do not use this highchair if any part is broken, torn or missing. Keep these instructions in a safe place for future reference.

### **WARNING! FALL HAZARD!**

- Follow the manufacturer's instructions.
- Never leave the child unattended.
- Hold the child securely at all times when putting the child into the chair or taking him or her out of it. Make sure that the food tray is in the locked position before you let go of the child.
- Always adjust the safety table snugly against the child to prevent the child from climbing out of the high chair.
- The child must not sit in the high chair when the safety tray is in the open position.
- The high chair is not a toy. Never let children play with the chair or use it by themselves.
- Never attempt to move the high chair while the child is still in the chair.
- The high chair should be placed on a level, horizontal floor. To avoid the risk of the high chair tipping over, make sure that the chair's feet can slide on the floor.
- Do not use the high chair unless all components are correctly fitted and adjusted.
- Be aware of the risk of open fire and other sources of strong heat, such as electric bar fires, gas fires etc., in the vicinity of the high chair.
- To avoid the risk of pinching, ensure that the child is wearing – at a minimum – a diaper or trousers when sitting in the high chair.
- Never push down on the safety table - doing so risks pinching the knees of larger children.
- Do not use the high chair until the child can sit up unaided.
- Do not use the high chair if any component is broken or missing. Contact Love N Care for repair advice.
- A child's safety is your responsibility
- The child should be secured in the baby chair at all times by the 5-point safety harness in the upright position.

- Keep the highchair away from open fire, heaters and other sources of strong heat.
- Always use the safety harness.
- Always be sure your child is clear of the highchair's moving parts before making adjustments.
- Check the highchair regularly for damage and to ensure that the harness is secure and performs correctly.
- Always check the tray is securely locked in place by attempting to pull it free of the highchair.
- **IMPORTANT:** Every time you place your child in the highchair or whenever you alter the position of the seat, always check that the harness is correctly fitted. Tighten the harness until it fits snugly around your child.
- Check that all safety locks are engaged before placing a child in the highchair
- This child is not recommended for a child under 6 months old.
- Do not allow children to stand on the seat or footrest or climb into or out of the highchair.
- The weight of the child using this highchair should not exceed 17kg and up to 36 months.  
To reduce the risk of injury, position the highchair away from furniture, walls, hot surfaces, liquids, window covering cords and electricals cords.

## CARE AND MAINTENANCE



**WARNINGS:** Using an effective disinfectant, for examples cleaners with alcohol or chlorine content, may cause bleaching and discoloration, it is recommended to use cleaners specifically designed for colored fabrics to spot clean the Love N Care seat pad. The Highchair can be cleaned with a sponge using lukewarm water and a light detergent. Strong stains can be removed using non-abrasive cleaning cream. Moving parts can be lubricated with some light silicon oil.

## COMPONENTS NAME

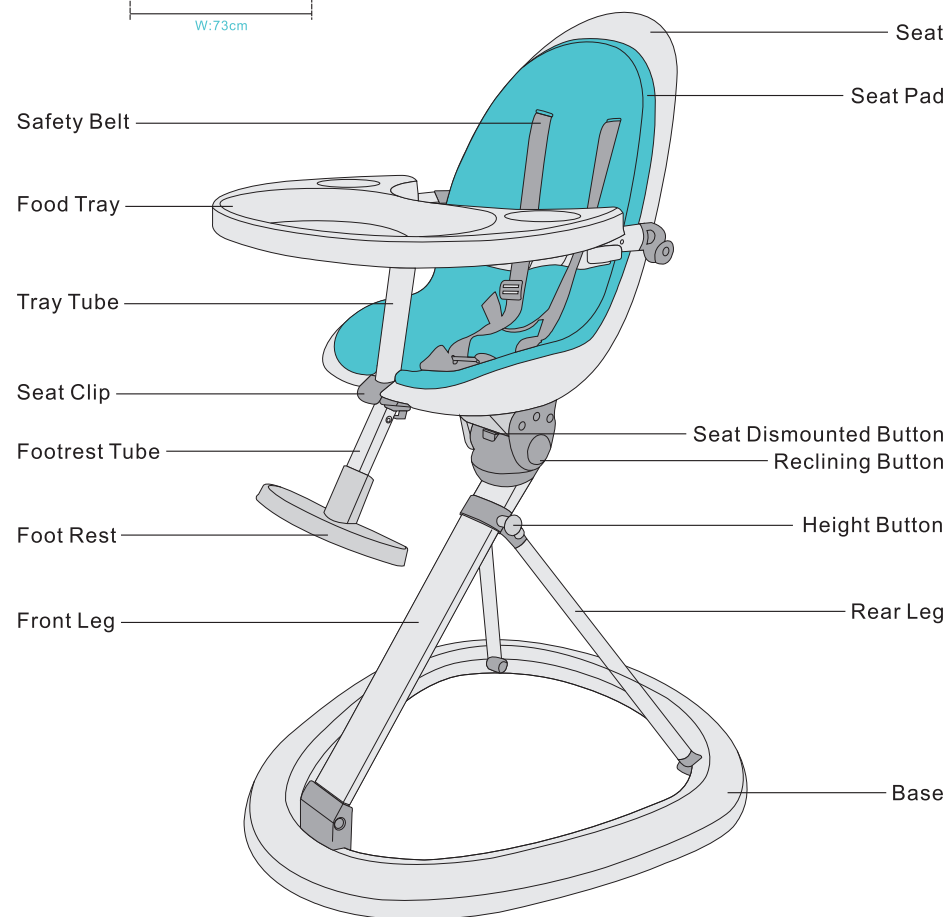
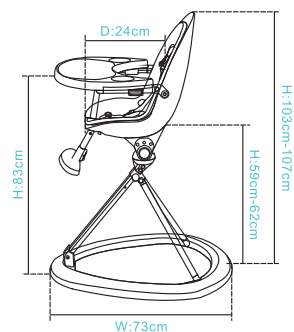

## COMPONENTS NAME

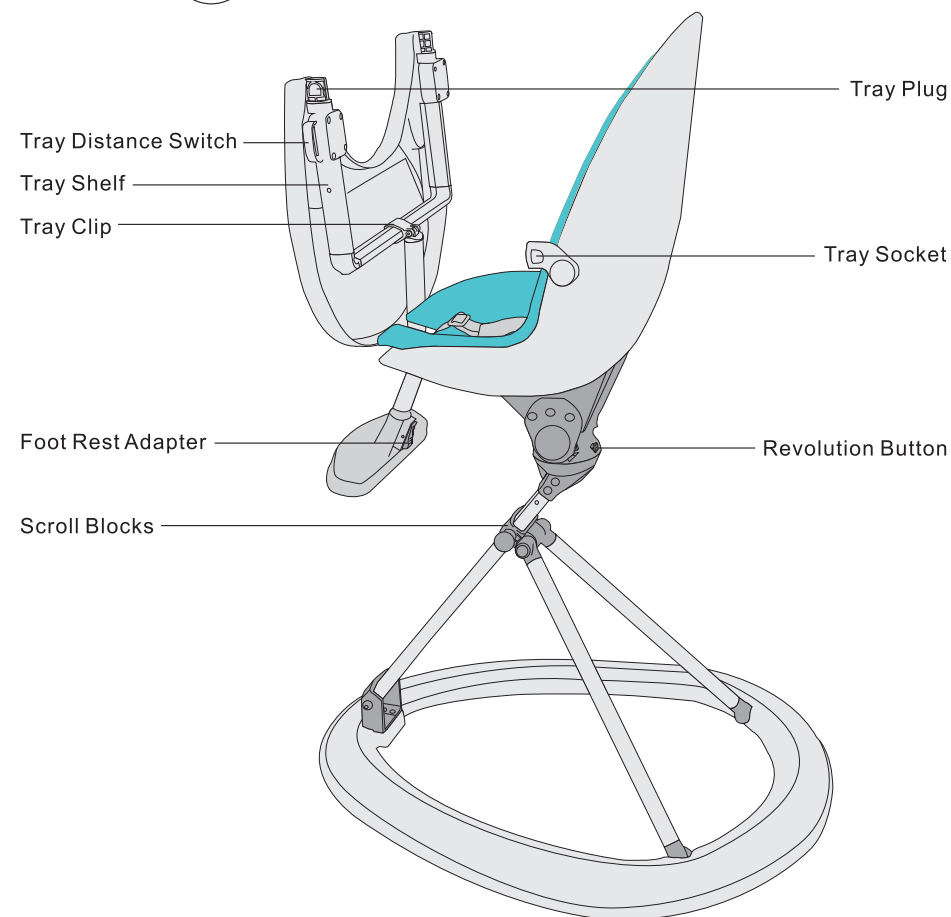
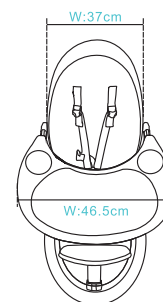

## Part I . High Chair Installation

### Step 1: Base Assembly

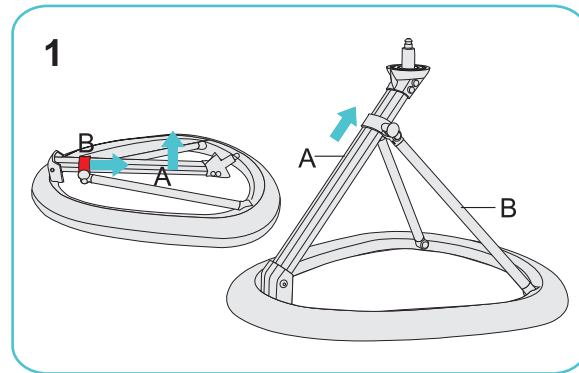

1. Raise up tube A. Then slide tube B along tube A until it "clicks" into place.

### Step 2: Seat Installation

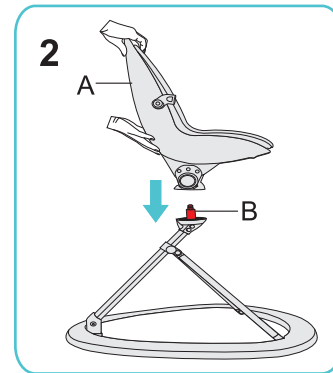

2. Insert the seat unit (A) onto the axel of the assembled base until the 2 round plastic balls close completely. Lift it slightly to make sure it is locked into position.

### Step 3: Food Tray Installation

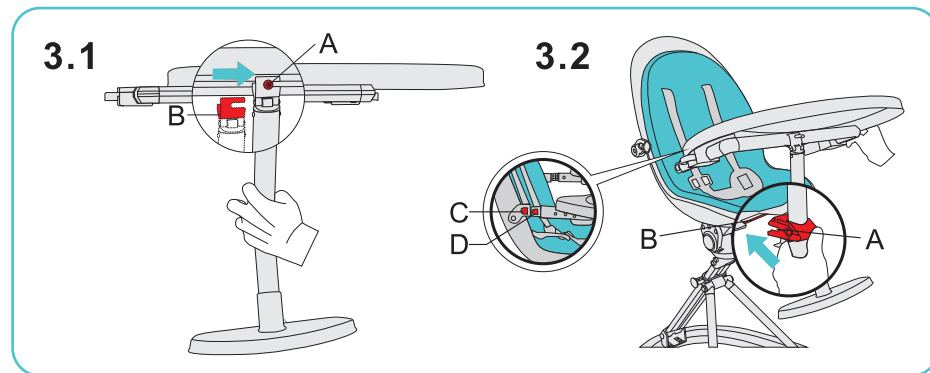

3.1 Place point B of the footrest into the bottom tube. Slide it until it clips onto point A with the iron prop.

3.2 Insert Section A onto the screw on Part B. Press A onto B until they lock in together. Try to pull them slightly to make sure they are locked in properly. Insert the plug D from the tray into the socket C from the seat until the button springs into place. Repeat this action for both sides.

## Part II . High Chair Function

### Function 1: Safety Belt Usage

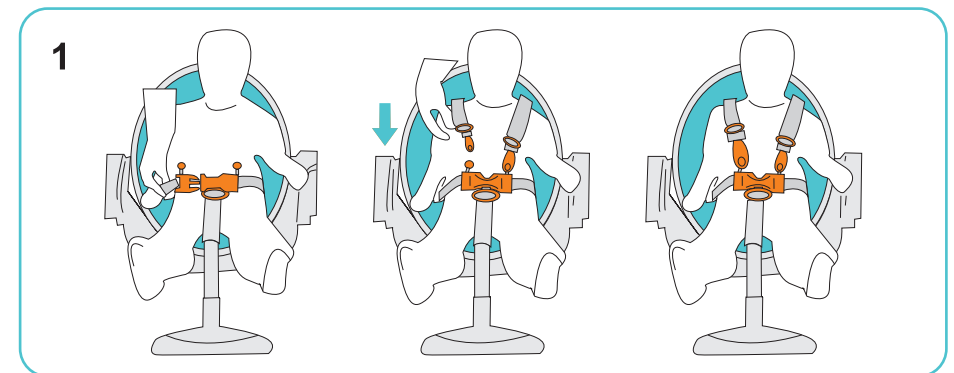

1. Place the child into the seat. Place the crotch strap between their legs. Place the waist strap around the child's waist. Place the shoulder straps over the child's shoulders. Attach the shoulder straps to the waist strap holders. Then insert the connected shoulder and waist strap into the crotch strap buckle. Repeat for both sides. Carefully adjust the sliders located on the shoulder, waist and crotch strap. The harness should be snugly fitted to the baby's body tight enough so that the baby cannot wriggle itself free of the straps but loose enough so it does not cause it discomfort.

To open the harness press the centre button on the crotch strap to release the shoulder, waist and crotch strap simultaneously.

### Function 2: Height Adjustment

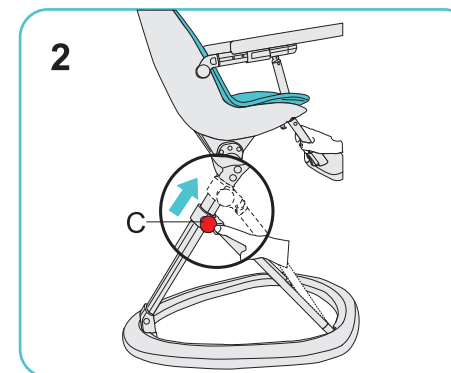

2. To adjust the height pull out the button located as point C and slide the rear leg up and down until you reach your desired position. It should click into place. There are 2 levels only.

### Function 3: Footrest Adjustment

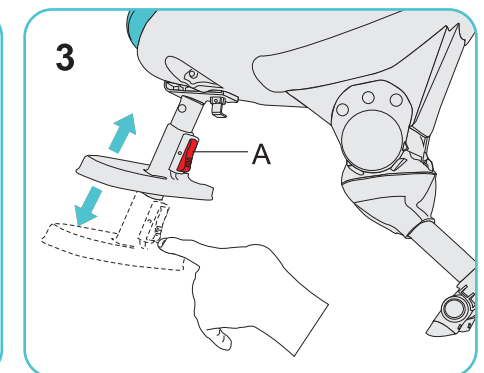

3. Press the button A on the back of the footrest to the desired location. There are only 2 adjustable levels only.

#### Function 4: Seat Revolve

4

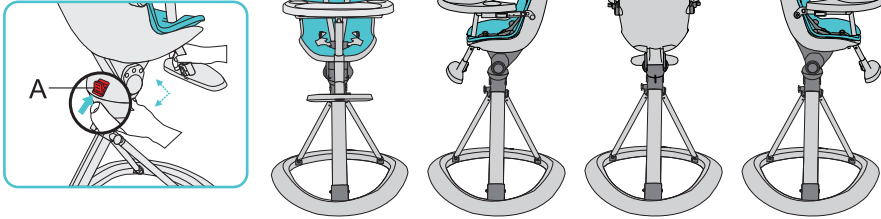

4. The highchair can be adjusted to 4 different positions. To adjust the position of the chair press the button located at point A then rotate the chair until the desired position is reached.

#### Function 5: Seat Reclining

5

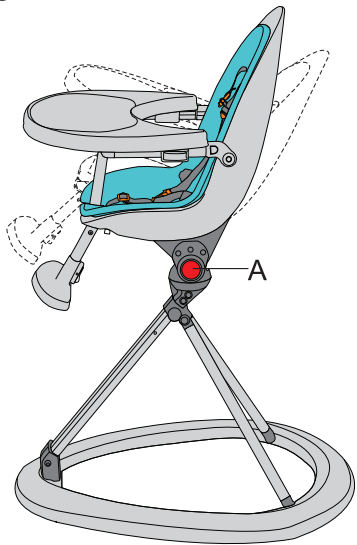

5. To recline the seat hold down button A simultaneously and adjust the seat to the desired position.

#### Function 6: FoodTray

6

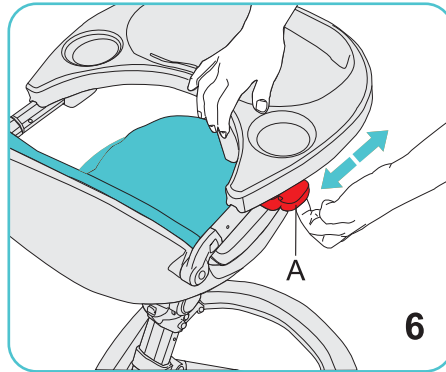

6. To adjust the food tray press the release button under each sides of the tray located at point A. Adjust the food tray to the desired location. It should click into place.

## Part III. Disassembly

### Step 1: Seat Disassembly

1

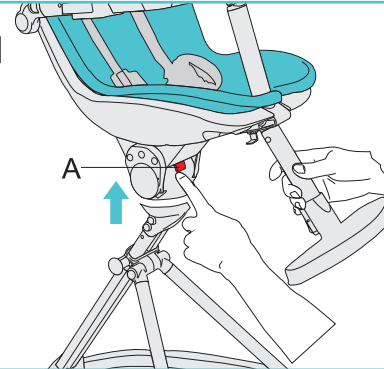

1. Press the button under the chair located at point A, then lift the seat upwards.

### Step 2: Fold The Bottom Case

2

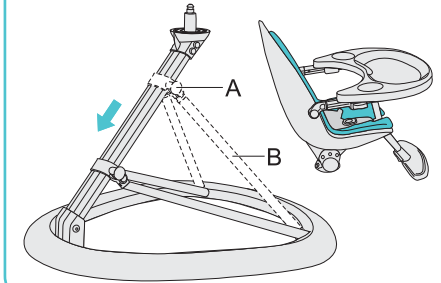

2. Pull out the button at point A and slide tube B downwards until it lays flat.

### Step 3: Food Tray Disassemble

3.1

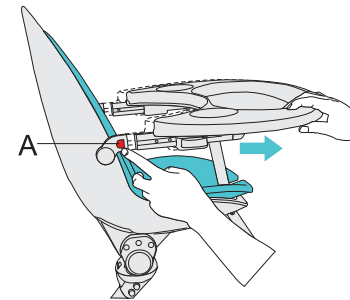

3.1 Press the release button located at Point A on each side of the chair to release the tray from the holders.

3.2

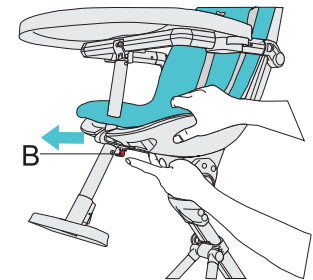

3.2 Pull down the latch at point B then simultaneously push the footrest forward to remove from the holder.