

Instruction Manual

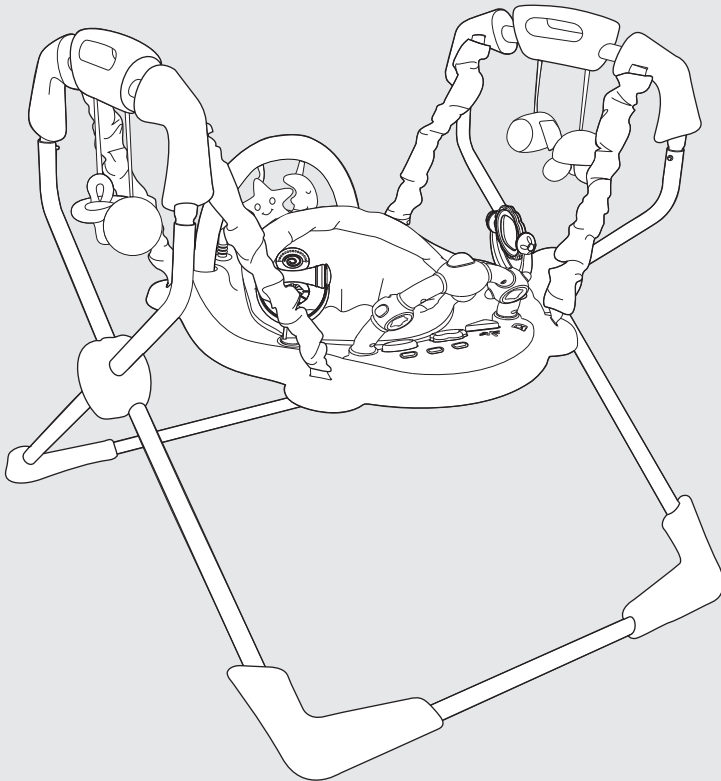

love^hcare™

"X-Factor" Stationary Centre



IMPORTANT: PLEASE READ INSTRUCTIONS
CAREFULLY AND KEEP FOR FUTURE REFERENCE!

ITEM: BP 9001

WARNING

To prevent serious injury or death

- Use only for a child who is able to hold head upright unassisted and who is not able to walk or climb out of product.
- Never leave child unattended. Always keep child in view while in product.
- Never use near steps, pools, hot surfaces or areas that may be hazardous to a child. Product may move during use.
- To avoid tip over, place product on a flat, level surface.
- Strings can cause strangulation! DO NOT place items with a string around child's neck, such as hood strings or pacifier cords. DO NOT suspend over product or attach strings to toys.

IMPORTANT! PLEASE KEEP THESE INSTRUCTIONS FOR FUTURE REFERENCE

- Please read these instructions before assembly and use of this product.
- **Adult assembly is required. Tool needed for battery installation:**
Phillips screwdriver(not included).
- Requires two "AA" (LR6) alkaline batteries (not included) for toy operation.
- use only for a child:
 - who is able to hold head up unassisted.
 - who is not able to climb out.
 - who weighs less than 25 lbs.(11.3kg) and is less than 32 inches (81cm) in height.
- This baby walking frame should be used only for short periods of time (e.g.20 mins.).
- Do not use replacement parts other than those approved by the manufacturer or distributor.
- **WARNING:** Do not use this jumping walker as a swing.
- The child will be dangerous of play nearby jumping walker.
- Keep child in the middle of seat correctly.

Cleaning:

- Clean with a damp sponge or cloth and mild detergent. Do not use abrasives or bleach.

PARTS

Base x2

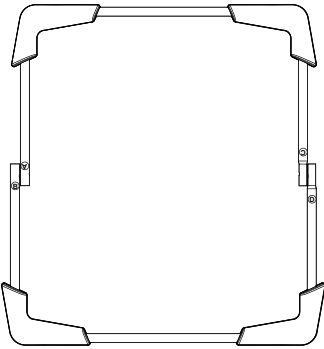

Bouncer x1

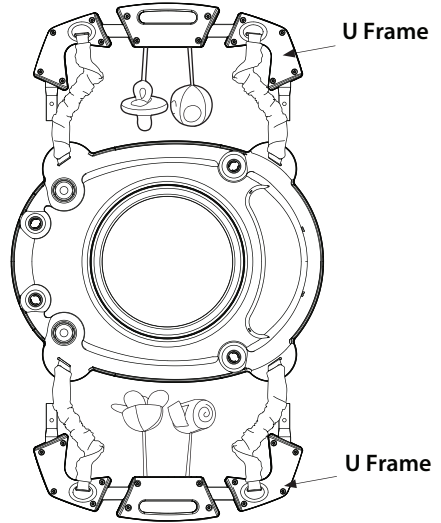

Seat Pad x1

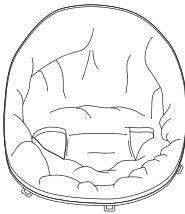

Seat Ring x1

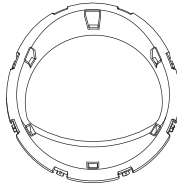

Spinner Toys x2

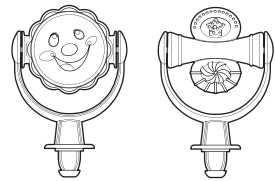

Spinner Ball Toy x1

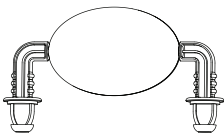

Plush Arch Toy x1

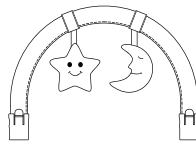

Arch Toy x1

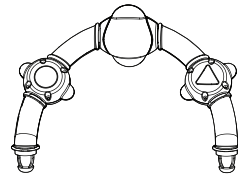

X Frame x2

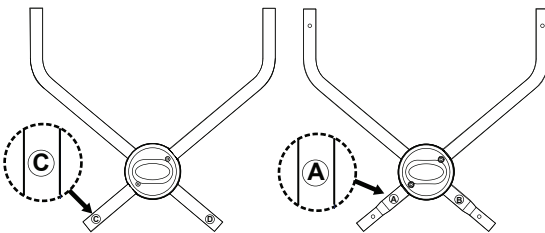

Music Tray x1

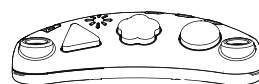

TOOL NEEDED: Phillips Screwdriver

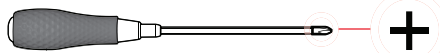

STEP 1

1. Put the X Frames and the base together as shown in the diagram.
2. Push the button in the end of the poles inward (a), then slot the poles fully into base (b).
3. Ensure that the buttons are protruding through.

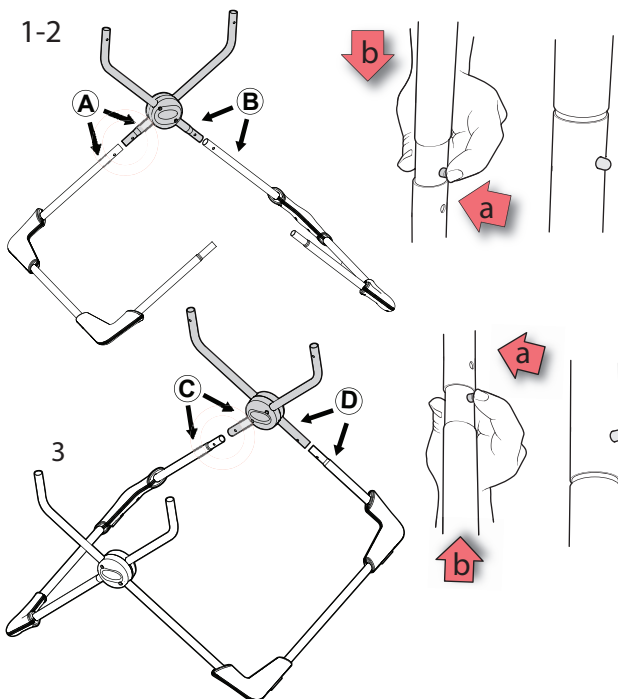

STEP 2

- Slot U Frame on the bouncer onto the ends of the X Frame until it rests on the buttons. Push the button inwards (a), then slot the poles fully into the base (b). Ensure that the button are protruding through.

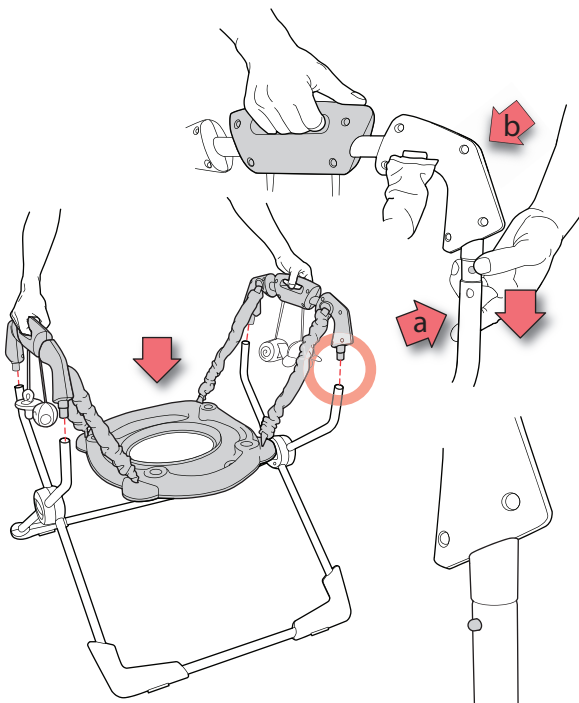

STEP 3

1. Slot the Spinner ball toy, into the round holes on the bouncer, see diagram.
2. Push into the holes until the studs on the ends of toy lock over the housing on the underside of the bouncer and cannot be pulled off.

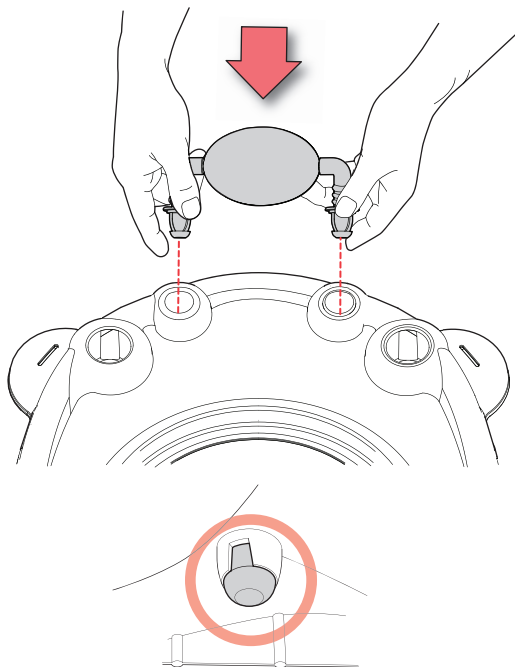

STEP 4

Slot the two spinner toys into the round holes in the end of the bouncer, see diagram. Push the spinner toys into the holes until the studs on the ends of the spinner toys lock over the housings on the underside of the bouncer and cannot be pulled off.

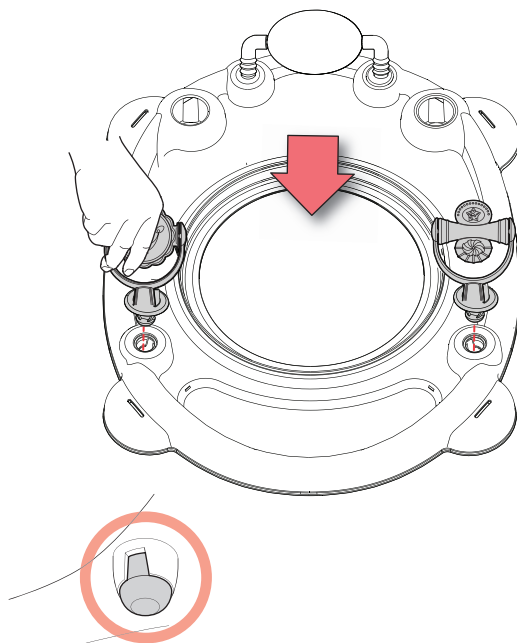

Slot the plush arch toy into the round holes on the main tray, see diagram.
Make sure both lock hooks snap into the lock hook holes.

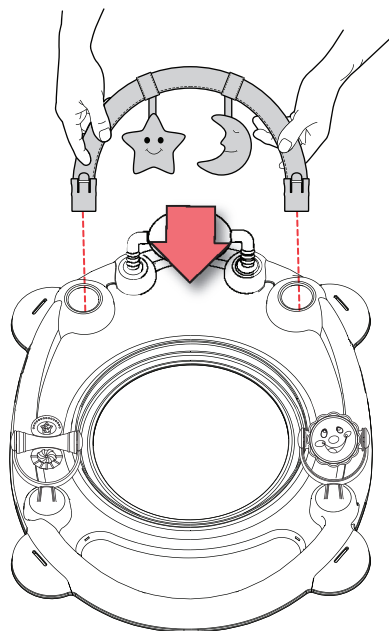

Before fitting the music insert you will need to fit the batteries.
Unfasten the screw in the battery cover using a X-head screwdriver.
Insert two 'AA' batteries, ensure that the batteries are fitted the correct way round.
Refit the battery cover and tighten the screw.

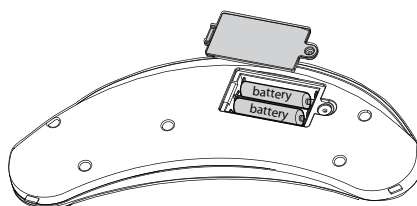
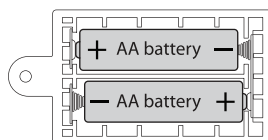
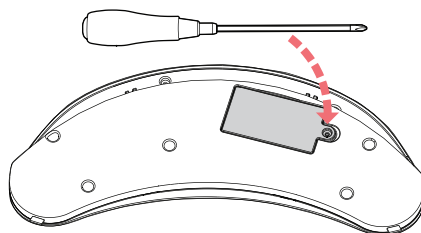

To assemble music tray
slot the arch toy into the
music tray as shown.

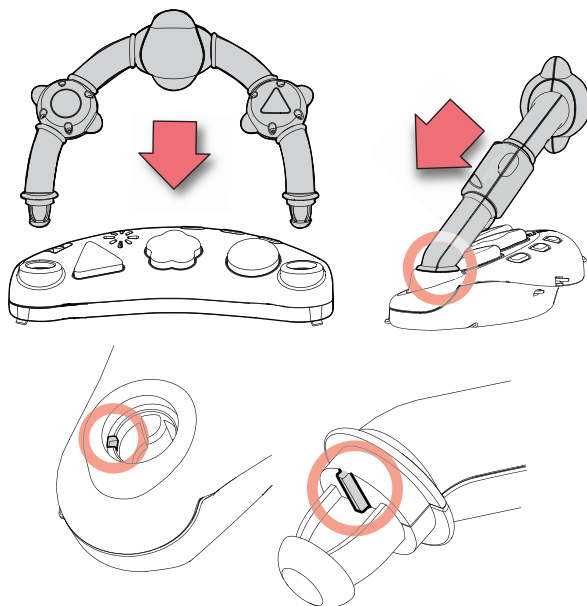

1. Slot the music tray on the bouncer, see diagram. Ensure both front locks hook into the openings.
2. Push down on the back of music tray. Ensure that both back locks are securely in place.

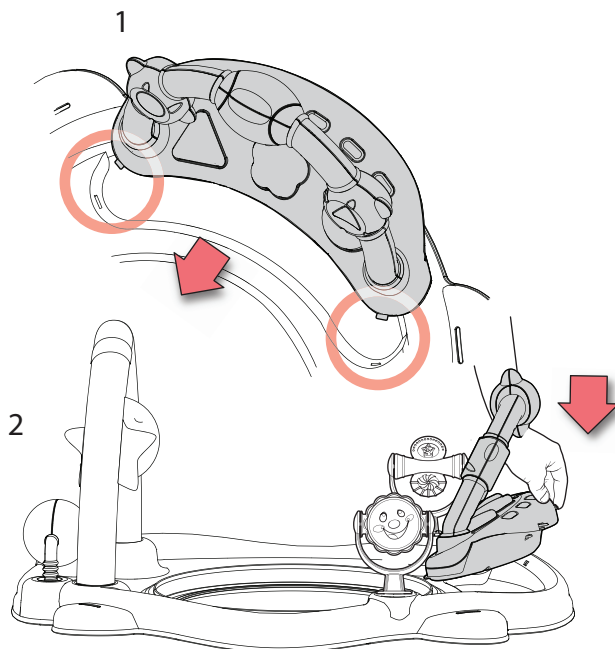

Slide the switch on the back of the music insert along for either off, quiet music or loud music.

Press the flashing shapes on the front of the music insert for eight different tunes.

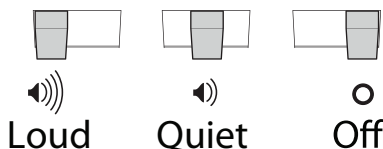
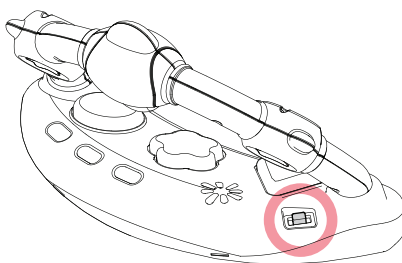

Battery safety information

- **Hint:** We recommend using alkaline batteries for longer battery life.
- Protect the environment by not disposing of this product with household waste check your local authority for recycling advice and facilities.
- Fluids that can cause a chemical burn injury or ruin your product. To avoid battery leakage: In exceptional circumstances may leak.
- Do not mix old and new batteries or batteries of different types:alkaline, standard (carbon-zinc) or rechargeable (nickel-cadmium).
- Insert batteries as indicated inside the battery compartment.
- Remove batteries during long periods of non-use.Always remove exhausted batteries from the product. Dispose of batteries safely.Do not dispose of product in a fire. The batteries inside may explode ot leak.
- Never short-circuit the battery terminals.
- Use only batteries of the same or equivalent type as recommended.
- Do not charge non-rechargeable batteries.
- Remove rechargeable batteries from the product before charging.
- If removeable, rechargeable batteries are used, they are only to be charged under adult supervision.

1. Pull the crotch section of the seat pad outwards, the warning label will be at the back and the adjustment strap for the seat pad will be at the bottom.
 2. Slot the seat pad onto the seat ring so that the ● and ★ on the warning label are aligned with the ● and ★ on the back of the seat ring.
 3. Hook the plastic tabs with the holes in on the seat pad over the tabs on the seat ring.
 4. The seat pad is now attached to the seat ring.
- IMPORTANT:** Check that the seat pad is correctly fitted to the seat ring.

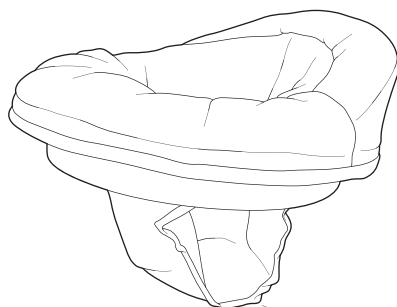
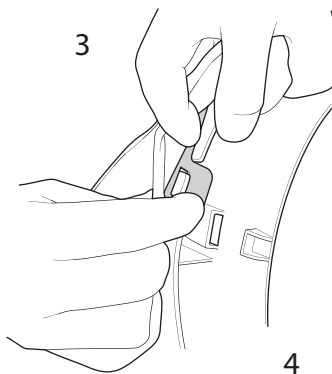
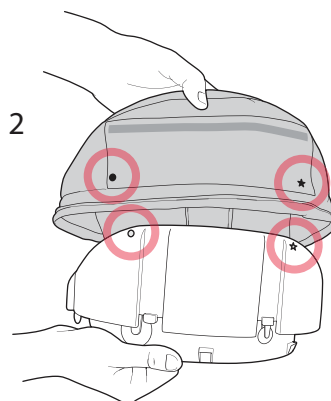
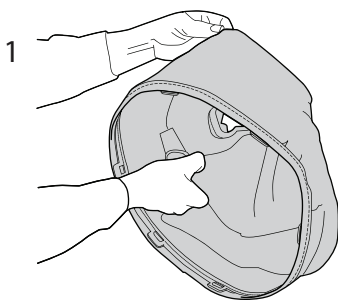

1. Slot the assembled seat into the hole in the middle of the bouncer.

2. While holding the sides of the bouncer, push down on the seat ring until the clips on the seat ring lock over the edge of the bouncer.

3. Turn the bouncer over and check that all of the six clips have locked over the edge of the bouncer. Also pull up on the seat to ensure that it will not come off.

Once fitted the seat will rotate freely.

1

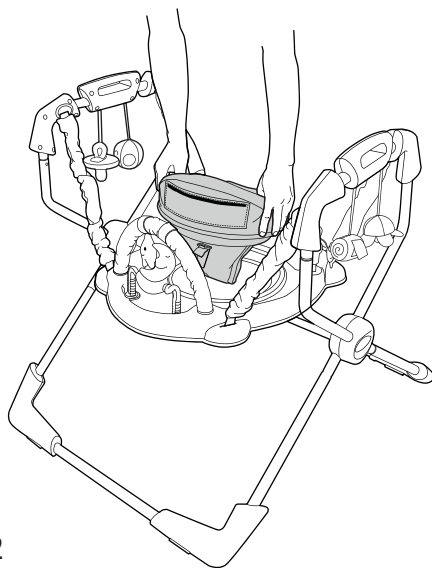

2

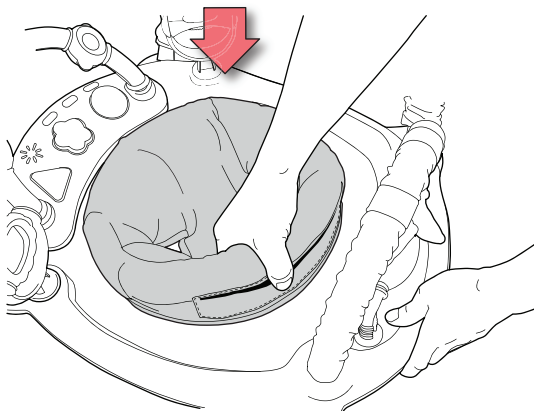

3

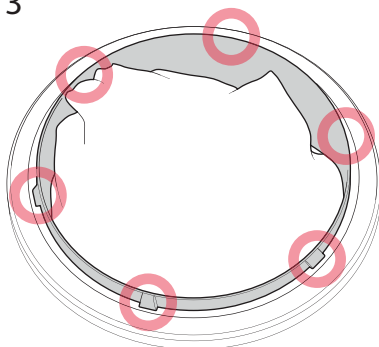

Assessing the correct seat height:

Place the child in the seat of the bouncer. The child's toes only must touch the floor without bouncing.

Always adjust the seat if the child's feet are fully on the floor, or the child's toes do not touch the floor.

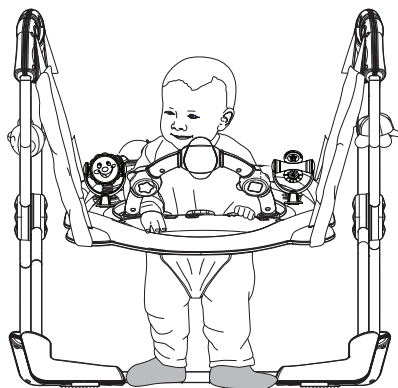
**WARNING:**

Never attempt to adjust the seat with the child in it.

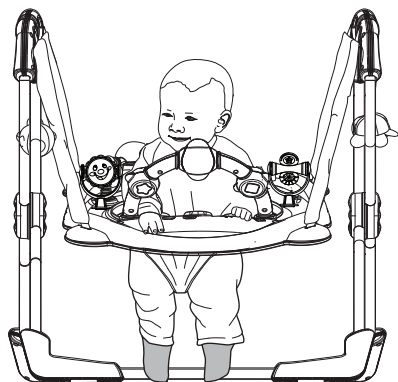

To raise the height of the seat:

Grip the buckle on the rear of the seat pad. Pull the loose end of the webbing away from the buckle until the correct height is achieved. You may need to place the child in the seat several times before the correct height is achieved.

To lower the height of the seat:

Push the button on the top of the buckle inwards (A) and hold. Feed the webbing through the buckle (B) until the seat is the correct height. You may need to place the child in the seat several times before the correct height is achieved.

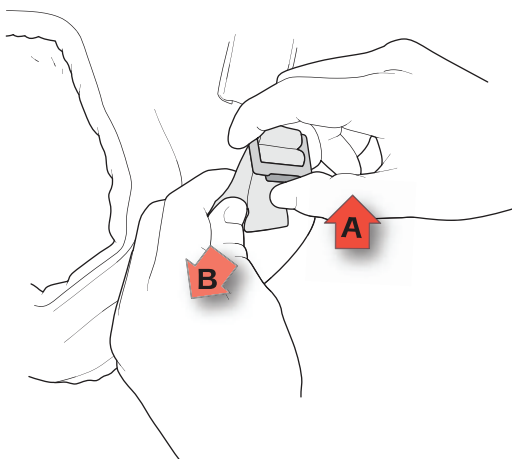
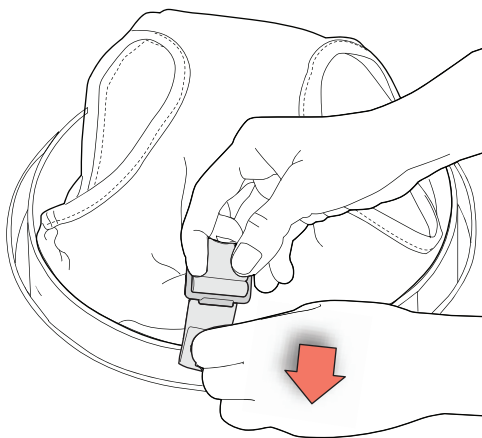

Care & maintenance

1. Wipe plastic parts with a damp cloth using mild soap.
2. Machine wash seat pad in cold water in gentle cycle. Do not use harsh detergents or bleach. Do not dry clean.
3. Air or line dry.
4. To maintain stopping performance, clean friction strips regularly with damp cloth.



Contact Us:

Love N Care Pty Ltd.

297-299 Canterbury Rd, Revesby

NSW 2212 Australia

Contact No: 02 9774 4655

Fax: 02 9774 4633

Email: info@lovencare.com.au

Website: www.lovencare.com.au