

AU-WIEG

Crib Instructions

IMPORTANT. RETAIN FOR FUTURE REFERENCE.
READ CAREFULLY

20min. ►

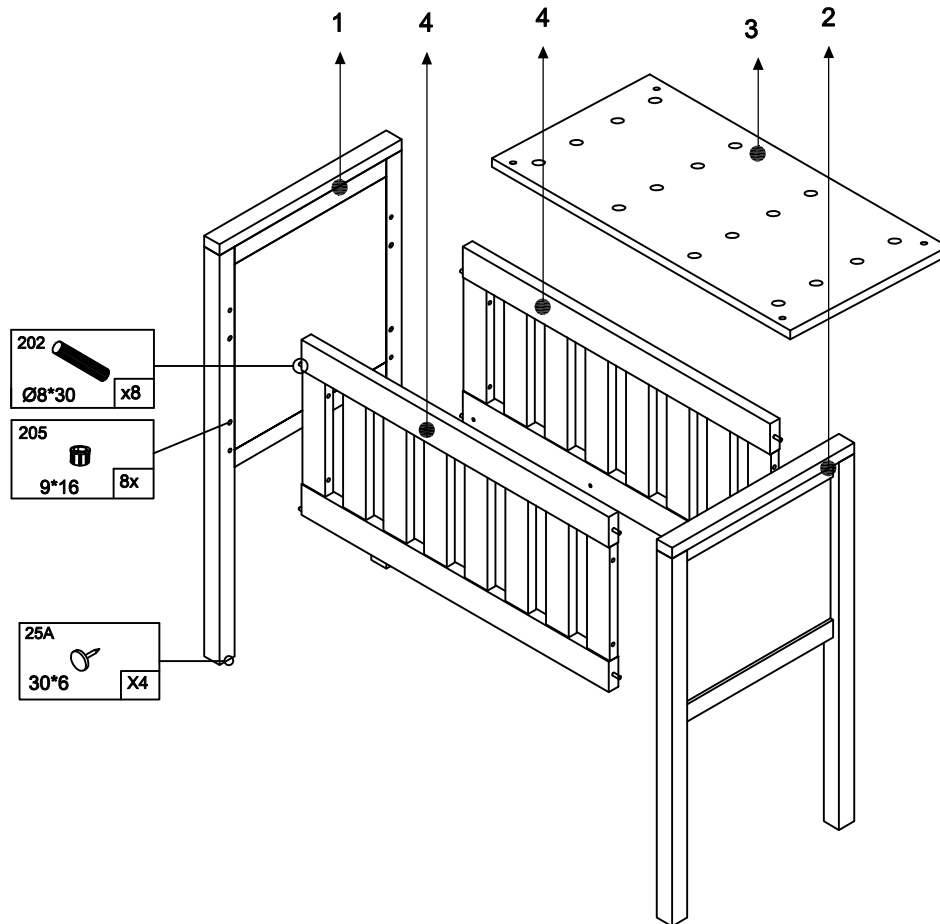

AU-WIE5165: 1,2
AU-WIE5265: 3,4,5

CH A600:AUS

lovenhcare
www.lovenhcare.com.au

5

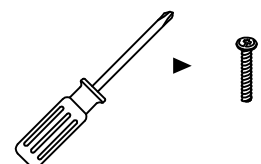
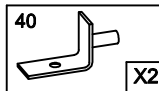
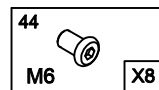
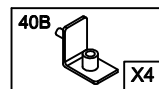
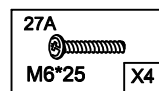
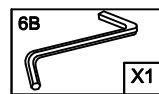

IMPORTANT / RETAIN FOR FUTURE REFERENCE / READ CAREFULLY

- **WARNING** - Do not use this product without reading the instructions for use first.
- **WARNING** - Stop using the product as soon as the child can sit or kneel or pull itself up.
- **WARNING** - Placing additional items in the product may cause suffocation.
- **WARNING** - Do not place the product close to another product, which could present a danger of suffocation or strangulation, e.g. strings, blind/curtain cords, etc.
- **WARNING** - Do not use more than one mattress in the product.
- The product should be placed on a horizontal floor.
- Young children should not be allowed to play unsupervised in the vicinity of the product.
- The product should be locked at the fixed position when the child is left unattended.
- Recommended dimensions for the mattress: L x W x H = 80 cm x 40 cm x 6 cm. The thickness of mattress must not exceed 130mm. Please keep this in mind when you buy the mattress, the thickness should be matched to these dimensions. Please put the mattress in the product without inclination when using.
- All assembly fittings should always be tightened properly and that care should be taken that no screws are loose, because a child could trap parts of the body or clothing (e.g. strings, necklaces, ribbons for babies' dummies, etc.) which would pose a risk of strangulation.
- Be aware of the risk of burning cigarettes, open fires and other sources of strong heat, such as electric bar fire, gas fires, etc. in the near vicinity of the product.
- Care instructions: To clean the product, please use a damp cloth and mild detergent.
- Do not use the product if any part is broken, damaged. Contact Love N Care for replacement parts and instructional literature if needed. **DO NOT** substitute parts.

43A	44	6B
M6*73	M6	
X8	X8	X1

1
2
4(x2)

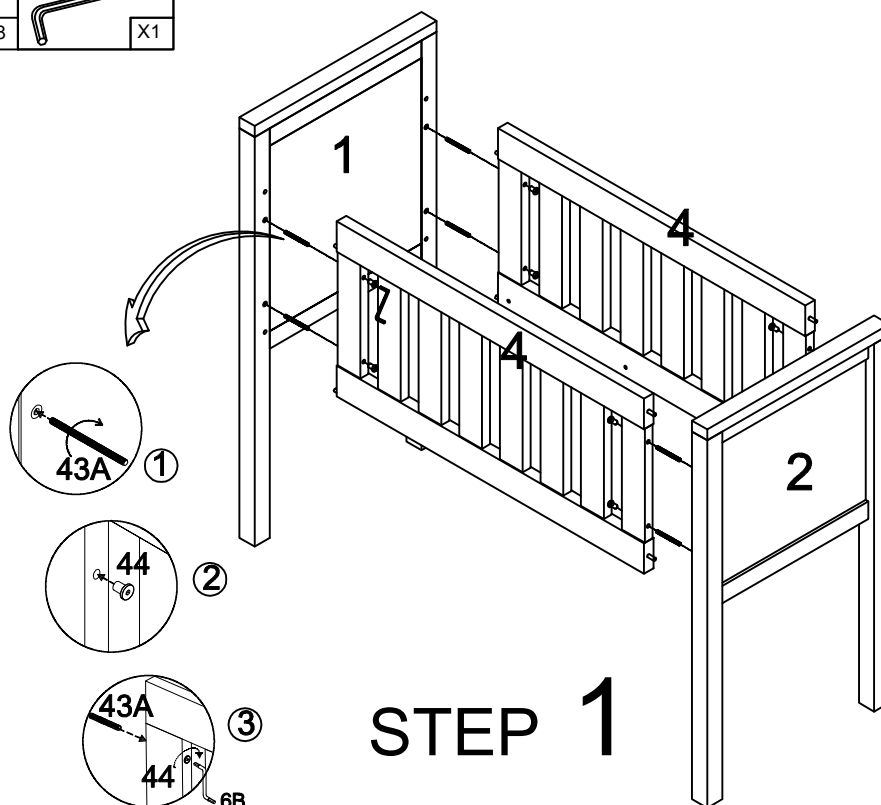

STEP 1

27A	40B	40
M6*25		
X4	X4	X2

3

STEP 2

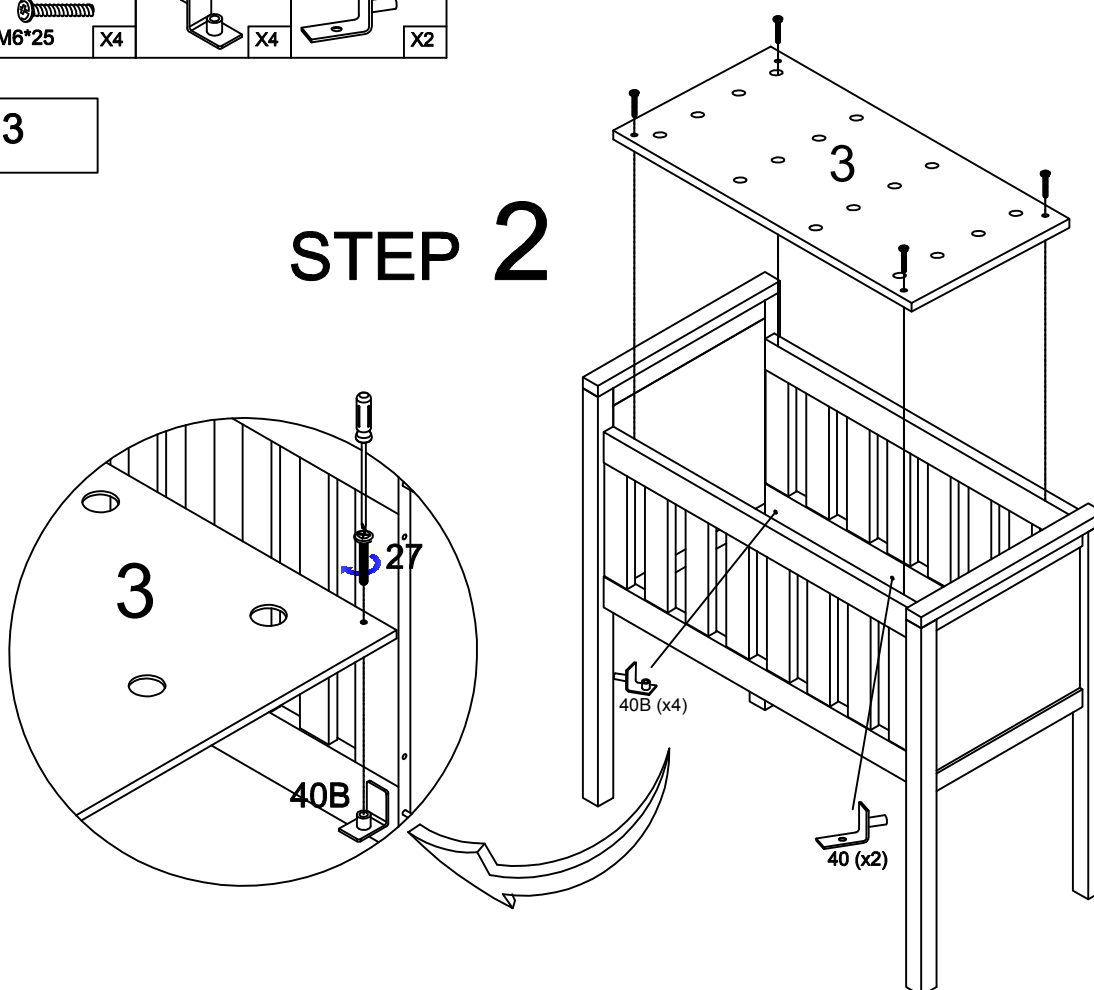

LOVE N CARE WARRANTY AGAINST DEFECTS

All Love N Care products are guaranteed for twelve months from the date of purchase. Our goods come with guarantees that cannot be excluded under the Australian Consumer Law. You are entitled to a replacement or refund for a major failure and for compensation for any other reasonably foreseeable loss or damage. you are also entitled to have the goods repaired or replaced if the goods fail to be of acceptable quality and the failure does not amount to a major failure. This covers against faults which develop through faulty materials and workmanship.

Misuse, accidental damages, normal wear and tear or neglect are not covered.

If a fault becomes apparent, please return the item to the store of purchase with your receipt.

You must inform the store what the defect is. We will then arrange for its repair or it will be assessed for replacement as expediently as possible. The benefits of this warranty are in addition to other right and remedies under the law in relation to the goods or services to which this warranty relates. If you are unable to return the item to the store of purchase, you can contact Love N Care on free call 1300 732 599.

Where you send the product directly to the manufacturer then you may be liable for the costs of transportation to and from Love N Care. Love N Care will meet the reasonable expenses incurred by a consumer in a making a warranty claim. You can claim expenses incurred in making a claim by contacting our customer service team on 1300 732 599 or by email at info@lovencare.com.au

love^hcare™
www.lovencare.com.au